

C-JOIST SPAN TABLES AND DETAILS



MONTREAL • TORONTO • CALGARY • EDMONTON • VANCOUVER

BAILEY[®]
METAL PRODUCTS LIMITED



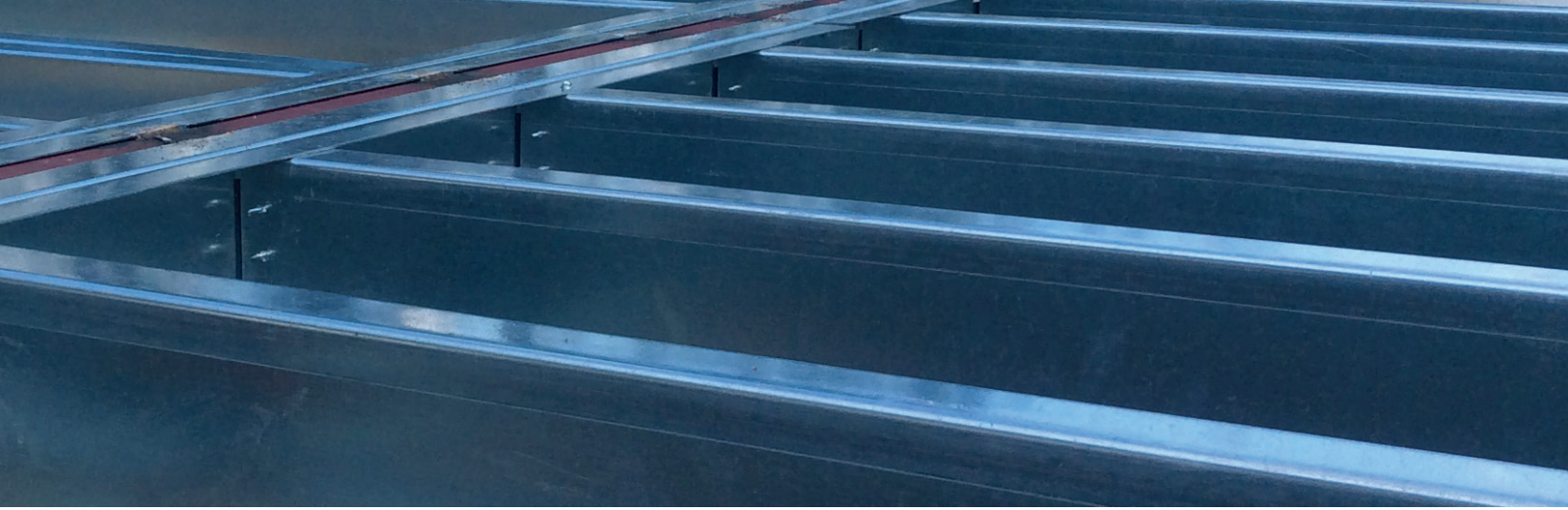

C-JOIST FLOOR SYSTEM

The Bailey C-Joist Floor System provides an economical lightweight alternative to open web steel joists, engineered wood "eye" joists, cast-in-place or hollow core floor systems. C-Joists come in a variety of depths, flange sizes and steel thicknesses. Depending on loads and spans, C-Joists are typically spaced at 12", 16" or 24" o.c. and will provide economic benefits for spans 10 to 30 feet.

- Precut to exacting sizes and readily available.
- Available in 43 mils (18ga), 54 mils (16ga), 68 mils (14ga), and 97 mils (12ga) and 118 mils (10 ga).
- Flange widths include: 1-5/8", 2", 2-1/2", 3" and 3-1/2".
- Bailey C-Joist Floor Components include, Joists, Rim Joist (Track), Bridging and Web Stiffeners.

The span tables contained in this catalogue were prepared by Dr. Reinhold M. Schuster, P.Eng., Distinguished Professor Emeritus, Department of Civil and Environmental Engineering University of Waterloo.

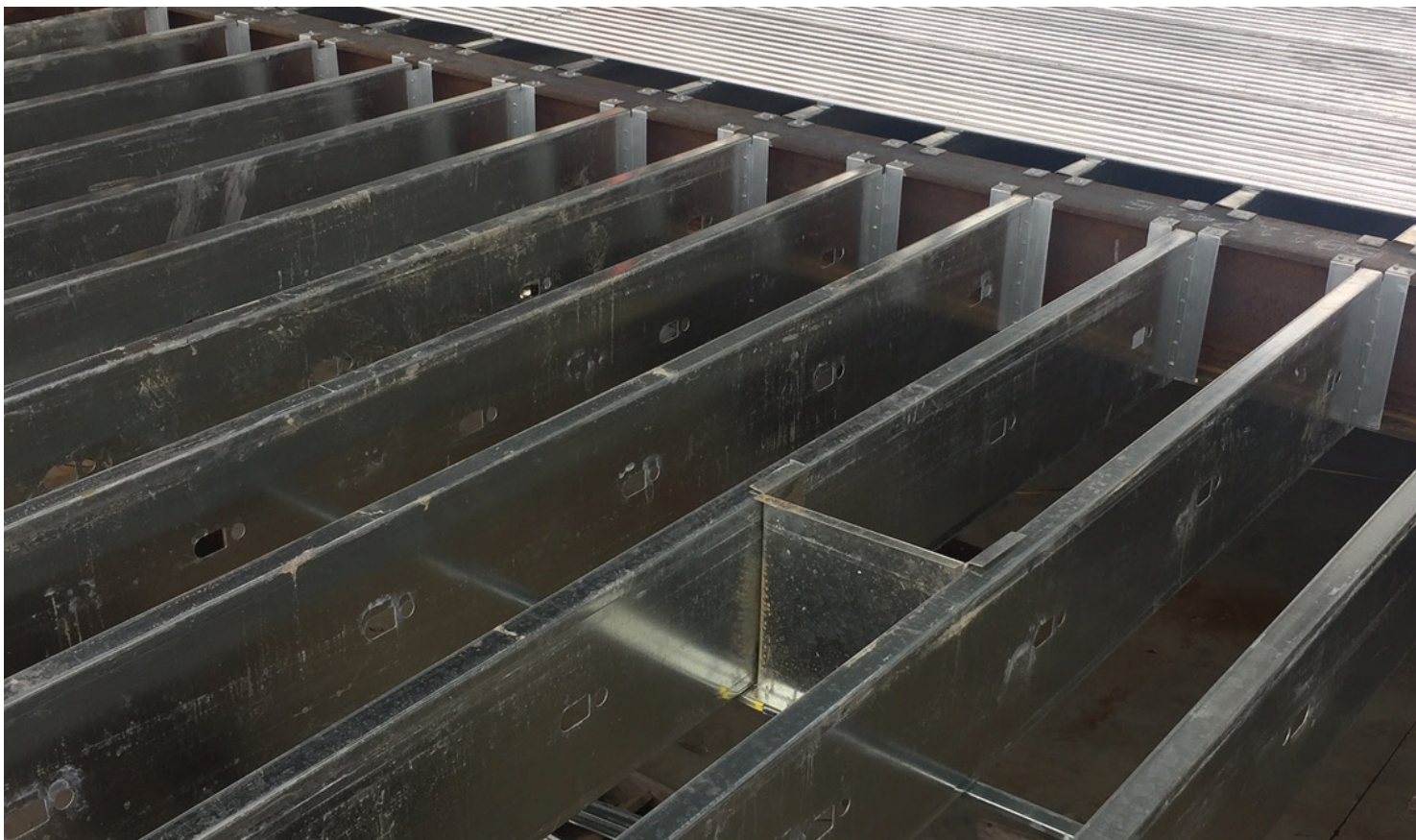



FLOOR JOISTS

Bailey Lightweight Steel Framing (LSF) Joists offer a wide range of span and load capabilities for commercial and residential floor systems and mezzanines. The use of Bailey LSF Joist Rafter members will provide support for interior drywall ceilings where long clear spans are required.

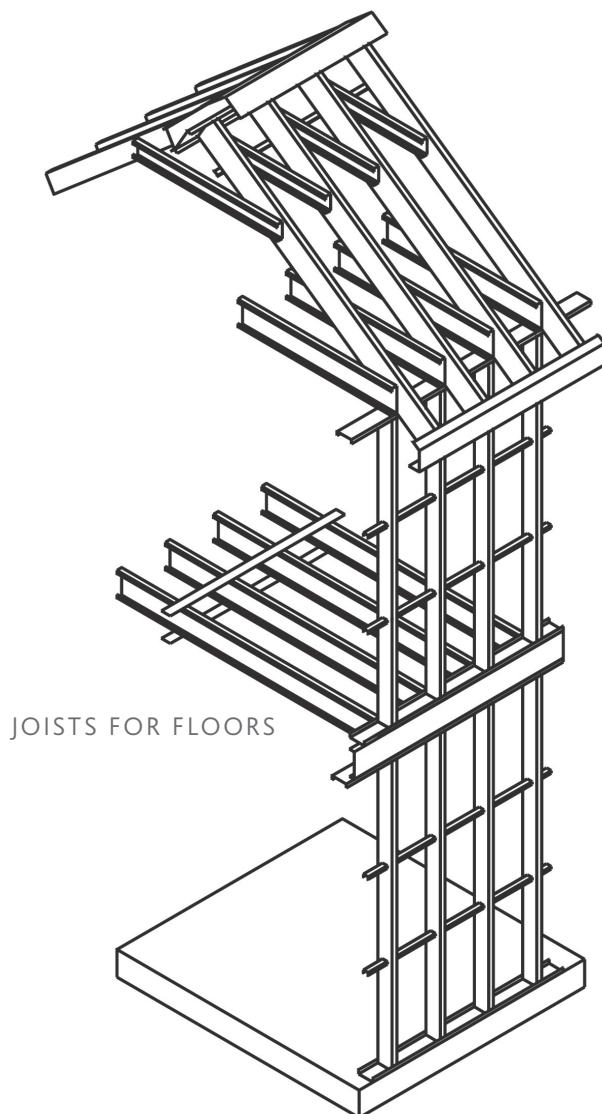

FLOOR JOIST WITH BRIDGING AND BLOCKING

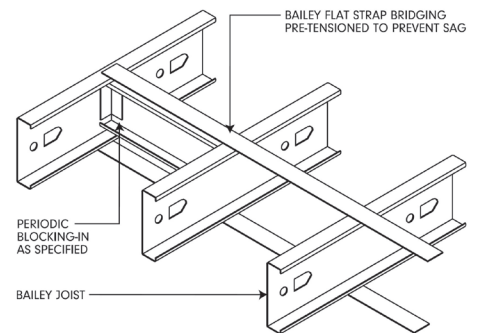

JOISTS CONTINUOUS OVER SUPPORTING BEAM

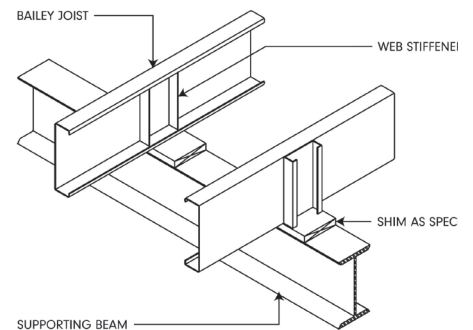

JOIST PARALLEL TO PERIMETER

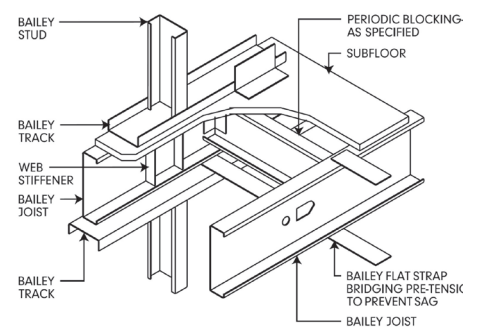



BAILEY

METAL PRODUCTS LIMITED



FLOOR MOUNTED INSIDE CONCRETE WALL

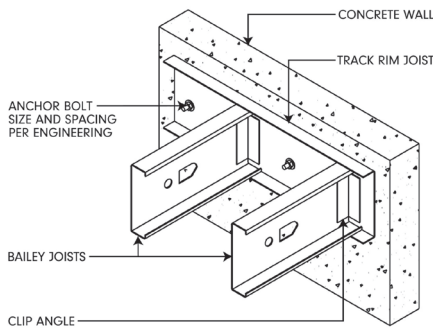

OPENING IN FLOOR

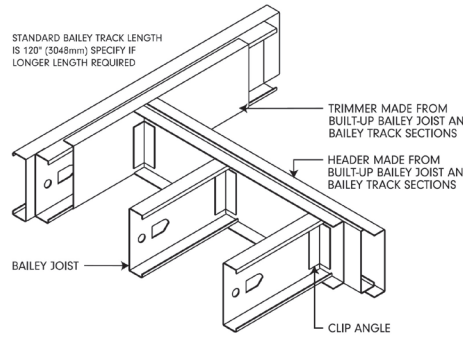

FLUSH CONNECTION TO SUPPORTING BEAM

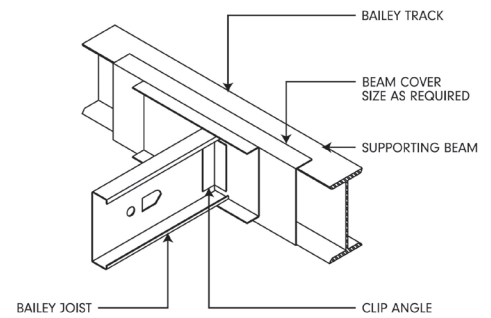

JOISTS OVERLAPPING SUPPORTING BEAM

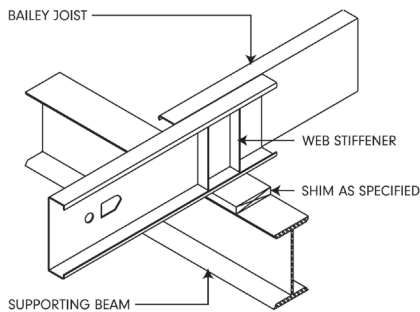

JOIST PERPENDICULAR TO PERIMETER

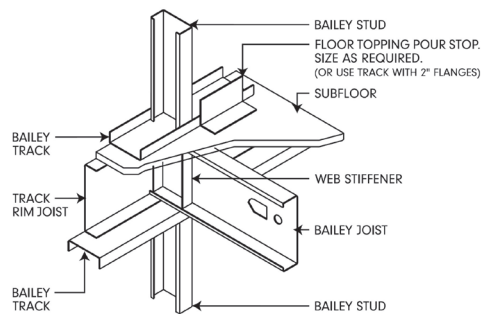

JOIST ABOVE LOADBEARING WALL

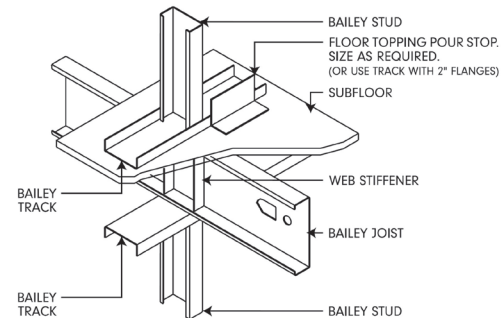

JOIST PERPENDICULAR TO PERIMETER

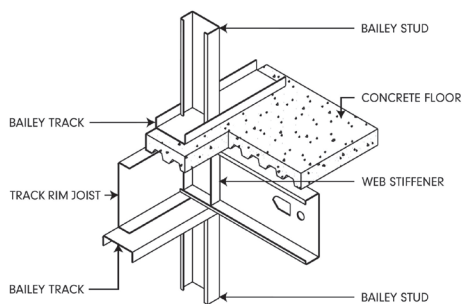

JOIST ABOVE LOADBEARING WALL

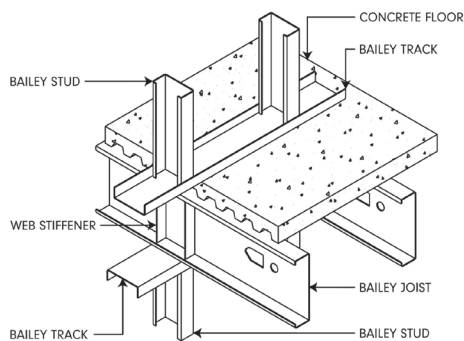

JOIST PARALLEL TO PERIMETER

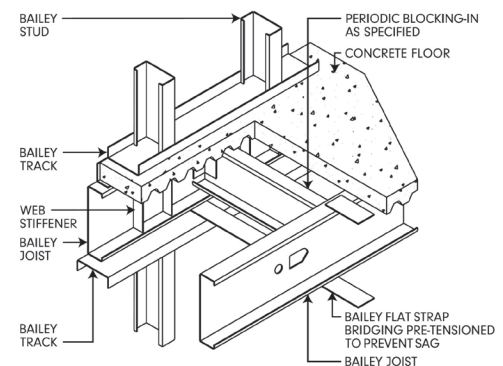

BAILEY JOIST SECTION PROPERTIES

Joist Designation	Lip (in.)	Base Design Thickness (in.)	F _y (ksi)	GROSS							PERFORATED EFFECTIVE					TORSIONAL						
				Weight (lb/ft)	Area (in ²)	I _x (in ⁴)	r _x (in.)	I _y (in ⁴)	r _y (in.)	V _{rg} (kip)	I _{xd} (in ⁴)	S _{xe} (in ³)	M _{rxLB} (k-in)	M _{rxDB} (k-in)	V _m (kip)	Jx1000 (in ⁴)	C _w (in ⁶)	x _o (in.)	m (in.)	r _o (in.)	β	L _u (in.)
600S162-33	0.500	0.0346	33	1.17	0.344	1.79	2.28	0.116	0.581	0.815	1.79	0.577	17.1	13.7	0.810	0.137	0.862	1.07	0.677	2.59	0.828	41.1
600S162-43	0.500	0.0451	33	1.52	0.447	2.32	2.28	0.148	0.576	1.81	2.32	0.767	25.1*	19.5	1.58	0.303	1.10	1.06	0.670	2.58	0.830	38.9
600S162-54	0.500	0.0566	50	1.89	0.556	2.86	2.27	0.181	0.570	3.61	2.86	0.915	45.6*	34.6	2.49	0.594	1.34	1.05	0.663	2.56	0.833	31.3
600S162-68	0.500	0.0713	50	2.36	0.693	3.53	2.26	0.218	0.561	6.84	3.53	1.16	59.3*	46.7	3.68	1.17	1.63	1.03	0.655	2.54	0.835	30.8
600S162-97	0.500	0.1017	50	3.29	0.965	4.80	2.23	0.283	0.542	13.4	4.80	1.60	85.3*	71.4	4.87	3.33	2.15	1.00	0.636	2.50	0.841	29.7
600S162-118	0.500	0.1242	50	3.94	1.16	5.65	2.21	0.322	0.527	16.0	5.65	1.88	104*	103	4.64	5.96	2.49	0.971	0.623	2.47	0.846	29.0
600S200-33	0.625	0.0346	33	1.29	0.379	2.08	2.34	0.209	0.743	0.815	2.04	0.621	18.4	15.7	0.810	0.151	1.59	1.46	0.901	2.86	0.740	51.6
600S200-43	0.625	0.0451	33	1.67	0.492	2.68	2.34	0.268	0.739	1.81	2.68	0.872	25.9	22.3	1.58	0.334	2.03	1.45	0.894	2.84	0.742	51.4
600S200-54	0.625	0.0566	50	2.09	0.613	3.32	2.33	0.329	0.732	3.61	3.32	1.02	45.7	39.5	2.49	0.655	2.49	1.43	0.887	2.83	0.744	41.5
600S200-68	0.625	0.0713	50	2.60	0.764	4.10	2.32	0.400	0.723	6.84	4.10	1.32	65.7*	53.3	3.68	1.30	3.05	1.42	0.878	2.81	0.746	39.3
600S200-97	0.625	0.1017	50	3.63	1.07	5.61	2.29	0.530	0.705	13.4	5.61	1.87	97.0*	82.6	4.87	3.68	4.08	1.38	0.859	2.77	0.752	38.3
600S200-118	0.625	0.1242	50	4.36	1.28	6.64	2.28	0.612	0.691	16.0	6.64	2.21	118*	117	4.64	6.59	4.75	1.35	0.845	2.74	0.756	37.6
600S250-43	0.625	0.0451	33	1.83	0.537	3.08	2.40	0.458	0.923	1.81	3.06	0.918	27.3	23.6	1.58	0.364	3.41	1.87	1.14	3.18	0.652	62.3
600S250-54	0.625	0.0566	50	2.28	0.670	3.82	2.39	0.562	0.917	3.61	3.66	1.07	48.1	41.5	2.49	0.715	4.19	1.86	1.13	3.16	0.654	50.4
600S250-68	0.625	0.0713	50	2.84	0.836	4.73	2.38	0.688	0.908	6.84	4.67	1.39	62.3	56.3	3.68	1.42	5.15	1.84	1.12	3.14	0.657	50.3
600S250-97	0.625	0.1017	50	3.98	1.17	6.50	2.36	0.923	0.889	13.4	6.50	2.06	104*	88.7	4.87	4.03	6.95	1.80	1.10	3.10	0.661	47.2
600S250-118	0.625	0.1242	50	4.79	1.41	7.72	2.34	1.08	0.874	16.0	7.71	2.50	129*	113	4.64	7.23	8.14	1.78	1.09	3.07	0.665	46.6
600S300-54	0.625	0.0451	33	2.47	0.726	4.32	2.44	0.875	1.10	3.61	3.94	1.11	49.8	42.9	2.49	0.775	6.45	2.30	1.37	3.53	0.575	59.0
600S300-68	0.625	0.0566	50	3.09	0.907	5.35	2.43	1.08	1.09	6.84	5.06	1.45	65.0	58.5	3.68	1.54	7.94	2.28	1.36	3.51	0.577	58.9
600S300-97	0.625	0.0713	50	4.32	1.27	7.38	2.41	1.45	1.07	13.4	7.25	2.25	101	93.2	4.87	4.38	10.8	2.24	1.34	3.46	0.581	58.8
600S300-118	0.625	0.1017	50	5.21	1.53	8.79	2.40	1.70	1.06	16.0	8.79	2.80	142*	120	4.64	7.87	12.7	2.21	1.33	3.43	0.583	55.3
800S162-33	0.500	0.0346	33	1.41	0.413	3.58	2.94	0.125	0.550	0.605	3.36	0.709	21.1	18.3	0.610	0.165	1.63	0.936	0.607	3.14	0.911	40.0
800S162-43	0.500	0.0451	33	1.83	0.537	4.64	2.94	0.160	0.546	1.34	4.48	1.02	30.3	26.5	1.34	0.364	2.08	0.926	0.601	3.13	0.912	39.8
800S162-54	0.500	0.0566	50	2.28	0.670	5.74	2.93	0.194	0.539	2.67	5.57	1.23	55.3	47.1	2.67	0.715	2.54	0.914	0.594	3.11	0.914	32.1
800S162-68	0.500	0.0713	50	2.84	0.836	7.09	2.91	0.235	0.530	5.39	7.05	1.66	74.8	64.5	4.30	1.42	3.09	0.898	0.586	3.09	0.916	31.8
800S162-97	0.500	0.1017	50	3.98	1.17	9.72	2.88	0.305	0.511	13.9	9.71	2.43	109	103	7.60	4.03	4.11	0.866	0.568	3.05	0.920	31.3
800S162-118	0.500	0.1242	50	4.79	1.41	11.5	2.86	0.347	0.496	20.8	11.5	2.88	158*	158	9.10	7.23	4.77	0.842	0.556	3.02	0.922	28.0
800S200-43	0.625	0.0451	33	1.98	0.582	5.30	3.02	0.292	0.708	1.34	5.30	1.29	38.4	30.5	1.34	0.395	3.80	1.28	0.811	3.35	0.855	50.3
800S200-54	0.625	0.0566	50	2.47	0.726	6.57	3.01	0.357	0.701	2.67	6.57	1.50	67.4	54.1	2.67	0.775	4.66	1.27	0.804	3.34	0.856	40.6
800S200-68	0.625	0.0713	50	3.09	0.907	8.14	3.00	0.435	0.692	5.39	8.14	1.96	98.0*	73.8	4.30	1.54	5.71	1.25	0.796	3.32	0.859	38.4
800S200-97	0.625	0.1017	50	4.32	1.27	11.2	2.97	0.576	0.674	13.9	11.2	2.80	145*	117	7.60	4.38	7.68	1.21	0.777	3.28	0.863	37.2
800S200-118	0.625	0.1242	50	5.21	1.53	13.3	2.95	0.666	0.659	20.8	13.3	3.33	177*	149	9.10	7.87	8.98	1.19	0.764	3.25	0.866	36.4
800S250-43	0.625	0.0451	33	2.13	0.627	6.02	3.10	0.500	0.893	1.34	5.98	1.31	39.0	32.1	1.34	0.425	6.37	1.68	1.04	3.63	0.787	61.5
800S250-54	0.625	0.0566	50	2.66	0.783	7.47	3.09	0.614	0.886	2.67	7.17	1.52	68.6	56.7	2.67	0.836	7.85	1.66	1.04	3.62	0.789	49.7
800S250-68	0.625	0.0713	50	3.33	0.978	9.26	3.08	0.752	0.877	5.39	9.14	2.06	92.6	77.7	4.30	1.66	9.65	1.64	1.03	3.60	0.791	49.5
800S250-97	0.625	0.1017	50	4.67	1.37	12.8	3.05	1.01	0.857	13.9	12.8	3.05	154*	125	7.60	4.73	13.1	1.61	1.01	3.56	0.796	46.3
800S250-118	0.625	0.1242	50	5.63	1.66	15.2	3.04	1.18	0.843	20.8	15.2	3.71	192*	161	9.10	8.51	15.4	1.58	0.99	3.52	0.799	45.6
800S300-54	0.625	0.0566	50	2.86	0.839	8.36	3.16	0.959	1.07	2.67	7.66	1.53	69.0	58.3	2.67	0.896	12.1	2.07	1.27	3.92	0.721	58.5
800S300-68	0.625	0.0713	50	3.57	1.05	10.4	3.15	1.18	1.06	5.39	9.84	2.14	96.5	80.3	4.30	1.78	14.9	2.06	1.26	3.90	0.723	58.3
800S300-97	0.625	0.1017	50	5.02	1.47	14.4	3.12	1.60	1.04	13.9	14.1	3.30	149	130	7.60	5.08	20.3	2.02	1.24	3.86	0.727	58.0
800S300-118	0.625	0.1242	50	6.05	1.78	17.2	3.11	1.87	1.03	20.8	17.2	4.11	208*	169	9.10	9.15	24.0	1.99	1.23	3.83	0.730	54.4
1000S162-33	0.500	0.0346	33	1.64	0.483	6.20	3.58	0.132	0.522	0.482	5.56	0.900	26.7	22.2	0.480	0.193	2.69	0.832	0.550	3.72	0.950	39.0
1000S162-43	0.500	0.0451	33	2.13	0.627	8.03	3.58	0.168	0.518	1.07	7.48	1.30	38.7	32.6	1.07	0.425	3.43	0.823	0.545	3.71	0.951	38.8
1000S162-54	0.500	0.0566	50	2.66	0.783	9.95	3.57	0.204	0.511	2.12	9.31	1.57	70.7	58.2	2.12	0.836	4.20	0.812	0.538	3.69	0.952	31.3
1000S162-68	0.500	0.0713	50	3.33	0.978	12.3	3.55	0.247	0.502	4.27	11.9	2.15	96.9	80.9	4.27	1.66	5.12	0.798	0.531	3.67	0.953	31.0
1000S162-97	0.500	0.1017	50	4.67	1.37	17.0	3.52	0.320	0.483	12.6	17.0	3.27	147	132	9.17	4.73	6.83	0.768	0.514	3.63	0.955	30.4
1000S162-118	0.500	0.1242	50	5.63	1.66	20.2	3.49	0.364	0.469	20.8	20.2	4.03	182	172	12.2	8.51	7.92	0.746	0.502	3.60	0.957	29.9
1000S200-43	0.625	0.0451	33	2.29	0.672	9.09	3.68	0.309	0.677	1.07	8.55	1.47	43.6	38.2	1.07	0.456	6.24	1.15	0.743	3.91	0.914	49.3
1000S200-54	0.625	0.0566	50	2.86	0.839	11.3	3.67	0.378	0.671	2.12	10.6	1.70	76.7	67.7	2.12	0.896	7.67	1.14	0.737	3.90	0.915	39.8
1000S200-68	0.625	0.0713	50	3.57	1.05	14.0	3.65	0.460	0.662	4.27	13.6	2.42	109	93.5	4.27	1.78	9.40	1.12	0.729	3.88	0.917	39.5
1000S200-97	0.625	0.1017	50	5.02	1.47	19.3	3.62	0.610	0.643	12.6	19.3	3.74	168	151	9.17	5.08	12.7	1.09	0.711	3.84	0.920	39.0
1000S200-118	0.625	0.1242	50	6.05	1.78	23.1	3.60	0.704	0.629	20.8	23.1	4.61	207	196	12.2	9.15	14.8	1.06	0.699	3.81	0.922	38.6
1000S250-43	0.625	0.0451	33	2.44	0.717	10.2																

BAILEY JOIST SECTION PROPERTIES

Joist Designation	Lip (in.)	Base Design Thickness (in.)	F _y (ksi)	GROSS							PERFORATED EFFECTIVE					TORSIONAL						
				Weight (lb/ft)	Area (in ²)	I _x (in ⁴)	r _x (in.)	I _y (in ⁴)	r _y (in.)	V _{rg} (kip)	I _{xd} (in ⁴)	S _{xe} (in ³)	M _{rxLB} (k-in)	M _{rxDB} (k-in)	V _{rn} (kip)	Jx1000 (in ⁴)	C _w (in ⁶)	x _o (in.)	m (in.)	r _o (in.)	β	L _u (in.)
1200S162-43	0.500	0.0451	50	2.44	0.717	12.7	4.20	0.174	0.493	0.886	11.3	1.58	47.1	37.8	0.890	0.486	5.18	0.742	0.499	4.30	0.970	37.8
1200S162-54	0.500	0.0566	50	3.05	0.896	15.7	4.19	0.212	0.486	1.76	14.1	1.91	86.1	67.6	1.76	0.957	6.34	0.732	0.493	4.28	0.971	30.4
1200S162-68	0.500	0.0713	50	3.81	1.12	19.5	4.17	0.255	0.477	3.54	18.3	2.64	119	95.2	3.54	1.90	7.74	0.719	0.485	4.26	0.972	30.1
1200S162-97	0.500	0.1017	50	5.36	1.58	27.0	4.14	0.332	0.459	10.4	26.6	4.09	184	159	9.47	5.43	10.3	0.691	0.470	4.22	0.973	29.5
1200S162-118	0.500	0.1242	50	6.48	1.90	32.2	4.11	0.377	0.445	19.1	32.1	5.17	233	210	14.1	9.79	12.0	0.670	0.459	4.19	0.974	29.0
1200S200-54	0.500	0.0566	50	3.24	0.953	17.7	4.31	0.394	0.643	1.76	16.1	2.07	93.2	79.8	1.76	1.02	11.6	1.03	0.681	4.48	0.947	39.0
1200S200-68	0.625	0.0713	50	4.06	1.19	22.0	4.29	0.479	0.634	3.54	20.7	2.96	133	111	3.54	2.02	14.2	1.02	0.673	4.46	0.948	38.7
1200S200-97	0.625	0.1017	50	5.71	1.68	30.4	4.26	0.635	0.615	10.4	30.1	4.66	210	184	9.47	5.78	19.1	0.987	0.656	4.42	0.950	38.1
1200S200-118	0.625	0.1242	50	6.90	2.03	36.4	4.23	0.733	0.601	19.1	36.3	5.86	264	241	14.1	10.4	22.5	0.964	0.644	4.38	0.952	37.7
1200S250-54	0.625	0.0566	50	3.43	1.01	19.7	4.42	0.683	0.823	1.76	17.3	2.15	96.6	85.1	1.76	1.08	19.5	1.38	0.892	4.70	0.914	48.3
1200S250-68	0.625	0.0713	50	4.30	1.26	24.5	4.40	0.836	0.813	3.54	22.9	3.01	135	119	3.54	2.14	24.0	1.36	0.884	4.68	0.915	48.0
1200S250-97	0.625	0.1017	50	6.05	1.78	34.0	4.37	1.12	0.794	10.4	33.7	5.04	227	196	9.47	6.13	32.7	1.33	0.867	4.64	0.918	47.5
1200S250-118	0.625	0.1242	50	7.32	2.15	40.7	4.35	1.31	0.779	19.1	40.7	6.54	294	258	14.1	11.1	38.6	1.31	0.854	4.61	0.920	47.1
1200S300-54	0.625	0.0566	50	3.63	1.07	21.7	4.51	1.07	1.00	1.76	18.8	2.27	102	88.2	1.76	1.14	30.1	1.74	1.11	4.94	0.876	57.4
1200S300-68	0.625	0.0713	50	4.54	1.34	27.0	4.50	1.32	0.994	3.54	25.7	3.32	149	123	3.54	2.26	37.1	1.73	1.10	4.92	0.877	57.1
1200S300-97	0.625	0.1017	50	6.40	1.88	37.6	4.47	1.79	0.975	10.4	37.0	5.83	262	205	9.47	6.48	50.9	1.69	1.09	4.88	0.880	56.6
1200S300-118	0.625	0.1242	50	7.75	2.28	45.1	4.45	2.10	0.960	19.1	45.1	7.23	366*	270	14.1	11.7	60.3	1.67	1.07	4.85	0.882	53.0
1200S350-54	1.00	0.0566	50	3.96	1.17	24.9	4.62	1.87	1.27	1.76	22.2	2.79	125	110	1.76	1.24	54.3	2.36	1.48	5.34	0.804	71.4
1200S350-68	1.00	0.0713	50	4.97	1.46	31.0	4.61	2.31	1.26	3.54	30.3	4.06	183	152	3.54	2.47	67.3	2.35	1.47	5.32	0.806	71.1
1200S350-97	1.00	0.1017	50	7.01	2.06	43.3	4.59	3.16	1.24	10.4	43.3	6.59	296	249	9.47	7.10	92.7	2.31	1.45	5.28	0.809	70.7
1200S350-118	1.00	0.1242	50	8.48	2.49	52.0	4.57	3.74	1.23	19.1	52.0	8.26	412*	326	14.1	12.8	110	2.28	1.44	5.25	0.811	66.8
1400S162-54	0.500	0.0566	50	3.43	1.01	23.3	4.81	0.218	0.464	1.50	20.1	2.25	101	75.5	1.50	1.08	8.98	0.667	0.454	4.87	0.981	29.7
1400S162-68	0.500	0.0713	50	4.30	1.26	29.0	4.79	0.262	0.456	3.02	26.1	3.13	141	107	3.02	2.14	11.0	0.654	0.447	4.85	0.982	29.3
1400S162-97	0.500	0.1017	50	6.05	1.78	40.1	4.75	0.341	0.438	8.86	38.6	4.91	221	183	8.86	6.13	14.7	0.628	0.433	4.81	0.983	28.6
1400S162-118	0.500	0.1242	50	7.32	2.15	47.9	4.72	0.387	0.424	16.3	47.5	6.28	283	244	14.4	11.1	17.0	0.609	0.422	4.78	0.984	28.1
1400S200-54	0.625	0.0566	50	3.63	1.07	26.0	4.94	0.406	0.617	1.50	22.8	2.44	110	90.1	1.50	1.14	16.4	0.946	0.633	5.06	0.965	38.2
1400S200-68	0.625	0.0713	50	4.54	1.34	32.3	4.92	0.494	0.608	3.02	29.5	3.50	158	127	3.02	2.26	20.1	0.932	0.625	5.04	0.966	37.9
1400S200-97	0.625	0.1017	50	6.40	1.88	44.9	4.88	0.655	0.590	8.86	43.4	5.58	251	213	8.86	6.48	27.2	0.904	0.609	5.00	0.967	37.2
1400S200-118	0.625	0.1242	50	7.75	2.28	53.7	4.86	0.756	0.576	16.3	53.3	7.10	319	283	14.4	11.7	31.9	0.883	0.598	4.97	0.968	36.8
1400S250-54	0.625	0.0566	50	3.82	1.12	28.7	5.06	0.707	0.794	1.50	24.3	2.53	114	97.2	1.50	1.20	27.7	1.27	0.835	5.28	0.942	47.5
1400S250-68	0.625	0.0713	50	4.78	1.41	35.8	5.04	0.865	0.784	3.02	32.5	3.55	160	137	3.02	2.38	34.1	1.26	0.827	5.26	0.943	47.2
1400S250-97	0.625	0.1017	50	6.75	1.98	49.8	5.01	1.16	0.765	8.86	48.3	6.01	270	229	8.86	6.83	46.5	1.23	0.811	5.22	0.945	46.6
1400S250-118	0.625	0.1242	50	8.17	2.40	59.7	4.99	1.35	0.751	16.3	59.3	7.88	354	305	14.4	12.3	54.9	1.20	0.798	5.18	0.946	46.2
1400S300-54	0.625	0.0566	50	4.01	1.18	31.5	5.17	1.11	0.972	1.50	25.5	2.58	116	102	1.50	1.26	42.7	1.62	1.05	5.50	0.914	56.7
1400S300-68	0.625	0.0713	50	5.03	1.48	39.2	5.15	1.37	0.963	3.02	34.3	3.65	164	143	3.02	2.50	52.8	1.60	1.04	5.48	0.915	56.4
1400S300-97	0.625	0.1017	50	7.09	2.08	54.7	5.12	1.85	0.943	8.86	52.2	6.37	287	240	8.86	7.19	72.4	1.57	1.02	5.44	0.917	55.9
1400S300-118	0.625	0.1242	50	8.59	2.52	65.7	5.10	2.18	0.928	16.3	65.3	8.42	379	320	14.4	13.0	85.8	1.54	1.01	5.41	0.919	55.4
1400S350-54	1.00	0.0566	50	4.35	1.28	35.8	5.30	1.95	1.23	1.50	30.9	3.25	146	128	1.50	1.36	76.3	2.21	1.40	5.87	0.859	70.6
1400S350-68	1.00	0.0713	50	5.45	1.60	44.7	5.28	2.41	1.23	3.02	42.9	4.71	212	178	3.02	2.71	94.5	2.19	1.39	5.85	0.860	70.4
1400S350-97	1.00	0.1017	50	7.70	2.26	62.5	5.26	3.30	1.21	8.86	62.5	8.18	368	294	8.86	7.80	130	2.16	1.37	5.81	0.862	69.9
1400S350-118	1.00	0.1242	50	9.33	2.74	75.2	5.24	3.90	1.19	16.3	75.2	10.3	512*	387	14.4	14.1	155	2.13	1.36	5.78	0.864	66.0
1600S162-68	0.500	0.0713	50	4.78	1.41	40.9	5.40	0.268	0.436	2.63	35.6	3.62	163	118	2.63	2.38	14.8	0.601	0.415	5.45	0.988	28.6
1600S162-97	0.500	0.1017	50	6.75	1.98	56.8	5.36	0.348	0.419	7.72	53.2	5.74	258	204	7.72	6.83	19.8	0.577	0.401	5.40	0.989	27.9
1600S162-118	0.500	0.1242	50	8.17	2.40	68.0	5.32	0.394	0.405	14.2	66.0	7.40	333	275	14.2	12.3	23.0	0.559	0.391	5.37	0.989	27.3
1600S200-68	0.625	0.0713	50	5.03	1.48	45.3	5.54	0.506	0.585	2.63	40.1	4.04	182	140	2.63	2.50	27.2	0.862	0.584	5.64	0.977	37.1
1600S200-97	0.625	0.1017	50	7.09	2.08	63.1	5.50	0.671	0.567	7.72	59.5	6.50	292	239	7.72	7.19	36.7	0.835	0.569	5.59	0.978	36.4
1600S200-118	0.625	0.1242	50	8.59	2.52	75.6	5.47	0.774	0.554	14.2	73.6	8.33	375	320	14.2	13.0	43.1	0.815	0.558	5.56	0.979	35.9
1600S250-68	0.625	0.0713	50	5.27	1.55	49.8	5.67	0.889	0.758	2.63	43.9	4.09	184	153	2.63	2.62	46.2	1.17	0.778	5.84	0.960	46.5
1600S250-97	0.625	0.1017	50	7.44	2.19	69.5	5.64	1.19	0.739	7.72	65.9	6.98	314	260	7.72	7.54	63.1	1.14	0.762	5.80	0.962	45.8
1600S250-118	0.625	0.1242	50	9.01	2.65	83.5	5.61	1.39	0.724	14.2	81.5	9.22	415	348	14.2	13.6	74.5	1.12	0.750	5.77	0.963	45.3
1600S300-68	0.625	0.0713	50	5.51	1.62	54.4	5.79	1.41	0.933	2.63	46.2	4.21	189	161	2.63	2.75	71.6	1.49	0.981	6.06	0.939	55.7
1600S300-97	0.625	0.1017	50	7.78	2.29	75.9	5.76	1.91	0.914	7.72	71.0	7.39	332	274	7.72	7.89	98.3	1.46	0.964	6.01	0.941	55.1
1600S300-118	0.625	0.1242	50	9.44	2.77	91.3	5.74	2.24	0.899	14.2	89.3	9.83	442	368	14.2	14.3	11					

BAILEY MAXIMUM FLOOR JOIST SPANS (ft)

Joist Member	F _y (ksi)	15 psf Dead Load 40 psf Live Load											
		TL Deflection = L/240, LL Deflection = L/360						TL Deflection = L/240, LL Deflection = L/480					
		SINGLE SPAN			TWO EQUAL SPANS			SINGLE SPAN			TWO EQUAL SPANS		
		Joist Spacing (in.) o.c.			Joist Spacing (in.) o.c.			Joist Spacing (in.) o.c.			Joist Spacing (in.) o.c.		
		12	16	24	12	16	24	12	16	24	12	16	24
600S162-33	33	10' 9"	9' 3"	7' 7"	10' 7"	8' 9"	6' 7"	10' 9"	9' 3"	7' 7"	10' 7"	8' 9"	6' 7"
600S162-43	33	12' 10"	11' 1"	9' 1"	12' 10"	11' 1"	9' 1"	12' 4"	11' 1"	9' 1"	12' 10"	11' 1"	9' 1"
600S162-54	50	14' 7"	13' 3"	11' 7"	16' 4"	14' 9"	12' 1"	13' 3"	12' 1"	10' 6"	14' 10"	13' 6"	11' 9"
600S162-68	50	15' 8"	14' 2"	12' 4"	17' 7"	16' 0"	14' 0"	14' 2"	12' 10"	11' 3"	16' 0"	14' 6"	12' 8"
600S162-97	50	17' 4"	15' 9"	13' 9"	19' 6"	17' 8"	15' 6"	15' 9"	14' 3"	12' 6"	17' 8"	16' 1"	14' 1"
600S162-118	50	18' 3"	16' 8"	14' 7"	20' 7"	18' 8"	16' 3"	16' 8"	15' 1"	13' 2"	18' 8"	17' 0"	14' 10"
600S200-33	33	11' 6"	10' 0"	8' 1"	10' 10"	9' 0"	6' 8"	11' 6"	10' 0"	8' 1"	10' 10"	9' 0"	6' 8"
600S200-43	33	13' 9"	11' 10"	9' 8"	13' 9"	11' 10"	9' 4"	13' 0"	11' 9"	9' 8"	13' 9"	11' 10"	9' 4"
600S200-54	50	15' 4"	14' 0"	12' 2"	17' 2"	15' 8"	12' 10"	14' 0"	12' 8"	11' 1"	15' 8"	14' 2"	12' 4"
600S200-68	50	16' 6"	15' 0"	13' 1"	18' 6"	16' 9"	14' 8"	15' 0"	13' 7"	11' 10"	16' 9"	15' 3"	13' 3"
600S200-97	50	18' 3"	16' 7"	14' 6"	20' 6"	18' 8"	16' 3"	16' 7"	15' 1"	13' 2"	18' 8"	17' 0"	14' 9"
600S200-118	50	19' 4"	17' 7"	15' 4"	21' 8"	19' 8"	17' 2"	17' 7"	16' 0"	14' 0"	19' 8"	17' 10"	15' 8"
600S250-43	33	14' 1"	12' 2"	10' 0"	14' 1"	12' 2"	9' 7"	13' 7"	12' 2"	10' 0"	14' 1"	12' 2"	9' 7"
600S250-54	50	15' 10"	14' 4"	12' 7"	17' 9"	16' 2"	13' 2"	14' 4"	13' 1"	11' 4"	16' 2"	14' 8"	12' 10"
600S250-68	50	17' 2"	15' 7"	13' 8"	19' 3"	17' 7"	15' 3"	15' 7"	14' 2"	12' 4"	17' 7"	15' 10"	13' 10"
600S250-97	50	19' 2"	17' 6"	15' 3"	21' 7"	19' 7"	17' 1"	17' 6"	15' 10"	13' 10"	19' 7"	17' 9"	15' 7"
600S250-118	50	20' 4"	18' 6"	16' 2"	22' 9"	20' 9"	18' 1"	18' 6"	16' 9"	14' 8"	20' 9"	18' 10"	16' 6"
600S300-54	50	16' 3"	14' 9"	12' 10"	18' 3"	16' 6"	13' 4"	14' 9"	13' 4"	11' 8"	16' 7"	15' 1"	13' 2"
600S300-68	50	17' 8"	16' 1"	14' 0"	19' 10"	18' 0"	15' 8"	16' 1"	14' 7"	12' 9"	18' 0"	16' 4"	14' 3"
600S300-97	50	19' 10"	18' 1"	15' 9"	22' 4"	20' 3"	17' 9"	18' 1"	16' 6"	14' 4"	20' 3"	18' 6"	16' 1"
600S300-118	50	21' 3"	19' 3"	16' 10"	23' 10"	21' 8"	18' 10"	19' 3"	17' 6"	15' 3"	21' 8"	19' 8"	17' 2"
800S162-33	33	12' 4"	10' 9"	7' 8"	10' 1"	8' 1"	5' 8"	12' 4"	10' 9"	7' 8"	10' 1"	8' 1"	5' 8"
800S162-43	33	15' 0"	13' 0"	10' 7"	14' 8"	12' 4"	9' 7"	15' 0"	13' 0"	10' 7"	14' 8"	12' 4"	9' 7"
800S162-54	50	18' 3"	16' 7"	14' 1"	20' 0"	17' 3"	14' 1"	16' 7"	15' 1"	13' 2"	18' 7"	16' 10"	14' 1"
800S162-68	50	19' 9"	17' 10"	15' 8"	22' 2"	20' 1"	16' 6"	17' 10"	16' 3"	14' 2"	20' 1"	18' 3"	16' 0"
800S162-97	50	22' 0"	20' 0"	17' 4"	24' 8"	22' 4"	19' 7"	20' 0"	18' 1"	15' 9"	22' 4"	20' 4"	17' 9"
800S162-118	50	23' 3"	21' 1"	18' 6"	26' 1"	23' 8"	20' 8"	21' 1"	19' 2"	16' 9"	23' 8"	21' 6"	18' 9"
800S200-43	33	16' 1"	13' 10"	11' 4"	16' 1"	13' 6"	10' 3"	16' 1"	13' 10"	11' 4"	16' 1"	13' 6"	10' 3"
800S200-54	50	19' 3"	17' 6"	15' 1"	21' 4"	18' 6"	15' 1"	17' 6"	15' 10"	13' 10"	19' 8"	17' 10"	15' 1"
800S200-68	50	20' 8"	18' 9"	16' 4"	23' 3"	21' 1"	17' 8"	18' 9"	17' 1"	14' 10"	21' 1"	19' 2"	16' 9"
800S200-97	50	23' 0"	20' 10"	18' 3"	25' 10"	23' 6"	20' 6"	20' 10"	19' 0"	16' 7"	23' 6"	21' 4"	18' 8"
800S200-118	50	24' 4"	22' 2"	19' 4"	27' 4"	24' 10"	21' 8"	22' 2"	20' 2"	17' 7"	24' 10"	22' 7"	19' 9"
800S250-43	33	16' 6"	14' 3"	11' 7"	16' 3"	13' 7"	10' 4"	16' 6"	14' 3"	11' 7"	16' 3"	13' 7"	10' 4"
800S250-54	50	19' 10"	18' 0"	15' 6"	21' 10"	19' 0"	15' 6"	18' 0"	16' 4"	14' 3"	20' 3"	18' 4"	15' 6"
800S250-68	50	21' 6"	19' 7"	17' 1"	24' 2"	22' 0"	18' 1"	19' 7"	17' 9"	15' 6"	22' 0"	20' 0"	17' 4"
800S250-97	50	24' 1"	21' 10"	19' 1"	27' 0"	24' 7"	21' 6"	21' 10"	19' 10"	17' 4"	24' 7"	22' 3"	19' 6"
800S250-118	50	25' 6"	23' 2"	20' 3"	28' 8"	26' 0"	22' 9"	23' 2"	21' 1"	18' 4"	26' 0"	23' 8"	20' 8"
800S300-54	50	20' 3"	18' 6"	15' 8"	22' 2"	19' 2"	15' 6"	18' 6"	16' 9"	14' 7"	20' 8"	18' 9"	15' 6"
800S300-68	50	22' 1"	20' 1"	17' 6"	24' 9"	22' 6"	18' 4"	20' 1"	18' 2"	15' 10"	22' 6"	20' 6"	17' 10"
800S300-97	50	24' 10"	22' 7"	19' 9"	27' 10"	25' 4"	22' 2"	22' 7"	20' 6"	18' 0"	25' 4"	23' 1"	20' 2"
800S300-118	50	26' 7"	24' 1"	21' 1"	29' 9"	27' 1"	23' 8"	24' 1"	21' 10"	19' 2"	27' 1"	24' 7"	21' 6"
1000S162-33	33	12' 3"	9' 2"	6' 1"	9' 1"	7' 0"	4' 9"	12' 3"	9' 2"	6' 1"	9' 1"	7' 0"	4' 9"
1000S162-43	33	16' 7"	14' 4"	11' 9"	15' 3"	12' 6"	9' 3"	16' 7"	14' 4"	11' 9"	15' 3"	12' 6"	9' 3"
1000S162-54	50	21' 8"	19' 2"	15' 8"	22' 2"	19' 1"	14' 9"	19' 8"	17' 10"	15' 7"	22' 1"	19' 1"	14' 9"
1000S162-68	50	23' 6"	21' 4"	18' 6"	26' 2"	22' 8"	18' 6"	21' 4"	19' 4"	17' 0"	24' 0"	21' 9"	18' 6"
1000S162-97	50	26' 6"	24' 0"	21' 0"	29' 8"	27' 0"	23' 7"	24' 0"	21' 9"	19' 1"	27' 0"	24' 6"	21' 4"
1000S162-118	50	28' 0"	25' 6"	22' 3"	31' 6"	28' 7"	25' 0"	25' 6"	23' 1"	20' 2"	28' 7"	26' 0"	22' 8"
1000S200-43	33	18' 0"	15' 7"	12' 8"	15' 10"	13' 0"	9' 6"	18' 0"	15' 7"	12' 8"	15' 10"	13' 0"	9' 6"
1000S200-54	50	22' 8"	20' 7"	16' 10"	23' 4"	19' 8"	15' 2"	20' 7"	18' 8"	16' 3"	23' 1"	19' 8"	15' 2"
1000S200-68	50	24' 7"	22' 3"	19' 6"	27' 7"	24' 4"	19' 10"	22' 3"	20' 3"	17' 8"	25' 1"	22' 9"	19' 10"
1000S200-97	50	27' 7"	25' 1"	21' 10"	31' 0"	28' 2"	24' 7"	25' 1"	22' 9"	19' 10"	28' 2"	25' 7"	22' 4"
1000S200-118	50	29' 3"	26' 7"	23' 3"	32' 10"	29' 10"	26' 1"	26' 7"	24' 2"	21' 1"	29' 10"	27' 2"	23' 8"
1000S250-43	33	18' 4"	15' 10"	13' 0"	16' 4"	13' 3"	9' 8"	18' 4"	15' 10"	13' 0"	16' 4"	13' 3"	9' 8"
1000S250-54	50	23' 8"	21' 3"	17' 4"	24' 3"	20' 4"	15' 8"	21' 6"	19' 7"	17' 1"	24' 2"	20' 4"	15' 8"
1000S250-68	50	25' 8"	23' 4"	20' 4"	28' 10"	25' 1"	20' 6"	23' 4"	21' 2"	18' 6"	26' 2"	23' 9"	20' 6"
1000S250-97	50	28' 9"	26' 2"	22' 9"	32' 3"	29' 4"	25' 7"	26' 2"	23' 9"	20' 9"	29' 4"	26' 8"	23' 3"
1000S250-118	50	30' 6"	27' 9"	24' 2"	34' 3"	31' 2"	27' 2"	27' 9"	25' 2"	22' 0"	31' 2"	28' 3"	24' 8"
1000S300-54	50	24' 1"	21' 7"	17' 7"	24' 4"	20' 6"	15' 8"	21' 10"	19' 10"	17' 4"	24' 4"	20' 6"	15' 8"
1000S300-68	50	26' 3"	23' 10"	20' 9"	29' 4"	25' 6"	20' 9"	23' 10"	21' 8"	19' 0"	26' 9"	24' 4"	20' 9"
1000S300-97	50	29' 8"	27' 0"	23' 6"	33' 3"	30' 3"	26' 4"	27' 0"	24' 6"	21' 4"	30' 3"	27' 6"	24' 0"
1000S300-118	50	31' 8"	28' 9"	25' 1"	35' 7"	32' 3"	28' 2"	28' 9"	26' 2"	22' 9"	32' 3"	29' 4"	25' 7"
1000S350-54	50	25' 6"	23' 1"	19' 3"	26' 6"	22' 1"	16' 8"	23' 1"	21' 0"	18' 4"	26' 0"	22' 1"	16' 8"
1000S350-68	50	27' 9"	25' 3"	22' 1"	31' 2"	28' 0"	22' 9"	25' 3"	23' 0"	20' 1"	28' 4"	25' 9"	22' 6"
1000S350-97	50	31' 3"	28' 6"	24' 10"	35' 2"	32' 0"	27' 10"	28' 6"	25' 10"	22' 7"	32' 0"	29' 0"	25' 4"
1000S350-118	50	33' 3"	30' 2"	26' 4"	37' 4"	34' 0"	29' 8"	30' 2"	27' 6"	24' 0"	34' 0"	30' 9"	26' 10"

BAILEY MAXIMUM FLOOR JOIST SPANS (ft)

Joist Member	F _y (ksi)	15 psf Dead Load 40 psf Live Load											
		TL Deflection = L/240, LL Deflection = L/360						TL Deflection = L/240, LL Deflection = L/480					
		SINGLE SPAN			TWO EQUAL SPANS			SINGLE SPAN			TWO EQUAL SPANS		
		Joist Spacing (in.) o.c.			Joist Spacing (in.) o.c.			Joist Spacing (in.) o.c.			Joist Spacing (in.) o.c.		
		12	16	24	12	16	24	12	16	24	12	16	24
1200S162-43	33	17' 10"	15' 6"	11' 3"	14' 10"	11' 10"	8' 4"	17' 10"	15' 6"	11' 3"	14' 10"	11' 10"	8' 4"
1200S162-54	50	23' 10"	20' 8"	16' 10"	23' 6"	19' 4"	14' 7"	22' 7"	20' 7"	16' 10"	23' 6"	19' 4"	14' 7"
1200S162-68	50	27' 1"	24' 7"	20' 1"	28' 4"	24' 7"	20' 1"	24' 7"	22' 4"	19' 7"	27' 8"	24' 7"	20' 1"
1200S162-97	50	30' 8"	27' 10"	24' 4"	34' 6"	31' 4"	26' 0"	27' 10"	25' 4"	22' 2"	31' 4"	28' 6"	24' 10"
1200S162-118	50	32' 8"	29' 9"	26' 0"	36' 9"	33' 4"	29' 2"	29' 9"	27' 0"	23' 7"	33' 4"	30' 3"	26' 6"
1200S200-54	50	26' 0"	22' 6"	18' 4"	24' 1"	19' 10"	14' 10"	23' 7"	21' 6"	18' 4"	24' 1"	19' 10"	14' 10"
1200S200-68	50	28' 3"	25' 8"	21' 8"	30' 8"	26' 7"	21' 3"	25' 8"	23' 3"	20' 4"	28' 9"	26' 2"	21' 3"
1200S200-97	50	32' 0"	29' 1"	25' 4"	36' 0"	32' 8"	27' 10"	29' 1"	26' 4"	23' 1"	32' 8"	29' 8"	25' 10"
1200S200-118	50	34' 1"	31' 0"	27' 1"	38' 3"	34' 9"	30' 4"	31' 0"	28' 2"	24' 7"	34' 9"	31' 7"	27' 7"
1200S250-54	50	26' 7"	23' 2"	18' 10"	24' 6"	20' 1"	15' 0"	24' 2"	22' 0"	18' 10"	24' 6"	20' 1"	15' 0"
1200S250-68	50	29' 3"	26' 7"	22' 4"	31' 8"	27' 2"	21' 6"	26' 7"	24' 1"	21' 1"	29' 9"	27' 1"	21' 6"
1200S250-97	50	33' 3"	30' 2"	26' 4"	37' 3"	33' 10"	28' 9"	30' 2"	27' 6"	24' 0"	33' 10"	30' 9"	26' 10"
1200S250-118	50	35' 4"	32' 2"	28' 1"	39' 9"	36' 1"	31' 7"	32' 2"	29' 3"	25' 7"	36' 1"	32' 9"	28' 8"
1200S300-54	50	27' 1"	23' 6"	19' 2"	24' 10"	20' 6"	15' 2"	24' 10"	22' 7"	19' 2"	24' 10"	20' 6"	15' 2"
1200S300-68	50	30' 4"	27' 7"	22' 10"	32' 3"	28' 0"	22' 3"	27' 7"	25' 1"	21' 10"	31' 0"	28' 0"	22' 3"
1200S300-97	50	34' 3"	31' 2"	27' 2"	38' 6"	35' 0"	29' 4"	31' 2"	28' 3"	24' 8"	35' 0"	31' 9"	27' 9"
1200S300-118	50	36' 8"	33' 3"	29' 1"	41' 2"	37' 4"	32' 8"	33' 3"	30' 3"	26' 4"	37' 4"	34' 0"	29' 8"
1200S350-54	50	29' 0"	25' 6"	20' 10"	26' 7"	21' 8"	15' 9"	26' 3"	23' 10"	20' 10"	26' 7"	21' 8"	15' 9"
1200S350-68	50	32' 1"	29' 2"	24' 10"	35' 2"	30' 4"	24' 0"	29' 2"	26' 6"	23' 2"	32' 9"	29' 9"	24' 0"
1200S350-97	50	36' 2"	32' 10"	28' 8"	40' 7"	36' 10"	32' 2"	32' 10"	29' 9"	26' 1"	36' 10"	33' 6"	29' 3"
1200S350-118	50	38' 4"	34' 10"	30' 6"	43' 2"	39' 2"	34' 2"	34' 10"	31' 8"	27' 8"	39' 2"	35' 7"	31' 1"
1400S162-54	50	25' 3"	21' 10"	17' 10"	23' 6"	19' 0"	13' 8"	25' 3"	21' 10"	17' 10"	23' 6"	19' 0"	13' 8"
1400S162-68	50	30' 2"	26' 1"	21' 3"	30' 2"	26' 1"	20' 10"	27' 9"	25' 2"	21' 3"	30' 2"	26' 1"	20' 10"
1400S162-97	50	34' 9"	31' 7"	27' 7"	39' 1"	34' 1"	27' 9"	31' 7"	28' 8"	25' 1"	35' 6"	32' 3"	27' 9"
1400S162-118	50	37' 3"	33' 10"	29' 7"	41' 10"	38' 1"	32' 2"	33' 10"	30' 9"	26' 10"	38' 1"	34' 7"	30' 2"
1400S200-54	50	27' 7"	23' 10"	19' 1"	24' 0"	19' 4"	13' 10"	26' 6"	23' 10"	19' 1"	24' 0"	19' 4"	13' 10"
1400S200-68	50	31' 9"	28' 4"	23' 2"	32' 9"	28' 2"	21' 8"	28' 10"	26' 3"	23' 0"	32' 6"	28' 2"	21' 8"
1400S200-97	50	36' 2"	32' 10"	28' 8"	40' 7"	36' 9"	30' 0"	32' 10"	29' 10"	26' 1"	36' 10"	33' 6"	29' 3"
1400S200-118	50	38' 9"	35' 2"	30' 9"	43' 6"	39' 6"	34' 6"	35' 2"	32' 0"	28' 0"	39' 6"	35' 10"	31' 4"
1400S250-54	50	28' 6"	24' 8"	19' 1"	24' 2"	19' 6"	14' 0"	27' 1"	24' 7"	19' 1"	24' 2"	19' 6"	14' 0"
1400S250-68	50	32' 10"	29' 6"	24' 1"	33' 7"	28' 3"	21' 9"	29' 10"	27' 1"	23' 8"	33' 6"	28' 3"	21' 9"
1400S250-97	50	37' 6"	34' 1"	29' 9"	42' 1"	38' 2"	31' 2"	34' 1"	31' 0"	27' 0"	38' 3"	34' 9"	30' 4"
1400S250-118	50	40' 2"	36' 6"	31' 10"	45' 1"	41' 0"	35' 9"	36' 6"	33' 2"	29' 0"	41' 0"	37' 2"	32' 6"
1400S300-54	50	28' 10"	25' 0"	19' 1"	24' 4"	19' 7"	14' 0"	27' 7"	25' 0"	19' 1"	24' 4"	19' 7"	14' 0"
1400S300-68	50	33' 6"	30' 1"	24' 6"	34' 0"	28' 7"	22' 0"	30' 4"	27' 7"	24' 1"	34' 0"	28' 7"	22' 0"
1400S300-97	50	38' 6"	35' 0"	30' 7"	43' 2"	39' 1"	31' 10"	35' 0"	31' 9"	27' 9"	39' 3"	35' 8"	31' 2"
1400S300-118	50	41' 6"	37' 8"	32' 10"	46' 7"	42' 3"	36' 9"	37' 8"	34' 2"	29' 10"	42' 3"	38' 4"	33' 7"
1400S350-54	50	31' 2"	27' 0"	19' 1"	25' 9"	20' 6"	14' 4"	29' 4"	26' 8"	19' 1"	25' 9"	20' 6"	14' 4"
1400S350-68	50	36' 1"	32' 4"	26' 6"	37' 6"	31' 4"	23' 9"	32' 9"	29' 9"	26' 0"	36' 9"	31' 4"	23' 9"
1400S350-97	50	40' 10"	37' 1"	32' 4"	45' 10"	41' 8"	34' 8"	37' 1"	33' 8"	29' 6"	41' 8"	37' 10"	33' 1"
1400S350-118	50	43' 6"	39' 6"	34' 6"	48' 9"	44' 3"	38' 8"	39' 6"	35' 10"	31' 3"	44' 3"	40' 3"	35' 2"
1600S162-68	50	31' 7"	27' 4"	22' 4"	31' 7"	27' 4"	20' 9"	30' 9"	27' 4"	22' 4"	31' 7"	27' 4"	20' 9"
1600S162-97	50	38' 8"	35' 2"	29' 4"	41' 6"	36' 0"	29' 4"	35' 2"	32' 0"	27' 10"	39' 6"	35' 10"	29' 4"
1600S162-118	50	41' 7"	37' 9"	33' 0"	46' 8"	41' 9"	34' 1"	37' 9"	34' 4"	30' 0"	42' 6"	38' 7"	33' 8"
1600S200-68	50	34' 6"	29' 10"	24' 4"	34' 4"	28' 6"	21' 6"	32' 0"	29' 1"	24' 4"	34' 4"	28' 6"	21' 6"
1600S200-97	50	40' 2"	36' 6"	31' 9"	45' 0"	39' 0"	31' 9"	36' 6"	33' 2"	29' 0"	41' 0"	37' 3"	31' 9"
1600S200-118	50	43' 2"	39' 2"	34' 3"	48' 6"	44' 0"	36' 9"	39' 2"	35' 7"	31' 1"	44' 0"	40' 0"	34' 10"
1600S250-68	50	36' 0"	31' 2"	25' 4"	34' 6"	28' 7"	21' 6"	33' 0"	30' 0"	25' 4"	34' 6"	28' 7"	21' 6"
1600S250-97	50	41' 7"	37' 9"	33' 0"	46' 8"	40' 7"	33' 2"	37' 9"	34' 3"	30' 0"	42' 4"	38' 7"	33' 2"
1600S250-118	50	44' 8"	40' 7"	35' 4"	50' 1"	45' 6"	38' 4"	40' 7"	36' 10"	32' 2"	45' 6"	41' 4"	36' 1"
1600S300-68	50	36' 7"	31' 8"	25' 10"	34' 10"	28' 10"	21' 8"	33' 7"	30' 6"	25' 10"	34' 10"	28' 10"	21' 8"
1600S300-97	50	42' 8"	38' 9"	33' 10"	47' 10"	41' 8"	34' 1"	38' 9"	35' 2"	30' 9"	43' 6"	39' 6"	34' 1"
1600S300-118	50	46' 0"	41' 9"	36' 6"	51' 8"	47' 0"	39' 6"	41' 9"	38' 0"	33' 2"	47' 0"	42' 8"	37' 3"
1600S350-68	50	39' 2"	34' 0"	27' 9"	37' 6"	30' 9"	22' 9"	35' 7"	32' 4"	27' 9"	37' 6"	30' 9"	22' 9"
1600S350-97	50	44' 10"	40' 9"	35' 7"	50' 4"	45' 1"	36' 10"	40' 9"	37' 1"	32' 4"	45' 9"	41' 7"	36' 3"
1600S350-118	50	48' 1"	43' 8"	38' 2"	54' 0"	49' 1"	42' 10"	43' 8"	39' 8"	34' 8"	49' 1"	44' 7"	39' 0"

GENERAL NOTES:

- Spans are based on continuous lateral support of the compression flange over the full joist length.
- Tension flange must be laterally braced at a maximum spacing of 8'-0".
- Joists must be braced against rotation at all supports.
- Distortional buckling calculations are based on $K\phi = 0$.
- For two equal spans, the listed span is the distance from either end to the continuous centre support.
- End web crippling check is based on 3.5" end bearing. Where listed spans are followed by "e", web stiffeners are required at end supports.
- Web stiffeners are required at interior supports.
- Total load (TL) deflection is based on L/240 and live load (LL) deflection is based on either L/360 or L/480.

BAILEY MAXIMUM FLOOR JOIST SPANS (ft)

Joist Member	F _y (ksi)	25 psf Dead Load 40 psf Live Load											
		TL Deflection = L/240, LL Deflection = L/360						TL Deflection = L/240, LL Deflection = L/480					
		SINGLE SPAN			TWO EQUAL SPANS			SINGLE SPAN			TWO EQUAL SPANS		
		Joist Spacing (in.) o.c.			Joist Spacing (in.) o.c.			Joist Spacing (in.) o.c.			Joist Spacing (in.) o.c.		
		12	16	24	12	16	24	12	16	24	12	16	24
600S162-33	33	10' 0"e	8' 8"e	7' 1"e	9' 7"e	7' 10"e	5' 10"e	10' 0"e	8' 8"e	7' 1"e	9' 7"e	7' 10"e	5' 10"e
600S162-43	33	11' 10"e	10' 3"e	8' 4"e	11' 10"	10' 3"	8' 4"e	11' 10"e	10' 3"e	8' 4"e	11' 10"	10' 3"	8' 4"e
600S162-54	50	14' 2"	12' 10"	11' 2"	15' 10"	13' 9"	11' 2"	13' 3"	12' 1"	10' 6"	14' 10"	13' 6"	11' 2"
600S162-68	50	15' 3"	13' 10"	12' 1"	17' 7"	16' 0"	13' 1"	14' 2"	12' 10"	11' 3"	16' 0"	14' 6"	12' 8"
600S162-97	50	16' 10"	15' 4"	13' 4"	19' 6"	17' 8"	15' 6"	15' 9"	14' 3"	12' 6"	17' 8"	16' 1"	14' 1"
600S162-118	50	17' 10"	16' 2"	14' 2"	20' 7"	18' 8"	16' 3"	16' 8"	15' 1"	13' 2"	18' 8"	17' 0"	14' 10"
600S200-33	33	10' 8"e	9' 3"e	7' 7"e	9' 10"e	8' 1"e	6' 0"e	10' 8"e	9' 3"e	7' 7"e	9' 10"e	8' 1"e	6' 0"e
600S200-43	33	12' 9"e	11' 1"e	9' 0"e	12' 9"	11' 0"	8' 7"e	12' 9"e	11' 1"e	9' 0"e	12' 9"	11' 0"	8' 7"e
600S200-54	50	15' 0"	13' 7"	11' 10"	17' 0"	14' 8"	11' 9"	14' 0"	12' 8"	11' 1"	15' 8"	14' 2"	11' 9"
600S200-68	50	16' 1"	14' 7"	12' 8"	18' 6"	16' 9"	14' 0"	15' 0"	13' 7"	11' 10"	16' 9"	15' 3"	13' 3"
600S200-97	50	17' 9"	16' 2"	14' 1"	20' 6"	18' 8"	16' 3"	16' 7"	15' 1"	13' 2"	18' 8"	17' 0"	14' 9"
600S200-118	50	18' 10"	17' 1"	15' 0"	21' 8"	19' 8"	17' 2"	17' 7"	16' 0"	14' 0"	19' 8"	17' 10"	15' 8"
600S250-43	33	13' 1"e	11' 4"e	9' 3"e	13' 1"	11' 2"	8' 9"e	13' 1"e	11' 4"e	9' 3"e	13' 1"	11' 2"	8' 9"e
600S250-54	50	15' 6"	14' 0"	12' 3"	17' 4"	15' 1"	12' 1"	14' 4"	13' 1"	11' 4"	16' 2"	14' 8"	12' 1"
600S250-68	50	16' 9"	15' 2"	13' 3"	19' 3"	17' 7"	14' 3"	15' 7"	14' 2"	12' 4"	17' 7"	15' 10"	13' 10"
600S250-97	50	18' 8"	17' 0"	14' 10"	21' 7"	19' 7"	17' 1"	17' 6"	15' 10"	13' 10"	19' 7"	17' 9"	15' 7"
600S250-118	50	19' 9"	18' 0"	15' 8"	22' 9"	20' 9"	18' 1"	18' 6"	16' 9"	14' 8"	20' 9"	18' 10"	16' 6"
600S300-54	50	15' 9"	14' 4"	12' 6"	17' 8"	15' 3"	12' 3"	14' 9"	13' 4"	11' 8"	16' 7"	15' 1"	12' 3"
600S300-68	50	17' 2"	15' 7"	13' 8"	19' 10"	17' 10"	14' 7"	16' 1"	14' 7"	12' 9"	18' 0"	16' 4"	14' 3"
600S300-97	50	19' 4"	17' 7"	15' 4"	22' 4"	20' 3"	17' 9"	18' 1"	16' 6"	14' 4"	20' 3"	18' 6"	16' 1"
600S300-118	50	20' 8"	18' 9"	16' 4"	23' 10"	21' 8"	18' 10"	19' 3"	17' 6"	15' 3"	21' 8"	19' 8"	17' 2"
800S162-33	33	11' 7"e	10' 0"e	6' 7"e	9' 0"e	7' 2"e	5' 0"e	11' 7"e	10' 0"e	6' 7"e	9' 0"e	7' 2"e	5' 0"e
800S162-43	33	13' 10"e	12' 0"e	9' 9"e	13' 6"	11' 3"e	8' 8"e	13' 10"e	12' 0"e	9' 9"e	13' 6"	11' 3"e	8' 8"e
800S162-54	50	17' 9"	16' 1"	13' 1"e	18' 7"	16' 1"	13' 0"	16' 7"	15' 1"	13' 1"e	18' 7"	16' 1"	13' 0"
800S162-68	50	19' 2"	17' 6"	15' 3"	21' 8"	18' 9"	15' 4"	17' 10"	16' 3"	14' 2"	20' 1"	18' 3"	15' 4"
800S162-97	50	21' 4"	19' 4"	17' 0"	24' 8"	22' 4"	19' 4"	20' 0"	18' 1"	15' 9"	22' 4"	20' 4"	17' 9"
800S162-118	50	22' 7"	20' 7"	18' 0"	26' 1"	23' 8"	20' 8"	21' 1"	19' 2"	16' 9"	23' 8"	21' 6"	18' 9"
800S200-43	33	14' 10"e	12' 10"e	10' 7"e	14' 9"e	12' 3"e	9' 3"e	14' 10"e	12' 10"e	10' 7"e	14' 9"e	12' 3"e	9' 3"e
800S200-54	50	18' 9"	17' 1"	14' 1"e	19' 10"	17' 2"	14' 0"	17' 6"	15' 10"	13' 10"e	19' 8"	17' 2"	14' 0"
800S200-68	50	20' 2"	18' 3"	16' 0"	23' 2"	20' 1"	16' 4"	18' 9"	17' 1"	14' 10"	21' 1"	19' 2"	16' 4"
800S200-97	50	22' 4"	20' 4"	17' 9"	25' 10"	23' 6"	20' 6"	20' 10"	19' 0"	16' 7"	23' 6"	21' 4"	18' 8"
800S200-118	50	23' 9"	21' 7"	18' 10"	27' 4"	24' 10"	21' 8"	22' 2"	20' 2"	17' 7"	24' 10"	22' 7"	19' 9"
800S250-43	33	15' 3"e	13' 2"e	10' 9"e	14' 10"e	12' 4"e	9' 3"e	15' 3"e	13' 2"e	10' 9"e	14' 10"e	12' 4"e	9' 3"e
800S250-54	50	19' 3"	17' 7"	14' 4"e	20' 4"	17' 7"	14' 1"	18' 0"	16' 4"	14' 3"e	20' 3"	17' 7"	14' 1"
800S250-68	50	21' 0"	19' 1"	16' 7"	23' 9"	20' 7"	16' 10"	19' 7"	17' 9"	15' 6"	22' 0"	20' 0"	16' 10"
800S250-97	50	23' 6"	21' 3"	18' 7"	27' 0"	24' 7"	21' 3"	21' 10"	19' 10"	17' 4"	24' 7"	22' 3"	19' 6"
800S250-118	50	24' 10"	22' 7"	19' 8"	28' 8"	26' 0"	22' 9"	23' 2"	21' 1"	18' 4"	26' 0"	23' 8"	20' 8"
800S300-54	50	19' 9"	17' 10"	14' 7"e	20' 7"	17' 10"	14' 2"	18' 6"	16' 9"	14' 7"e	20' 7"	17' 10"	14' 2"
800S300-68	50	21' 6"	19' 6"	17' 1"	24' 2"	21' 0"	17' 1"	20' 1"	18' 2"	15' 10"	22' 6"	20' 6"	17' 1"
800S300-97	50	24' 2"	22' 0"	19' 2"	27' 10"	25' 4"	21' 9"	22' 7"	20' 6"	18' 0"	25' 4"	23' 1"	20' 2"
800S300-118	50	25' 10"	23' 6"	20' 6"	29' 9"	27' 1"	23' 8"	24' 1"	21' 10"	19' 2"	27' 1"	24' 7"	21' 6"
1000S162-33	33	10' 7"e	7' 10"e	5' 3"e	8' 0"e	6' 1"e	4' 2"e	10' 7"e	7' 10"e	5' 3"e	8' 0"e	6' 1"e	4' 2"e
1000S162-43	33	15' 4"e	13' 4"e	10' 10"e	13' 9"e	11' 3"e	8' 2"e	15' 4"e	13' 4"e	10' 10"e	13' 9"e	11' 3"e	8' 2"e
1000S162-54	50	20' 7"	17' 10"	14' 7"e	20' 9"	17' 4"	13' 4"	19' 8"	17' 10"	14' 7"e	20' 9"	17' 4"	13' 4"
1000S162-68	50	22' 10"	20' 9"	17' 2"	24' 3"	21' 1"	17' 2"	21' 4"	19' 4"	17' 0"	24' 0"	21' 1"	17' 2"
1000S162-97	50	25' 9"	23' 4"	20' 6"	29' 8"	26' 10"	22' 0"	24' 0"	21' 9"	19' 1"	27' 0"	24' 6"	21' 4"
1000S162-118	50	27' 3"	24' 9"	21' 8"	31' 6"	28' 7"	25' 0"	25' 6"	23' 1"	20' 2"	28' 7"	26' 0"	22' 8"
1000S200-43	33	16' 8"e	14' 6"e	11' 8"e	14' 3"e	11' 7"e	8' 4"e	16' 8"e	14' 6"e	11' 8"e	14' 3"e	11' 7"e	8' 4"e
1000S200-54	50	22' 1"	19' 3"e	15' 8"e	21' 4"	18' 0"	13' 9"	20' 7"	18' 8"e	15' 8"e	21' 4"	18' 0"	13' 9"
1000S200-68	50	23' 10"	21' 8"	18' 6"e	26' 1"	22' 7"	18' 6"	22' 3"	20' 3"	17' 8"	25' 1"	22' 7"	18' 6"
1000S200-97	50	26' 10"	24' 6"	21' 4"	31' 0"	28' 2"	23' 6"	25' 1"	22' 9"	19' 10"	28' 2"	25' 7"	22' 4"
1000S200-118	50	28' 6"	25' 10"	22' 8"	32' 10"	29' 10"	26' 1"	26' 7"	24' 2"	21' 1"	29' 10"	27' 2"	23' 8"
1000S250-43	33	17' 1"e	14' 9"e	11' 8"e	14' 8"e	11' 10"e	8' 6"e	17' 1"e	14' 9"e	11' 8"e	14' 8"e	11' 10"e	8' 6"e
1000S250-54	50	22' 10"	19' 9"e	16' 2"e	22' 3"	18' 7"	14' 2"	21' 6"	19' 7"e	16' 2"e	22' 3"	18' 7"	14' 2"
1000S250-68	50	25' 0"	22' 8"	19' 0"e	26' 10"	23' 3"	19' 0"	23' 4"	21' 2"	18' 6"e	26' 2"	23' 3"	19' 0"
1000S250-97	50	28' 0"	25' 6"	22' 2"	32' 3"	29' 4"	24' 2"	26' 2"	23' 9"	20' 9"	29' 4"	26' 8"	23' 3"
1000S250-118	50	29' 8"	27' 0"	23' 7"	34' 3"	31' 2"	27' 2"	27' 9"	25' 2"	22' 0"	31' 2"	28' 3"	24' 8"
1000S300-54	50	23' 1"	20' 0"e	16' 3"e	22' 4"	18' 8"	14' 2"	21' 10"	19' 10"e	16' 3"e	22' 4"	18' 8"	14' 2"
1000S300-68	50	25' 7"	23' 3"	19' 3"e	27' 3"	23' 8"	19' 3"	23' 10"	21' 8"	19' 0"e	26' 9"	23' 8"	19' 3"
1000S300-97	50	28' 10"	26' 2"	22' 10"	33' 3"	30' 3"	24' 8"	27' 0"	24' 6"	21' 4"	30' 3"	27' 6"	24' 0"
1000S300-118	50	30' 9"	28' 0"	24' 6"	35' 7"	32' 3"	28' 2"	28' 9"	26' 2"	22' 9"	32' 3"	29' 4"	25' 7"
1000S350-54	50	24' 9"e	22' 0"e	17' 10"e	24' 1"	20' 0"	15' 0"	23' 1"	21' 0"e	17' 10"e	24' 1"	20' 0"	15' 0"
1000S350-68	50	27' 1"	24' 7"	21' 2"e	30' 0"	26' 0"	21' 2"	25' 3"	23' 0"	20' 1"e	28' 4"	25' 9"	21' 2"
1000S350-97	50	30' 6"	27' 8"	24' 2"	35' 2"	32' 0"	27' 2"	28' 6"	25' 10"	22' 7"	32' 0"	29' 0"	25' 4"
1000S350-118	50	32' 4"	29' 6"	25' 8"	37' 4"	34' 0"	29' 8"	30' 2"	27' 6"	24' 0"	34' 0"	30' 9"	26' 10"

BAILEY MAXIMUM FLOOR JOIST SPANS (ft)

Joist Member	F _y (ksi)	25 psf Dead Load 40 psf Live Load											
		TL Deflection = L/240, LL Deflection = L/360						TL Deflection = L/240, LL Deflection = L/480					
		SINGLE SPAN			TWO EQUAL SPANS			SINGLE SPAN			TWO EQUAL SPANS		
		Joist Spacing (in.) o.c.			Joist Spacing (in.) o.c.			Joist Spacing (in.) o.c.			Joist Spacing (in.) o.c.		
		12	16	24	12	16	24	12	16	24	12	16	24
1200S162-43	33	16' 7"	14' 4"	9' 8"	13' 3"	10' 6"	7' 4"	16' 7"	14' 4"	9' 8"	13' 3"	10' 6"	7' 4"
1200S162-54	50	22' 2"	19' 3"	15' 8"	21' 3"	17' 7"	13' 0"	22' 2"	19' 3"	15' 8"	21' 3"	17' 7"	13' 0"
1200S162-68	50	26' 4"	22' 9"	18' 8"	26' 4"	22' 9"	18' 8"	24' 7"	22' 4"	18' 8"	26' 4"	22' 9"	18' 8"
1200S162-97	50	29' 10"	27' 2"	23' 9"	34' 1"	29' 6"	24' 1"	27' 10"	25' 4"	22' 2"	31' 4"	28' 6"	24' 1"
1200S162-118	50	31' 10"	29' 0"	25' 3"	36' 9"	33' 4"	27' 8"	29' 9"	27' 0"	23' 7"	33' 4"	30' 3"	26' 6"
1200S200-54	50	24' 1"	20' 10"	17' 1"	21' 10"	18' 0"	13' 2"	23' 7"	20' 10"	17' 1"	21' 10"	18' 0"	13' 2"
1200S200-68	50	27' 6"	24' 8"	20' 2"	28' 6"	24' 8"	19' 6"	25' 8"	23' 3"	20' 2"	28' 6"	24' 8"	19' 6"
1200S200-97	50	31' 2"	28' 3"	24' 9"	36' 0"	31' 8"	25' 10"	29' 1"	26' 4"	23' 1"	32' 8"	29' 8"	25' 10"
1200S200-118	50	33' 2"	30' 2"	26' 4"	38' 3"	34' 9"	29' 8"	31' 0"	28' 2"	24' 7"	34' 9"	31' 7"	27' 7"
1200S250-54	50	24' 10"	21' 7"	17' 7"	22' 2"	18' 2"	13' 3"	24' 2"	21' 7"	17' 7"	22' 2"	18' 2"	13' 3"
1200S250-68	50	28' 6"	25' 6"	20' 9"	29' 6"	25' 0"	19' 7"	26' 7"	24' 1"	20' 9"	29' 6"	25' 0"	19' 7"
1200S250-97	50	32' 4"	29' 4"	25' 8"	37' 3"	32' 9"	26' 9"	30' 2"	27' 6"	24' 0"	33' 10"	30' 9"	26' 9"
1200S250-118	50	34' 6"	31' 3"	27' 4"	39' 9"	36' 1"	30' 8"	32' 2"	29' 3"	25' 7"	36' 1"	32' 9"	28' 8"
1200S300-54	50	25' 2"	21' 9"	17' 9"	22' 7"	18' 4"	13' 6"	24' 10"	21' 9"	17' 9"	22' 7"	18' 4"	13' 6"
1200S300-68	50	29' 7"	26' 0"	21' 2"	30' 0"	26' 0"	20' 3"	27' 7"	25' 1"	21' 2"	30' 0"	26' 0"	20' 3"
1200S300-97	50	33' 4"	30' 4"	26' 6"	38' 6"	33' 6"	27' 3"	31' 2"	28' 3"	24' 8"	35' 0"	31' 9"	27' 3"
1200S300-118	50	35' 8"	32' 4"	28' 3"	41' 2"	37' 4"	31' 4"	33' 3"	30' 3"	26' 4"	37' 4"	34' 0"	29' 8"
1200S350-54	50	27' 4"	23' 8"	19' 3"	24' 0"	19' 4"	14' 0"	26' 3"	23' 8"	19' 3"	24' 0"	19' 4"	14' 0"
1200S350-68	50	31' 3"	28' 3"	23' 1"	32' 8"	28' 2"	21' 9"	29' 2"	26' 6"	23' 1"	32' 8"	28' 2"	21' 9"
1200S350-97	50	35' 2"	32' 0"	27' 10"	40' 7"	36' 8"	29' 10"	32' 10"	29' 9"	26' 1"	36' 10"	33' 6"	29' 3"
1200S350-118	50	37' 4"	34' 0"	29' 8"	43' 2"	39' 2"	34' 2"	34' 10"	31' 8"	27' 8"	39' 2"	35' 7"	31' 1"
1400S162-54	50	23' 6"	20' 3"	16' 6"	21' 1"	17' 0"	12' 1"	23' 6"	20' 3"	16' 6"	21' 1"	17' 0"	12' 1"
1400S162-68	50	28' 0"	24' 3"	19' 9"	28' 0"	24' 3"	19' 0"	27' 9"	24' 3"	19' 9"	28' 0"	24' 3"	19' 0"
1400S162-97	50	33' 10"	30' 9"	25' 9"	36' 6"	31' 8"	25' 9"	31' 7"	28' 8"	25' 1"	35' 6"	31' 8"	25' 9"
1400S162-118	50	36' 3"	33' 0"	28' 9"	41' 10"	36' 7"	29' 10"	33' 10"	30' 9"	26' 10"	38' 1"	34' 7"	29' 10"
1400S200-54	50	25' 8"	22' 2"	16' 6"	21' 6"	17' 2"	12' 2"	25' 8"	22' 2"	16' 6"	21' 6"	17' 2"	12' 2"
1400S200-68	50	30' 4"	26' 4"	21' 6"	30' 4"	25' 8"	19' 8"	28' 10"	26' 3"	21' 6"	30' 4"	25' 8"	19' 8"
1400S200-97	50	35' 2"	32' 0"	27' 10"	39' 4"	34' 2"	27' 10"	32' 10"	29' 10"	26' 1"	36' 10"	33' 6"	27' 10"
1400S200-118	50	37' 8"	34' 3"	30' 0"	43' 6"	39' 4"	32' 1"	35' 2"	32' 0"	28' 0"	39' 6"	35' 10"	31' 4"
1400S250-54	50	26' 6"	22' 10"	16' 6"	21' 8"	17' 3"	12' 3"	26' 6"	22' 10"	16' 6"	21' 8"	17' 3"	12' 3"
1400S250-68	50	31' 7"	27' 4"	22' 4"	30' 9"	25' 9"	19' 8"	29' 10"	27' 1"	22' 4"	30' 9"	25' 9"	19' 8"
1400S250-97	50	36' 6"	33' 2"	28' 10"	40' 10"	35' 6"	28' 10"	34' 1"	31' 0"	27' 0"	38' 3"	34' 9"	28' 10"
1400S250-118	50	39' 1"	35' 6"	31' 0"	45' 1"	40' 10"	33' 4"	36' 6"	33' 2"	29' 0"	41' 0"	37' 2"	32' 6"
1400S300-54	50	26' 9"	23' 2"	16' 6"	21' 9"	17' 4"	12' 3"	26' 9"	23' 2"	16' 6"	21' 9"	17' 4"	12' 3"
1400S300-68	50	32' 2"	27' 10"	22' 9"	31' 2"	26' 1"	19' 10"	30' 4"	27' 7"	22' 9"	31' 2"	26' 1"	19' 10"
1400S300-97	50	37' 6"	34' 1"	29' 7"	41' 10"	36' 3"	29' 7"	35' 0"	31' 9"	27' 9"	39' 3"	35' 8"	29' 7"
1400S300-118	50	40' 4"	36' 8"	32' 0"	46' 7"	41' 10"	34' 2"	37' 8"	34' 2"	29' 10"	42' 3"	38' 4"	33' 7"
1400S350-54	50	29' 0"	24' 9"	16' 6"	23' 0"	18' 1"	12' 7"	29' 0"	24' 9"	16' 6"	23' 0"	18' 1"	12' 7"
1400S350-68	50	34' 9"	30' 1"	24' 7"	34' 4"	28' 6"	21' 4"	32' 9"	29' 9"	24' 7"	34' 4"	28' 6"	21' 4"
1400S350-97	50	39' 9"	36' 2"	31' 7"	45' 7"	39' 6"	32' 3"	37' 1"	33' 8"	29' 6"	41' 8"	37' 10"	32' 3"
1400S350-118	50	42' 3"	38' 6"	33' 7"	48' 9"	44' 3"	37' 3"	39' 6"	35' 10"	31' 3"	44' 3"	40' 3"	35' 2"
1600S162-68	50	29' 4"	25' 4"	20' 9"	29' 4"	24' 10"	18' 8"	29' 4"	25' 4"	20' 9"	29' 4"	24' 10"	18' 8"
1600S162-97	50	37' 8"	33' 4"	27' 3"	38' 7"	33' 4"	27' 3"	35' 2"	32' 0"	27' 3"	38' 7"	33' 4"	27' 3"
1600S162-118	50	40' 6"	36' 9"	31' 8"	44' 9"	38' 9"	31' 8"	37' 9"	34' 4"	30' 0"	42' 6"	38' 7"	31' 8"
1600S200-68	50	32' 0"	27' 8"	22' 8"	31' 3"	25' 9"	19' 2"	32' 0"	27' 8"	22' 8"	31' 3"	25' 9"	19' 2"
1600S200-97	50	39' 1"	35' 7"	29' 7"	41' 9"	36' 2"	29' 7"	36' 6"	33' 2"	29' 0"	41' 0"	36' 2"	29' 7"
1600S200-118	50	42' 0"	38' 2"	33' 4"	48' 4"	41' 10"	34' 2"	39' 2"	35' 7"	31' 1"	44' 0"	40' 0"	34' 2"
1600S250-68	50	33' 4"	28' 10"	23' 7"	31' 4"	25' 10"	19' 3"	33' 0"	28' 10"	23' 7"	31' 4"	25' 10"	19' 3"
1600S250-97	50	40' 6"	36' 9"	30' 9"	43' 7"	37' 8"	30' 9"	37' 9"	34' 3"	30' 0"	42' 4"	37' 8"	30' 9"
1600S250-118	50	43' 6"	39' 6"	34' 6"	50' 1"	43' 8"	35' 8"	40' 7"	36' 10"	32' 2"	45' 6"	41' 4"	35' 8"
1600S300-68	50	34' 0"	29' 6"	24' 1"	31' 8"	26' 1"	19' 4"	33' 7"	29' 6"	24' 1"	31' 8"	26' 1"	19' 4"
1600S300-97	50	41' 6"	37' 8"	31' 8"	44' 9"	38' 9"	31' 8"	38' 9"	35' 2"	30' 9"	43' 6"	38' 9"	31' 8"
1600S300-118	50	44' 9"	40' 8"	35' 7"	51' 8"	44' 10"	36' 8"	41' 9"	38' 0"	33' 2"	47' 0"	42' 8"	36' 8"
1600S350-68	50	36' 6"	31' 7"	25' 9"	34' 0"	27' 8"	20' 3"	35' 7"	31' 7"	25' 9"	34' 0"	27' 8"	20' 3"
1600S350-97	50	43' 8"	39' 8"	34' 2"	48' 4"	41' 10"	34' 2"	40' 9"	37' 1"	32' 4"	45' 9"	41' 7"	34' 2"
1600S350-118	50	46' 10"	42' 7"	37' 2"	54' 0"	48' 9"	39' 10"	43' 8"	39' 8"	34' 8"	49' 1"	44' 7"	39' 0"

GENERAL NOTES:

- Spans are based on continuous lateral support of the compression flange over the full joist length.
- Tension flange must be laterally braced at a maximum spacing of 8'-0".
- Joists must be braced against rotation at all supports.
- Distortional buckling calculations are based on $K\phi = 0$.
- For two equal spans, the listed span is the distance from either end to the continuous centre support.
- End web crippling check is based on 3.5" end bearing. Where listed spans are followed by "e", web stiffeners are required at end supports.
- Web stiffeners are required at interior supports.
- Total load (TL) deflection is based on L/240 and live load (LL) deflection is based on either L/360 or L/480.

BAILEY MAXIMUM FLOOR JOIST SPANS (ft)

Joist Member	F _y (ksi)	35 psf Dead Load 40 psf Live Load											
		TL Deflection = L/240, LL Deflection = L/360						TL Deflection = L/240, LL Deflection = L/480					
		SINGLE SPAN			TWO EQUAL SPANS			SINGLE SPAN			TWO EQUAL SPANS		
		Joist Spacing (in.) o.c.			Joist Spacing (in.) o.c.			Joist Spacing (in.) o.c.			Joist Spacing (in.) o.c.		
		12	16	24	12	16	24	12	16	24	12	16	24
600S162-33	33	9' 4"e	8' 1"e	6' 7"e	8' 10"e	7' 3"e	5' 4"e	9' 4"e	8' 1"e	6' 7"e	8' 10"e	7' 3"e	5' 4"e
600S162-43	33	11' 2"e	9' 8"e	7' 10"e	11' 2"	9' 8"	7' 10"e	11' 2"e	9' 8"e	7' 10"e	11' 2"	9' 8"	7' 10"e
600S162-54	50	13' 7"	12' 3"	10' 6"	14' 10"	12' 10"	10' 6"	13' 3"	12' 1"	10' 6"	14' 10"	12' 10"	10' 6"
600S162-68	50	14' 7"	13' 2"	11' 6"	17' 3"	15' 0"	12' 2"	14' 2"	12' 10"	11' 3"	16' 0"	14' 6"	12' 2"
600S162-97	50	16' 1"	14' 8"	12' 9"	19' 4"	17' 7"	15' 1"	15' 9"	14' 3"	12' 6"	17' 8"	16' 1"	14' 1"
600S162-118	50	17' 0"	15' 6"	13' 6"	20' 6"	18' 7"	16' 3"	16' 8"	15' 1"	13' 2"	18' 8"	17' 0"	14' 10"
600S200-33	33	10' 0"e	8' 8"e	7' 1"e	9' 1"e	7' 4"e	5' 4"e	10' 0"e	8' 8"e	7' 1"e	9' 1"e	7' 4"e	5' 4"e
600S200-43	33	12' 0"e	10' 4"e	8' 6"e	12' 0"	10' 2"e	8' 0"e	12' 0"e	10' 4"e	8' 6"e	12' 0"	10' 2"e	8' 0"e
600S200-54	50	14' 3"	13' 0"	11' 3"	15' 10"	13' 9"	11' 0"	14' 0"	12' 8"	11' 1"	15' 8"	13' 9"	11' 0"
600S200-68	50	15' 3"	13' 10"	12' 1"	18' 4"	16' 0"	13' 1"	15' 0"	13' 7"	11' 10"	16' 9"	15' 3"	13' 1"
600S200-97	50	17' 0"	15' 4"	13' 6"	20' 6"	18' 7"	16' 2"	16' 7"	15' 1"	13' 2"	18' 8"	17' 0"	14' 9"
600S200-118	50	18' 0"	16' 3"	14' 3"	21' 7"	19' 8"	17' 2"	17' 7"	16' 0"	14' 0"	19' 8"	17' 10"	15' 8"
600S250-43	33	12' 3"e	10' 8"e	8' 8"e	12' 3"	10' 4"e	8' 1"e	12' 3"e	10' 8"e	8' 8"e	12' 3"	10' 4"e	8' 1"e
600S250-54	50	14' 8"	13' 4"	11' 6"e	16' 3"	14' 1"	11' 2"	14' 4"	13' 1"	11' 4"	16' 2"	14' 1"	11' 2"
600S250-68	50	16' 0"	14' 6"	12' 8"	19' 0"	16' 6"	13' 3"	15' 7"	14' 2"	12' 4"	17' 7"	15' 10"	13' 3"
600S250-97	50	17' 9"	16' 2"	14' 2"	21' 6"	19' 6"	16' 10"	17' 6"	15' 10"	13' 10"	19' 7"	17' 9"	15' 7"
600S250-118	50	18' 10"	17' 2"	15' 0"	22' 8"	20' 8"	18' 1"	18' 6"	16' 9"	14' 8"	20' 9"	18' 10"	16' 6"
600S300-54	50	15' 1"	13' 8"	11' 8"e	16' 7"	14' 4"	11' 4"	14' 9"	13' 4"	11' 8"e	16' 7"	14' 4"	11' 4"
600S300-68	50	16' 4"	14' 10"	13' 0"	19' 4"	16' 9"	13' 7"	16' 1"	14' 7"	12' 9"	18' 0"	16' 4"	13' 7"
600S300-97	50	18' 6"	16' 9"	14' 8"	22' 3"	20' 2"	17' 0"	18' 1"	16' 6"	14' 4"	20' 3"	18' 6"	16' 1"
600S300-118	50	19' 8"	17' 10"	15' 8"	23' 9"	21' 7"	18' 10"	19' 3"	17' 6"	15' 3"	21' 8"	19' 8"	17' 2"
800S162-33	33	10' 9"e	8' 9"e	5' 9"e	8' 2"e	6' 4"e	4' 6"e	10' 9"e	8' 9"e	5' 9"e	8' 2"e	6' 4"e	4' 6"e
800S162-43	33	13' 0"e	11' 3"e	9' 2"e	12' 6"	10' 4"e	7' 10"e	13' 0"e	11' 3"e	9' 2"e	12' 6"	10' 4"e	7' 10"e
800S162-54	50	16' 10"	15' 1"	12' 3"e	17' 4"	15' 1"	12' 0"	16' 7"	15' 1"	12' 3"e	17' 4"	15' 1"	12' 0"
800S162-68	50	18' 3"	16' 8"	14' 4"	20' 4"	17' 7"	14' 4"	17' 10"	16' 3"	14' 2"	20' 1"	17' 7"	14' 4"
800S162-97	50	20' 4"	18' 6"	16' 2"	24' 7"	22' 3"	18' 2"	20' 0"	18' 1"	15' 9"	22' 4"	20' 4"	17' 9"
800S162-118	50	21' 7"	19' 7"	17' 1"	26' 0"	23' 7"	20' 7"	21' 1"	19' 2"	16' 9"	23' 8"	21' 6"	18' 9"
800S200-43	33	14' 0"e	12' 1"e	9' 10"e	13' 7"e	11' 3"e	8' 6"e	14' 0"e	12' 1"e	9' 10"e	13' 7"e	11' 3"e	8' 6"e
800S200-54	50	17' 10"	16' 2"	13' 2"e	18' 7"	16' 2"	13' 0"	17' 6"	15' 10"	13' 2"e	18' 7"	16' 2"	13' 0"
800S200-68	50	19' 2"	17' 6"	15' 3"	21' 9"	18' 10"	15' 4"	18' 9"	17' 1"	14' 10"	21' 1"	18' 10"	15' 4"
800S200-97	50	21' 4"	19' 4"	17' 0"	25' 9"	23' 4"	19' 4"	20' 10"	19' 0"	16' 7"	23' 6"	21' 4"	18' 8"
800S200-118	50	22' 8"	20' 7"	18' 0"	27' 3"	24' 9"	21' 8"	22' 2"	20' 2"	17' 7"	24' 10"	22' 7"	19' 9"
800S250-43	33	14' 3"e	12' 4"e	10' 1"e	13' 8"e	11' 3"e	8' 6"e	14' 3"e	12' 4"e	10' 1"e	13' 8"e	11' 3"e	8' 6"e
800S250-54	50	18' 4"	16' 6"	13' 6"e	19' 1"	16' 6"	13' 1"	18' 0"	16' 4"	13' 6"e	19' 1"	16' 6"	13' 1"
800S250-68	50	20' 0"	18' 2"	15' 9"	22' 4"	19' 4"	15' 9"	19' 7"	17' 9"	15' 6"	22' 0"	19' 4"	15' 9"
800S250-97	50	22' 4"	20' 3"	17' 8"	26' 10"	24' 6"	20' 0"	21' 10"	19' 10"	17' 4"	24' 7"	22' 3"	19' 6"
800S250-118	50	23' 8"	21' 6"	18' 9"	28' 6"	25' 10"	22' 8"	23' 2"	21' 1"	18' 4"	26' 0"	23' 8"	20' 8"
800S300-54	50	18' 10"	16' 9"e	13' 8"e	19' 4"	16' 8"	13' 1"	18' 6"	16' 9"e	13' 8"e	19' 4"	16' 8"	13' 1"
800S300-68	50	20' 6"	18' 7"	16' 1"	22' 8"	19' 8"	16' 1"	20' 1"	18' 2"	15' 10"	22' 6"	19' 8"	16' 1"
800S300-97	50	23' 1"	21' 0"	18' 3"	27' 9"	25' 0"	20' 4"	22' 7"	20' 6"	18' 0"	25' 4"	23' 1"	20' 2"
800S300-118	50	24' 8"	22' 4"	19' 7"	29' 8"	27' 0"	23' 3"	24' 1"	21' 10"	19' 2"	27' 1"	24' 7"	21' 6"
1000S162-33	33	9' 3"e	7' 0"e	4' 8"e	7' 1"e	5' 4"e	3' 8"e	9' 3"e	7' 0"e	4' 8"e	7' 1"e	5' 4"e	3' 8"e
1000S162-43	33	14' 6"e	12' 6"e	10' 2"e	12' 7"e	10' 2"e	7' 4"e	14' 6"e	12' 6"e	10' 2"e	12' 7"e	10' 2"e	7' 4"e
1000S162-54	50	19' 3"	16' 9"e	13' 8"e	19' 2"	16' 1"	12' 3"	19' 3"	16' 9"e	13' 8"e	19' 2"	16' 1"	12' 3"
1000S162-68	50	21' 9"	19' 9"	16' 1"	22' 9"	19' 9"	16' 1"	21' 4"	19' 4"	16' 1"	22' 9"	19' 9"	16' 1"
1000S162-97	50	24' 7"	22' 3"	19' 6"	29' 2"	25' 3"	20' 7"	24' 0"	21' 9"	19' 1"	27' 0"	24' 6"	20' 7"
1000S162-118	50	26' 0"	23' 7"	20' 8"	31' 3"	28' 6"	23' 6"	25' 6"	23' 1"	20' 2"	28' 7"	26' 0"	22' 8"
1000S200-43	33	15' 8"e	13' 7"e	10' 3"e	13' 1"e	10' 6"e	7' 6"e	15' 8"e	13' 7"e	10' 3"e	13' 1"e	10' 6"e	7' 6"e
1000S200-54	50	20' 10"	18' 1"e	14' 9"e	19' 9"	16' 6"	12' 7"	20' 7"	18' 1"e	14' 9"e	19' 9"	16' 6"	12' 7"
1000S200-68	50	22' 9"	20' 8"	17' 3"e	24' 6"	21' 2"	17' 3"	22' 3"	20' 3"	17' 3"e	24' 6"	21' 2"	17' 3"
1000S200-97	50	25' 8"	23' 3"	20' 4"	30' 10"	27' 0"	22' 1"	25' 1"	22' 9"	19' 10"	28' 2"	25' 7"	22' 1"
1000S200-118	50	27' 2"	24' 8"	21' 7"	32' 9"	29' 9"	25' 1"	26' 7"	24' 2"	21' 1"	29' 10"	27' 2"	23' 8"
1000S250-43	33	16' 0"e	13' 10"e	10' 3"e	13' 4"e	10' 8"e	7' 7"e	16' 0"e	13' 10"e	10' 3"e	13' 4"e	10' 8"e	7' 7"e
1000S250-54	50	21' 4"e	18' 7"e	15' 2"e	20' 7"	17' 1"	12' 10"	21' 4"e	18' 7"e	15' 2"e	20' 7"	17' 1"	12' 10"
1000S250-68	50	23' 10"	21' 8"	17' 9"e	25' 2"	21' 9"	17' 9"	23' 4"	21' 2"	17' 9"e	25' 2"	21' 9"	17' 9"
1000S250-97	50	26' 8"	24' 3"	21' 2"	32' 2"	27' 10"	22' 8"	26' 2"	23' 9"	20' 9"	29' 4"	26' 8"	22' 8"
1000S250-118	50	28' 4"	25' 9"	22' 6"	34' 1"	31' 0"	26' 0"	27' 9"	25' 2"	22' 0"	31' 2"	28' 3"	24' 8"
1000S300-54	50	21' 8"e	18' 9"e	15' 3"e	20' 8"	17' 2"	13' 0"	21' 8"e	18' 9"e	15' 3"e	20' 8"	17' 2"	13' 0"
1000S300-68	50	24' 4"	22' 2"	18' 1"e	25' 7"	22' 2"	18' 1"	23' 10"	21' 8"	18' 1"e	25' 7"	22' 2"	18' 1"
1000S300-97	50	27' 6"	25' 0"	21' 10"	32' 9"	28' 4"	23' 2"	27' 0"	24' 6"	21' 4"	30' 3"	27' 6"	23' 2"
1000S300-118	50	29' 4"	26' 8"	23' 3"	35' 4"	32' 2"	26' 7"	28' 9"	26' 2"	22' 9"	32' 3"	29' 4"	25' 7"
1000S350-54	50	23' 7"e	20' 7"e	16' 9"e	22' 2"	18' 3"	13' 7"	23' 1"e	20' 7"e	16' 9"e	22' 2"	18' 3"	13' 7"
1000S350-68	50	25' 9"	23' 6"	19' 10"e	28' 1"	24' 4"	19' 10"	25' 3"	23' 0"	19' 10"e	28' 1"	24' 4"	19' 10"
1000S350-97	50	29' 1"	26' 4"	23' 1"	35' 0"	31' 2"	25' 6"	28' 6"	25' 10"	22' 7"	32' 0"	29' 0"	25' 4"
1000S350-118	50	30' 10"	28' 1"	24' 6"	37' 2"	33' 9"	29' 2"	30' 2"	27' 6"	24' 0"	34' 0"	30' 9"	26' 10"

BAILEY MAXIMUM FLOOR JOIST SPANS (ft)

Joist Member	F _y (ksi)	35 psf Dead Load 40 psf Live Load											
		TL Deflection = L/240, LL Deflection = L/360						TL Deflection = L/240, LL Deflection = L/480					
		SINGLE SPAN			TWO EQUAL SPANS			SINGLE SPAN			TWO EQUAL SPANS		
		Joist Spacing (in.) o.c.			Joist Spacing (in.) o.c.			Joist Spacing (in.) o.c.			Joist Spacing (in.) o.c.		
		12	16	24	12	16	24	12	16	24	12	16	24
1200S162-43	33	15' 7"	12' 9"	8' 7"	12' 0"	9' 4"	6' 7"	15' 7"	12' 9"	8' 7"	12' 0"	9' 4"	6' 7"
1200S162-54	50	20' 9"	18' 1"	14' 8"	19' 7"	16' 0"	11' 9"	20' 9"	18' 1"	14' 8"	19' 7"	16' 0"	11' 9"
1200S162-68	50	24' 8"	21' 4"	17' 6"	24' 8"	21' 4"	17' 2"	24' 7"	21' 4"	17' 6"	24' 8"	21' 4"	17' 2"
1200S162-97	50	28' 6"	25' 10"	22' 7"	32' 0"	27' 8"	22' 7"	27' 10"	25' 4"	22' 2"	31' 4"	27' 8"	22' 7"
1200S162-118	50	30' 4"	27' 7"	24' 1"	36' 7"	31' 9"	26' 0"	29' 9"	27' 0"	23' 7"	33' 4"	30' 3"	26' 0"
1200S200-54	50	22' 7"	19' 7"	16' 0"	20' 1"	16' 4"	11' 10"	22' 7"	19' 7"	16' 0"	20' 1"	16' 4"	11' 10"
1200S200-68	50	26' 3"	23' 2"	18' 10"	26' 8"	23' 1"	18' 0"	25' 8"	23' 2"	18' 10"	26' 8"	23' 1"	18' 0"
1200S200-97	50	29' 8"	27' 0"	23' 7"	34' 4"	29' 9"	24' 3"	29' 1"	26' 4"	23' 1"	32' 8"	29' 8"	24' 3"
1200S200-118	50	31' 8"	28' 9"	25' 1"	38' 1"	34' 1"	27' 9"	31' 0"	28' 2"	24' 7"	34' 9"	31' 7"	27' 7"
1200S250-54	50	23' 3"	20' 2"	16' 6"	20' 3"	16' 6"	12' 0"	23' 3"	20' 2"	16' 6"	20' 3"	16' 6"	12' 0"
1200S250-68	50	27' 2"	23' 10"	19' 6"	27' 4"	23' 2"	18' 1"	26' 7"	23' 10"	19' 6"	27' 4"	23' 2"	18' 1"
1200S250-97	50	30' 10"	28' 1"	24' 6"	35' 6"	30' 9"	25' 1"	30' 2"	27' 6"	24' 0"	33' 10"	30' 9"	25' 1"
1200S250-118	50	32' 10"	29' 10"	26' 1"	39' 7"	35' 3"	28' 9"	32' 2"	29' 3"	25' 7"	36' 1"	32' 9"	28' 8"
1200S300-54	50	23' 7"	20' 4"	16' 8"	20' 8"	16' 9"	12' 1"	23' 7"	20' 4"	16' 8"	20' 8"	16' 9"	12' 1"
1200S300-68	50	28' 2"	24' 4"	19' 10"	28' 2"	24' 1"	18' 8"	27' 7"	24' 4"	19' 10"	28' 2"	24' 1"	18' 8"
1200S300-97	50	31' 10"	28' 10"	25' 3"	36' 3"	31' 4"	25' 7"	31' 2"	28' 3"	24' 8"	35' 0"	31' 4"	25' 7"
1200S300-118	50	34' 0"	30' 10"	27' 0"	41' 0"	36' 1"	29' 6"	33' 3"	30' 3"	26' 4"	37' 4"	34' 0"	29' 6"
1200S350-54	50	25' 8"	22' 3"	17' 0"	21' 10"	17' 6"	12' 6"	25' 8"	22' 3"	17' 0"	21' 10"	17' 6"	12' 6"
1200S350-68	50	29' 9"	26' 6"	21' 8"	30' 7"	26' 1"	20' 0"	29' 2"	26' 6"	21' 8"	30' 7"	26' 1"	20' 0"
1200S350-97	50	33' 7"	30' 6"	26' 7"	39' 8"	34' 4"	28' 1"	32' 10"	29' 9"	26' 1"	36' 10"	33' 6"	28' 1"
1200S350-118	50	35' 8"	32' 4"	28' 3"	43' 0"	39' 0"	32' 3"	34' 10"	31' 8"	27' 8"	39' 2"	35' 7"	31' 1"
1400S162-54	50	22' 0"	19' 1"	14' 6"	19' 2"	15' 3"	10' 9"	22' 0"	19' 1"	14' 6"	19' 2"	15' 3"	10' 9"
1400S162-68	50	26' 3"	22' 9"	18' 7"	26' 3"	22' 8"	17' 4"	26' 3"	22' 9"	18' 7"	26' 3"	22' 8"	17' 4"
1400S162-97	50	32' 3"	29' 4"	24' 2"	34' 3"	29' 8"	24' 2"	31' 7"	28' 8"	24' 2"	34' 3"	29' 8"	24' 2"
1400S162-118	50	34' 7"	31' 6"	27' 6"	39' 7"	34' 3"	28' 0"	33' 10"	30' 9"	26' 10"	38' 1"	34' 3"	28' 0"
1400S200-54	50	24' 1"	20' 9"	14' 6"	19' 6"	15' 6"	10' 10"	24' 1"	20' 9"	14' 6"	19' 6"	15' 6"	10' 10"
1400S200-68	50	28' 7"	24' 8"	20' 2"	28' 4"	23' 8"	18' 0"	28' 7"	24' 8"	20' 2"	28' 4"	23' 8"	18' 0"
1400S200-97	50	33' 7"	30' 6"	26' 2"	37' 0"	32' 0"	26' 2"	32' 10"	29' 10"	26' 1"	36' 10"	32' 0"	26' 2"
1400S200-118	50	36' 0"	32' 8"	28' 7"	42' 7"	36' 10"	30' 1"	35' 2"	32' 0"	28' 0"	39' 6"	35' 10"	30' 1"
1400S250-54	50	24' 9"	21' 6"	14' 6"	19' 8"	15' 7"	11' 0"	24' 9"	21' 6"	14' 6"	19' 8"	15' 7"	11' 0"
1400S250-68	50	29' 8"	25' 8"	21' 0"	28' 6"	23' 9"	18' 0"	29' 8"	25' 8"	21' 0"	28' 6"	23' 9"	18' 0"
1400S250-97	50	34' 9"	31' 7"	27' 1"	38' 4"	33' 2"	27' 1"	34' 1"	31' 0"	27' 0"	38' 3"	33' 2"	27' 1"
1400S250-118	50	37' 3"	33' 10"	29' 7"	44' 3"	38' 3"	31' 3"	36' 6"	33' 2"	29' 0"	41' 0"	37' 2"	31' 3"
1400S300-54	50	25' 1"	21' 9"	14' 6"	19' 9"	15' 8"	11' 0"	25' 1"	21' 9"	14' 6"	19' 9"	15' 8"	11' 0"
1400S300-68	50	30' 2"	26' 2"	21' 4"	28' 9"	24' 0"	18' 2"	30' 2"	26' 2"	21' 4"	28' 9"	24' 0"	18' 2"
1400S300-97	50	35' 8"	32' 6"	27' 9"	39' 3"	34' 0"	27' 9"	35' 0"	31' 9"	27' 9"	39' 3"	34' 0"	27' 9"
1400S300-118	50	38' 6"	35' 0"	30' 7"	45' 4"	39' 3"	32' 1"	37' 8"	34' 2"	29' 10"	42' 3"	38' 4"	32' 1"
1400S350-54	50	27' 2"	21' 9"	14' 6"	20' 8"	16' 2"	11' 2"	27' 2"	21' 9"	14' 6"	20' 8"	16' 2"	11' 2"
1400S350-68	50	32' 7"	28' 3"	23' 1"	31' 7"	26' 1"	19' 4"	32' 7"	28' 3"	23' 1"	31' 7"	26' 1"	19' 4"
1400S350-97	50	37' 10"	34' 6"	30' 1"	42' 9"	37' 1"	30' 3"	37' 1"	33' 8"	29' 6"	41' 8"	37' 1"	30' 3"
1400S350-118	50	40' 4"	36' 8"	32' 0"	48' 7"	42' 10"	35' 0"	39' 6"	35' 10"	31' 3"	44' 3"	40' 3"	35' 0"
1600S162-68	50	27' 6"	23' 9"	19' 6"	27' 6"	22' 9"	17' 0"	27' 6"	23' 9"	19' 6"	27' 6"	22' 9"	17' 0"
1600S162-97	50	36' 0"	31' 3"	25' 7"	36' 2"	31' 3"	25' 7"	35' 2"	31' 3"	25' 7"	36' 2"	31' 3"	25' 7"
1600S162-118	50	38' 7"	35' 1"	29' 8"	42' 0"	36' 4"	29' 8"	37' 9"	34' 4"	29' 8"	42' 0"	36' 4"	29' 8"
1600S200-68	50	30' 0"	26' 0"	21' 2"	28' 9"	23' 7"	17' 4"	30' 0"	26' 0"	21' 2"	28' 9"	23' 7"	17' 4"
1600S200-97	50	37' 3"	33' 10"	27' 8"	39' 2"	34' 0"	27' 8"	36' 6"	33' 2"	27' 8"	39' 2"	34' 0"	27' 8"
1600S200-118	50	40' 1"	36' 4"	31' 9"	45' 4"	39' 3"	32' 1"	39' 2"	35' 7"	31' 1"	44' 0"	39' 3"	32' 1"
1600S250-68	50	31' 3"	27' 1"	22' 2"	28' 10"	23' 8"	17' 4"	31' 3"	27' 1"	22' 2"	28' 10"	23' 8"	17' 4"
1600S250-97	50	38' 7"	35' 1"	28' 10"	40' 10"	35' 4"	28' 10"	37' 9"	34' 3"	28' 10"	40' 10"	35' 4"	28' 10"
1600S250-118	50	41' 6"	37' 8"	32' 10"	47' 3"	41' 0"	33' 4"	40' 7"	36' 10"	32' 2"	45' 6"	41' 0"	33' 4"
1600S300-68	50	31' 10"	27' 7"	22' 7"	29' 1"	23' 10"	17' 7"	31' 10"	27' 7"	22' 7"	29' 1"	23' 10"	17' 7"
1600S300-97	50	39' 7"	36' 0"	29' 8"	42' 0"	36' 4"	29' 8"	38' 9"	35' 2"	29' 8"	42' 0"	36' 4"	29' 8"
1600S300-118	50	42' 8"	38' 9"	33' 10"	48' 7"	42' 1"	34' 4"	41' 9"	38' 0"	33' 2"	47' 0"	42' 1"	34' 4"
1600S350-68	50	34' 2"	29' 7"	24' 2"	31' 1"	25' 2"	18' 2"	34' 2"	29' 7"	24' 2"	31' 1"	25' 2"	18' 2"
1600S350-97	50	41' 8"	37' 10"	32' 1"	45' 4"	39' 3"	32' 0"	40' 9"	37' 1"	32' 1"	45' 4"	39' 3"	32' 0"
1600S350-118	50	44' 8"	40' 7"	35' 6"	52' 10"	45' 9"	37' 4"	43' 8"	39' 8"	34' 8"	49' 1"	44' 7"	37' 4"

GENERAL NOTES:

- Spans are based on continuous lateral support of the compression flange over the full joist length.
- Tension flange must be laterally braced at a maximum spacing of 8'-0".
- Joists must be braced against rotation at all supports.
- Distortional buckling calculations are based on $K\phi = 0$.
- For two equal spans, the listed span is the distance from either end to the continuous centre support.
- End web crippling check is based on 3.5" end bearing. Where listed spans are followed by "e", web stiffeners are required at end supports.
- Web stiffeners are required at interior supports.
- Total load (TL) deflection is based on L/240 and live load (LL) deflection is based on either L/360 or L/480.

BAILEY MAXIMUM FLOOR JOIST SPANS (ft)

Joist Member	F _y (ksi)	15 psf Dead Load 100 psf Live Load											
		TL Deflection = L/240, LL Deflection = L/360						TL Deflection = L/240, LL Deflection = L/480					
		SINGLE SPAN			TWO EQUAL SPANS			SINGLE SPAN			TWO EQUAL SPANS		
		Joist Spacing (in.) o.c.			Joist Spacing (in.) o.c.			Joist Spacing (in.) o.c.			Joist Spacing (in.) o.c.		
		12	16	24	12	16	24	12	16	24	12	16	24
600S162-33	33	7' 3"e	6' 4"e	4' 9"e	6' 3"e	5' 0"e	3' 7"e	7' 3"e	6' 4"e	4' 9"e	6' 3"e	5' 0"e	3' 7"e
600S162-43	33	8' 9"e	7' 7"e	6' 2"e	8' 9"e	7' 6"e	5' 8"e	8' 9"e	7' 7"e	6' 2"e	8' 9"e	7' 6"e	5' 8"e
600S162-54	50	10' 9"	9' 9"	8' 3"e	11' 8"	10' 1"	8' 1"	9' 9"	8' 10"	7' 9"e	11' 0"	10' 0"	8' 1"
600S162-68	50	11' 6"	10' 6"	9' 2"	13' 0"	11' 9"	9' 7"	10' 6"	9' 6"	8' 3"	11' 9"	10' 8"	9' 3"
600S162-97	50	12' 9"	11' 7"	10' 2"	14' 4"	13' 1"	11' 4"	11' 7"	10' 7"	9' 2"	13' 1"	11' 10"	10' 4"
600S162-118	50	13' 6"	12' 3"	10' 8"	15' 2"	13' 9"	12' 0"	12' 3"	11' 2"	9' 8"	13' 9"	12' 6"	10' 10"
600S200-33	33	7' 10"e	6' 9"e	4' 9"e	6' 4"e	5' 1"e	3' 7"e	7' 10"e	6' 9"e	4' 9"e	6' 4"e	5' 1"e	3' 7"e
600S200-43	33	9' 4"e	8' 1"e	6' 7"e	9' 0"e	7' 7"e	5' 8"e	9' 4"e	8' 1"e	6' 7"e	9' 0"e	7' 7"e	5' 8"e
600S200-54	50	11' 3"	10' 3"	8' 9"e	12' 4"	10' 6"	8' 1"	10' 3"	9' 3"	8' 2"e	11' 6"	10' 6"	8' 1"
600S200-68	50	12' 1"	11' 0"	9' 7"	13' 7"	12' 4"	10' 3"	11' 0"	10' 0"	8' 9"	12' 4"	11' 3"	9' 9"
600S200-97	50	13' 6"	12' 3"	10' 8"	15' 1"	13' 9"	12' 0"	12' 3"	11' 1"	9' 8"	13' 9"	12' 6"	10' 10"
600S200-118	50	14' 3"	13' 0"	11' 3"	16' 0"	14' 6"	12' 8"	13' 0"	11' 9"	10' 3"	14' 6"	13' 2"	11' 6"
600S250-43	33	9' 7"e	8' 4"e	6' 9"e	9' 2"e	7' 8"e	5' 9"e	9' 7"e	8' 4"e	6' 9"e	9' 2"e	7' 8"e	5' 9"e
600S250-54	50	11' 8"	10' 7"e	9' 1"e	12' 8"	10' 8"	8' 2"	10' 7"	9' 8"	8' 4"e	11' 10"	10' 8"	8' 2"
600S250-68	50	12' 8"	11' 6"	10' 1"	14' 2"	12' 8"	10' 0"	11' 6"	10' 6"	9' 1"	12' 10"	11' 9"	10' 0"
600S250-97	50	14' 2"	12' 10"	11' 2"	15' 10"	14' 4"	12' 7"	12' 10"	11' 8"	10' 2"	14' 4"	13' 1"	11' 6"
600S250-118	50	15' 0"	13' 7"	11' 10"	16' 9"	15' 3"	13' 4"	13' 7"	12' 4"	10' 9"	15' 3"	13' 10"	12' 1"
600S300-54	50	12' 0"	10' 10"e	9' 2"e	12' 9"	10' 9"	8' 3"	10' 10"	9' 10"	8' 7"e	12' 2"	10' 9"	8' 3"
600S300-68	50	13' 0"	11' 9"	10' 3"	14' 7"	12' 10"	10' 2"	11' 9"	10' 9"	9' 4"	13' 3"	12' 1"	10' 2"
600S300-97	50	14' 8"	13' 3"	11' 8"	16' 6"	15' 0"	12' 10"	13' 3"	12' 1"	10' 7"	15' 0"	13' 7"	11' 10"
600S300-118	50	15' 8"	14' 2"	12' 4"	17' 7"	16' 0"	14' 0"	14' 2"	12' 10"	11' 3"	16' 0"	14' 6"	12' 8"
800S162-33	33	7' 2"e	5' 4"e	3' 7"e	5' 4"e	4' 1"e	2' 9"e	7' 2"e	5' 4"e	3' 7"e	5' 4"e	4' 1"e	2' 9"e
800S162-43	33	10' 2"e	8' 10"e	7' 2"e	9' 1"e	7' 6"e	5' 6"e	10' 2"e	8' 10"e	7' 2"e	9' 1"e	7' 6"e	5' 6"e
800S162-54	50	13' 6"	11' 9"e	9' 7"e	13' 7"	11' 4"	8' 9"	12' 2"	11' 1"e	9' 7"e	13' 7"	11' 4"	8' 9"
800S162-68	50	14' 7"	13' 2"	11' 3"e	16' 0"	13' 9"	11' 1"	13' 2"	12' 0"	10' 6"e	14' 9"	13' 6"	11' 1"
800S162-97	50	16' 2"	14' 8"	12' 10"	18' 2"	16' 6"	14' 1"	14' 8"	13' 4"	11' 8"	16' 6"	15' 0"	13' 1"
800S162-118	50	17' 1"	15' 7"	13' 7"	19' 2"	17' 6"	15' 3"	15' 7"	14' 1"	12' 4"	17' 6"	15' 10"	13' 10"
800S200-43	33	11' 0"e	9' 6"e	7' 9"e	9' 9"e	8' 0"e	5' 8"e	11' 0"e	9' 6"e	7' 9"e	9' 9"e	8' 0"e	5' 8"e
800S200-54	50	14' 2"e	12' 8"e	10' 3"e	14' 7"	12' 3"	9' 4"e	12' 10"	11' 8"e	10' 3"e	14' 6"	12' 3"	9' 4"e
800S200-68	50	15' 3"	13' 10"	12' 1"e	17' 1"	14' 9"	12' 1"	13' 10"	12' 7"	11' 0"e	15' 7"	14' 1"	12' 1"
800S200-97	50	17' 0"	15' 4"	13' 6"	19' 1"	17' 3"	15' 1"	15' 4"	14' 0"	12' 2"	17' 3"	15' 8"	13' 8"
800S200-118	50	18' 0"	16' 3"	14' 3"	20' 2"	18' 3"	16' 0"	16' 3"	14' 9"	13' 0"	18' 3"	16' 8"	14' 7"
800S250-43	33	11' 2"e	9' 8"e	8' 0"e	9' 10"e	8' 0"e	5' 9"e	11' 2"e	9' 8"e	8' 0"e	9' 10"e	8' 0"e	5' 9"e
800S250-54	50	14' 7"e	13' 0"e	10' 7"e	14' 9"	12' 4"	9' 6"e	13' 3"	12' 1"e	10' 7"e	14' 9"	12' 4"	9' 6"e
800S250-68	50	15' 10"	14' 4"	12' 4"e	17' 6"	15' 2"	12' 1"	14' 4"	13' 1"	11' 4"e	16' 2"	14' 8"	12' 1"
800S250-97	50	17' 8"	16' 1"	14' 1"	19' 10"	18' 1"	15' 8"	16' 1"	14' 7"	12' 9"	18' 1"	16' 4"	14' 4"
800S250-118	50	18' 9"	17' 1"	14' 10"	21' 1"	19' 2"	16' 9"	17' 1"	15' 6"	13' 7"	19' 2"	17' 4"	15' 2"
800S300-54	50	15' 0"e	13' 1"e	10' 8"e	14' 10"	12' 4"	9' 6"e	13' 7"e	12' 4"e	10' 8"e	14' 10"	12' 4"	9' 6"e
800S300-68	50	16' 3"	14' 9"	12' 7"e	17' 9"	15' 4"	12' 3"	14' 9"	13' 4"	11' 8"e	16' 7"	15' 1"	12' 3"
800S300-97	50	18' 3"	16' 8"	14' 7"	20' 7"	18' 8"	16' 0"	16' 8"	15' 1"	13' 2"	18' 8"	17' 0"	14' 9"
800S300-118	50	19' 7"	17' 9"	15' 6"	22' 0"	20' 0"	17' 4"	17' 9"	16' 2"	14' 1"	20' 0"	18' 1"	15' 9"
1000S162-33	33	5' 8"e	4' 3"e	2' 10"e	4' 6"e	3' 4"e	2' 3"e	5' 8"e	4' 3"e	2' 10"e	4' 6"e	3' 4"e	2' 3"e
1000S162-43	33	11' 4"e	9' 6"e	6' 3"e	8' 9"e	6' 10"e	4' 9"e	11' 4"e	9' 6"e	6' 3"e	8' 9"e	6' 10"e	4' 9"e
1000S162-54	50	15' 2"e	13' 1"e	10' 8"e	14' 1"	11' 7"	8' 7"	14' 6"e	13' 1"e	10' 8"e	14' 1"	11' 7"	8' 7"
1000S162-68	50	17' 3"	15' 6"e	12' 7"e	17' 10"	15' 6"	12' 3"	15' 8"	14' 3"	12' 6"e	17' 8"	15' 6"	12' 3"
1000S162-97	50	19' 6"	17' 8"	15' 6"	21' 10"	19' 9"	16' 2"	17' 8"	16' 1"	14' 1"	19' 10"	18' 1"	15' 9"
1000S162-118	50	20' 8"	18' 9"	16' 4"	23' 2"	21' 1"	18' 4"	18' 9"	17' 1"	14' 10"	21' 1"	19' 1"	16' 8"
1000S200-43	33	12' 3"e	9' 6"e	6' 3"e	9' 0"e	7' 0"e	4' 10"e	12' 3"e	9' 6"e	6' 3"e	9' 0"e	7' 0"e	4' 10"e
1000S200-54	50	16' 4"e	14' 2"e	11' 7"e	14' 6"	11' 10"	8' 8"e	15' 2"e	13' 9"e	11' 7"e	14' 6"	11' 10"	8' 8"e
1000S200-68	50	18' 1"	16' 6"e	13' 7"e	19' 2"	16' 6"	12' 10"	16' 6"	15' 0"e	13' 1"e	18' 6"	16' 6"	12' 10"
1000S200-97	50	20' 4"	18' 6"	16' 2"	22' 10"	20' 9"	17' 3"	18' 6"	16' 9"	14' 8"	20' 9"	18' 10"	16' 6"
1000S200-118	50	21' 7"	19' 7"	17' 1"	24' 2"	22' 0"	19' 2"	19' 7"	17' 9"	15' 7"	22' 0"	20' 0"	17' 6"
1000S250-43	33	12' 6"e	9' 6"e	6' 3"e	9' 1"e	7' 1"e	4' 10"e	12' 6"e	9' 6"e	6' 3"e	9' 1"e	7' 1"e	4' 10"e
1000S250-54	50	16' 9"e	14' 7"e	11' 10"e	15' 0"	12' 2"	8' 10"e	15' 10"e	14' 4"e	11' 10"e	15' 0"	12' 2"	8' 10"e
1000S250-68	50	18' 10"	17' 1"e	14' 0"e	19' 9"	17' 1"	13' 6"e	17' 2"	15' 7"e	13' 8"e	19' 3"	17' 1"	13' 6"e
1000S250-97	50	21' 2"	19' 3"	16' 9"	23' 9"	21' 7"	17' 9"	19' 3"	17' 6"	15' 3"	21' 7"	19' 8"	17' 2"
1000S250-118	50	22' 6"	20' 4"	17' 10"	25' 3"	23' 0"	20' 1"	20' 4"	18' 7"	16' 2"	23' 0"	20' 10"	18' 2"
1000S300-54	50	17' 0"e	14' 8"e	12' 0"e	15' 0"	12' 2"	8' 10"e	16' 1"e	14' 8"e	12' 0"e	15' 0"	12' 2"	8' 10"e
1000S300-68	50	19' 4"	17' 4"e	14' 2"e	20' 1"	17' 4"	13' 7"e	17' 7"	16' 0"e	14' 0"e	19' 9"	17' 4"	13' 7"e
1000S300-97	50	21' 10"	19' 10"	17' 3"	24' 6"	22' 3"	18' 2"	19' 10"	18' 0"	15' 9"	22' 3"	20' 3"	17' 8"
1000S300-118	50	23' 3"	21' 2"	18' 6"	26' 2"	23' 9"	20' 9"	21' 2"	19' 3"	16' 9"	23' 9"	21' 7"	18' 10"
1000S350-54	50	18' 7"e	16' 1"e	12' 7"e	15' 10"	12' 9"	9' 2"e	17' 0"e	15' 6"e	12' 7"e	15' 10"	12' 9"	9' 2"e
1000S350-68	50	20' 6"e	18' 7"e	15' 7"e	22' 1"	18' 10"	14' 7"e	18' 7"	16' 10"e	14' 9"e	20' 10"	18' 10"	14' 7"e
1000S350-97	50	23' 1"	21' 0"	18' 3"	25' 10"	23' 6"	20' 0"	21' 0"	19' 1"	16' 7"	23' 6"	21' 4"	18' 8"
1000S350-118	50	24' 6"	22' 3"	19' 6"	27' 6"	25' 0"	21' 10"	22' 3"	20' 2"	17' 8"	25' 0"	22' 8"	19' 10"

BAILEY MAXIMUM FLOOR JOIST SPANS (ft)

Joist Member	F _y (ksi)	15 psf Dead Load 100 psf Live Load											
		TL Deflection = L/240, LL Deflection = L/360						TL Deflection = L/240, LL Deflection = L/480					
		SINGLE SPAN			TWO EQUAL SPANS			SINGLE SPAN			TWO EQUAL SPANS		
		Joist Spacing (in.) o.c.			Joist Spacing (in.) o.c.			Joist Spacing (in.) o.c.			Joist Spacing (in.) o.c.		
		12	16	24	12	16	24	12	16	24	12	16	24
1200S162-43	33	10' 6"	7' 10"	5' 3"	7' 10"	6' 1"	4' 1"	10' 6"	7' 10"	5' 3"	7' 10"	6' 1"	4' 1"
1200S162-54	50	16' 3"	14' 2"	10' 4"	13' 9"	11' 0"	7' 9"	16' 3"	14' 2"	10' 4"	13' 9"	11' 0"	7' 9"
1200S162-68	50	19' 4"	16' 9"	13' 8"	19' 4"	16' 4"	12' 6"	18' 2"	16' 6"	13' 8"	19' 4"	16' 4"	12' 6"
1200S162-97	50	22' 8"	20' 7"	17' 8"	25' 1"	21' 8"	17' 8"	20' 7"	18' 8"	16' 3"	23' 1"	21' 0"	17' 8"
1200S162-118	50	24' 1"	21' 10"	19' 2"	27' 1"	24' 7"	20' 4"	21' 10"	19' 10"	17' 4"	24' 7"	22' 4"	19' 6"
1200S200-54	50	17' 9"	15' 4"	10' 4"	14' 1"	11' 2"	7' 10"	17' 4"	15' 4"	10' 4"	14' 1"	11' 2"	7' 10"
1200S200-68	50	20' 9"	18' 2"	14' 9"	20' 4"	17' 1"	13' 0"	18' 10"	17' 2"	14' 9"	20' 4"	17' 1"	13' 0"
1200S200-97	50	23' 7"	21' 4"	18' 8"	26' 6"	23' 3"	19' 0"	21' 4"	19' 6"	17' 0"	24' 1"	21' 10"	19' 0"
1200S200-118	50	25' 1"	22' 9"	20' 0"	28' 2"	25' 7"	21' 9"	22' 9"	20' 9"	18' 1"	25' 7"	23' 3"	20' 3"
1200S250-54	50	18' 3"	15' 8"	10' 4"	14' 2"	11' 2"	7' 10"	17' 9"	15' 8"	10' 4"	14' 2"	11' 2"	7' 10"
1200S250-68	50	21' 7"	18' 9"	15' 3"	20' 7"	17' 1"	13' 0"	19' 7"	17' 9"	15' 3"	20' 7"	17' 1"	13' 0"
1200S250-97	50	24' 6"	22' 3"	19' 4"	27' 6"	24' 1"	19' 8"	22' 3"	20' 2"	17' 8"	25' 0"	22' 8"	19' 8"
1200S250-118	50	26' 1"	23' 8"	20' 8"	29' 3"	26' 7"	22' 7"	23' 8"	21' 7"	18' 9"	26' 7"	24' 2"	21' 1"
1200S300-54	50	18' 6"	15' 8"	10' 4"	14' 4"	11' 3"	7' 10"	18' 3"	15' 8"	10' 4"	14' 4"	11' 3"	7' 10"
1200S300-68	50	22' 1"	19' 1"	15' 7"	21' 3"	17' 8"	13' 4"	20' 4"	18' 6"	15' 7"	21' 3"	17' 8"	13' 4"
1200S300-97	50	25' 3"	23' 0"	20' 1"	28' 4"	24' 7"	20' 1"	23' 0"	20' 10"	18' 2"	25' 9"	23' 4"	20' 1"
1200S300-118	50	27' 0"	24' 6"	21' 4"	30' 3"	27' 7"	23' 1"	24' 6"	22' 3"	19' 6"	27' 7"	25' 0"	21' 10"
1200S350-54	50	20' 1"	15' 8"	10' 4"	14' 10"	11' 8"	8' 1"	19' 4"	15' 8"	10' 4"	14' 10"	11' 8"	8' 1"
1200S350-68	50	23' 8"	20' 9"	17' 0"	23' 0"	18' 10"	14' 1"	21' 6"	19' 6"	17' 0"	23' 0"	18' 10"	14' 1"
1200S350-97	50	26' 7"	24' 2"	21' 1"	29' 10"	27' 0"	22' 0"	24' 2"	22' 0"	19' 2"	27' 2"	24' 8"	21' 7"
1200S350-118	50	28' 3"	25' 8"	22' 6"	31' 9"	28' 10"	25' 2"	25' 8"	23' 4"	20' 4"	28' 10"	26' 2"	22' 10"
1400S162-54	50	17' 3"	13' 4"	8' 10"	13' 0"	10' 1"	6' 10"	17' 3"	13' 4"	8' 10"	13' 0"	10' 1"	6' 10"
1400S162-68	50	20' 7"	17' 9"	14' 7"	20' 0"	16' 4"	12' 2"	20' 6"	17' 9"	14' 7"	20' 0"	16' 4"	12' 2"
1400S162-97	50	25' 7"	23' 3"	19' 0"	26' 10"	23' 3"	19' 0"	23' 3"	21' 2"	18' 6"	26' 2"	23' 3"	19' 0"
1400S162-118	50	27' 6"	25' 0"	21' 9"	30' 10"	26' 10"	22' 0"	25' 0"	22' 8"	19' 9"	28' 0"	25' 6"	22' 0"
1400S200-54	50	17' 9"	13' 4"	8' 10"	13' 1"	10' 2"	7' 0"	17' 9"	13' 4"	8' 10"	13' 1"	10' 2"	7' 0"
1400S200-68	50	22' 4"	19' 4"	15' 9"	20' 8"	17' 0"	12' 4"	21' 3"	19' 4"	15' 9"	20' 8"	17' 0"	12' 4"
1400S200-97	50	26' 8"	24' 2"	20' 6"	29' 0"	25' 1"	20' 6"	24' 2"	22' 0"	19' 2"	27' 2"	24' 8"	20' 6"
1400S200-118	50	28' 7"	25' 10"	22' 8"	32' 1"	28' 10"	23' 7"	25' 10"	23' 7"	20' 7"	29' 1"	26' 6"	23' 1"
1400S250-54	50	17' 9"	13' 4"	8' 10"	13' 2"	10' 2"	7' 0"	17' 9"	13' 4"	8' 10"	13' 2"	10' 2"	7' 0"
1400S250-68	50	23' 2"	20' 1"	16' 4"	20' 9"	17' 0"	12' 6"	22' 0"	20' 0"	16' 4"	20' 9"	17' 0"	12' 6"
1400S250-97	50	27' 7"	25' 1"	21' 3"	30' 1"	26' 1"	21' 3"	25' 1"	22' 9"	19' 10"	28' 2"	25' 7"	21' 3"
1400S250-118	50	29' 7"	26' 10"	23' 6"	33' 2"	30' 1"	24' 6"	26' 10"	24' 4"	21' 3"	30' 2"	27' 4"	24' 0"
1400S300-54	50	17' 9"	13' 4"	8' 10"	13' 2"	10' 2"	7' 0"	17' 9"	13' 4"	8' 10"	13' 2"	10' 2"	7' 0"
1400S300-68	50	23' 8"	20' 6"	16' 9"	21' 0"	17' 2"	12' 6"	22' 4"	20' 4"	16' 9"	21' 0"	17' 2"	12' 6"
1400S300-97	50	28' 4"	25' 9"	21' 9"	30' 9"	26' 8"	21' 9"	25' 9"	23' 4"	20' 6"	28' 10"	26' 3"	21' 9"
1400S300-118	50	30' 7"	27' 9"	24' 3"	34' 3"	30' 9"	25' 2"	27' 9"	25' 2"	22' 0"	31' 2"	28' 3"	24' 8"
1400S350-54	50	17' 9"	13' 4"	8' 10"	13' 6"	10' 4"	7' 0"	17' 9"	13' 4"	8' 10"	13' 6"	10' 4"	7' 0"
1400S350-68	50	25' 7"	22' 2"	17' 10"	22' 8"	18' 2"	13' 1"	24' 1"	21' 10"	17' 10"	22' 8"	18' 2"	13' 1"
1400S350-97	50	30' 1"	27' 4"	23' 8"	33' 7"	29' 1"	23' 8"	27' 4"	24' 10"	21' 8"	30' 8"	27' 10"	23' 8"
1400S350-118	50	32' 0"	29' 1"	25' 4"	36' 0"	32' 8"	27' 6"	29' 1"	26' 4"	23' 1"	32' 8"	29' 8"	25' 10"
1600S162-68	50	21' 7"	18' 8"	15' 3"	19' 9"	16' 0"	11' 4"	21' 7"	18' 8"	15' 3"	19' 9"	16' 0"	11' 4"
1600S162-97	50	28' 4"	24' 7"	20' 1"	28' 4"	24' 7"	20' 1"	25' 10"	23' 7"	20' 1"	28' 4"	24' 7"	20' 1"
1600S162-118	50	30' 8"	27' 10"	23' 3"	33' 0"	28' 6"	23' 3"	27' 10"	25' 3"	22' 1"	31' 3"	28' 4"	23' 3"
1600S200-68	50	23' 7"	20' 4"	15' 7"	20' 4"	16' 3"	11' 7"	23' 7"	20' 4"	15' 7"	20' 4"	16' 3"	11' 7"
1600S200-97	50	29' 7"	26' 7"	21' 8"	30' 8"	26' 7"	21' 7"	26' 10"	24' 6"	21' 4"	30' 2"	26' 7"	21' 7"
1600S200-118	50	31' 9"	28' 10"	25' 2"	35' 7"	30' 9"	25' 2"	28' 10"	26' 3"	22' 10"	32' 4"	29' 6"	25' 2"
1600S250-68	50	24' 7"	21' 3"	15' 7"	20' 6"	16' 4"	11' 7"	24' 3"	21' 3"	15' 7"	20' 6"	16' 4"	11' 7"
1600S250-97	50	30' 8"	27' 8"	22' 8"	32' 0"	27' 8"	22' 2"	27' 10"	25' 3"	22' 1"	31' 3"	27' 8"	22' 2"
1600S250-118	50	32' 10"	29' 10"	26' 1"	36' 10"	32' 1"	26' 2"	29' 10"	27' 2"	23' 8"	33' 7"	30' 6"	26' 2"
1600S300-68	50	25' 0"	21' 8"	15' 7"	20' 7"	16' 4"	11' 8"	24' 9"	21' 8"	15' 7"	20' 7"	16' 4"	11' 8"
1600S300-97	50	31' 4"	28' 6"	23' 3"	32' 10"	28' 6"	22' 8"	28' 7"	25' 10"	22' 8"	32' 1"	28' 6"	22' 8"
1600S300-118	50	33' 10"	30' 9"	26' 10"	38' 1"	33' 0"	27' 0"	30' 9"	28' 0"	24' 6"	34' 7"	31' 4"	27' 0"
1600S350-68	50	26' 9"	23' 2"	15' 7"	21' 7"	17' 0"	11' 10"	26' 2"	23' 2"	15' 7"	21' 7"	17' 0"	11' 10"
1600S350-97	50	33' 1"	30' 1"	25' 2"	35' 7"	30' 6"	23' 9"	30' 1"	27' 3"	23' 10"	33' 8"	30' 6"	23' 9"
1600S350-118	50	35' 6"	32' 2"	28' 1"	39' 9"	35' 10"	29' 3"	32' 2"	29' 3"	25' 7"	36' 2"	32' 10"	28' 8"

GENERAL NOTES:

- Spans are based on continuous lateral support of the compression flange over the full joist length.
- Tension flange must be laterally braced at a maximum spacing of 8'-0".
- Joists must be braced against rotation at all supports.
- Distortional buckling calculations are based on $K\phi = 0$.
- For two equal spans, the listed span is the distance from either end to the continuous centre support.
- End web crippling check is based on 3.5" end bearing. Where listed spans are followed by "e", web stiffeners are required at end supports.
- Web stiffeners are required at interior supports.
- Total load (TL) deflection is based on L/240 and live load (LL) deflection is based on either L/360 or L/480.

BAILEY MAXIMUM FLOOR JOIST SPANS (ft)

Joist Member	F _y (ksi)	25 psf Dead Load 100 psf Live Load											
		TL Deflection = L/240, LL Deflection = L/360						TL Deflection = L/240, LL Deflection = L/480					
		SINGLE SPAN			TWO EQUAL SPANS			SINGLE SPAN			TWO EQUAL SPANS		
		Joist Spacing (in.) o.c.			Joist Spacing (in.) o.c.			Joist Spacing (in.) o.c.			Joist Spacing (in.) o.c.		
		12	16	24	12	16	24	12	16	24	12	16	24
600S162-33	33	7' 1"e	6' 1"e	4' 6"e	6' 0"e	4' 9"e	3' 4"e	7' 1"e	6' 1"e	4' 6"e	6' 0"e	4' 9"e	3' 4"e
600S162-43	33	8' 6"e	7' 3"e	6' 0"e	8' 6"e	7' 1"e	5' 4"e	8' 6"e	7' 3"e	6' 0"e	8' 6"e	7' 1"e	5' 4"e
600S162-54	50	10' 9"	9' 9"	8' 0"e	11' 3"	9' 9"	7' 8"	9' 9"	8' 10"	7' 9"e	11' 0"	9' 9"	7' 8"
600S162-68	50	11' 6"	10' 6"	9' 2"	13' 0"	11' 4"	9' 3"	10' 6"	9' 6"	8' 3"	11' 9"	10' 8"	9' 3"
600S162-97	50	12' 9"	11' 7"	10' 2"	14' 4"	13' 1"	11' 4"	11' 7"	10' 7"	9' 2"	13' 1"	11' 10"	10' 4"
600S162-118	50	13' 6"	12' 3"	10' 8"	15' 2"	13' 9"	12' 0"	12' 3"	11' 2"	9' 8"	13' 9"	12' 6"	10' 10"
600S200-33	33	7' 7"e	6' 7"e	4' 6"e	6' 1"e	4' 9"e	3' 4"e	7' 7"e	6' 7"e	4' 6"e	6' 1"e	4' 9"e	3' 4"e
600S200-43	33	9' 1"e	7' 10"e	6' 4"e	8' 8"e	7' 2"e	5' 6"e	9' 1"e	7' 10"e	6' 4"e	8' 8"e	7' 2"e	5' 6"e
600S200-54	50	11' 3"	10' 3"e	8' 6"e	11' 10"	10' 0"	7' 8"	10' 3"	9' 3"	8' 2"e	11' 6"	10' 0"	7' 8"
600S200-68	50	12' 1"	11' 0"	9' 7"	13' 7"	12' 1"	9' 9"	11' 0"	10' 0"	8' 9"	12' 4"	11' 3"	9' 9"
600S200-97	50	13' 6"	12' 3"	10' 8"	15' 1"	13' 9"	12' 0"	12' 3"	11' 1"	9' 8"	13' 9"	12' 6"	10' 10"
600S200-118	50	14' 3"	13' 0"	11' 3"	16' 0"	14' 6"	12' 8"	13' 0"	11' 9"	10' 3"	14' 6"	13' 2"	11' 6"
600S250-43	33	9' 3"e	8' 1"e	6' 7"e	8' 9"e	7' 3"e	5' 6"e	9' 3"e	8' 1"e	6' 7"e	8' 9"e	7' 3"e	5' 6"e
600S250-54	50	11' 8"	10' 7"e	8' 8"e	12' 1"	10' 2"	7' 10"	10' 7"	9' 8"	8' 4"e	11' 10"	10' 2"	7' 10"
600S250-68	50	12' 8"	11' 6"	10' 1"e	14' 2"	12' 2"	9' 7"	11' 6"	10' 6"	9' 1"	12' 10"	11' 9"	9' 7"
600S250-97	50	14' 2"	12' 10"	11' 2"	15' 10"	14' 4"	12' 6"	12' 10"	11' 8"	10' 2"	14' 4"	13' 1"	11' 6"
600S250-118	50	15' 0"	13' 7"	11' 10"	16' 9"	15' 3"	13' 4"	13' 7"	12' 4"	10' 9"	15' 3"	13' 10"	12' 1"
600S300-54	50	12' 0"	10' 10"e	8' 10"e	12' 3"	10' 3"	8' 0"	10' 10"	9' 10"e	8' 7"e	12' 2"	10' 3"	8' 0"
600S300-68	50	13' 0"	11' 9"	10' 3"e	14' 7"	12' 4"	9' 9"	11' 9"	10' 9"	9' 4"	13' 3"	12' 1"	9' 9"
600S300-97	50	14' 8"	13' 3"	11' 8"	16' 6"	15' 0"	12' 3"	13' 3"	12' 1"	10' 7"	15' 0"	13' 7"	11' 10"
600S300-118	50	15' 8"	14' 2"	12' 4"	17' 7"	16' 0"	13' 9"	14' 2"	12' 10"	11' 3"	16' 0"	14' 6"	12' 8"
800S162-33	33	6' 8"e	5' 0"e	3' 3"e	5' 1"e	3' 10"e	2' 7"e	6' 8"e	5' 0"e	3' 3"e	5' 1"e	3' 10"e	2' 7"e
800S162-43	33	9' 10"e	8' 6"e	7' 0"e	8' 8"e	7' 1"e	5' 2"e	9' 10"e	8' 6"e	7' 0"e	8' 8"e	7' 1"e	5' 2"e
800S162-54	50	13' 2"e	11' 4"e	9' 3"e	13' 0"	11' 0"	8' 4"e	12' 2"	11' 1"e	9' 3"e	13' 0"	11' 0"	8' 4"e
800S162-68	50	14' 7"	13' 2"	10' 10"e	15' 4"	13' 3"	10' 8"	13' 2"	12' 0"	10' 6"e	14' 9"	13' 3"	10' 8"
800S162-97	50	16' 2"	14' 8"	12' 10"	18' 2"	16' 6"	13' 7"	14' 8"	13' 4"	11' 8"	16' 6"	15' 0"	13' 1"
800S162-118	50	17' 1"	15' 7"	13' 7"	19' 2"	17' 6"	13' 3"	15' 7"	14' 1"	12' 4"	17' 6"	15' 10"	13' 10"
800S200-43	33	10' 7"e	9' 2"e	7' 4"e	9' 3"e	7' 6"e	5' 4"e	10' 7"e	9' 2"e	7' 4"e	9' 3"e	7' 6"e	5' 4"e
800S200-54	50	14' 1"e	12' 2"e	10' 0"e	14' 1"	11' 9"	9' 0"e	12' 10"e	11' 8"e	10' 0"e	14' 1"	11' 9"	9' 0"e
800S200-68	50	15' 3"	13' 10"	11' 8"e	16' 6"	14' 3"	11' 8"	13' 10"	12' 7"	11' 0"e	15' 7"	14' 1"	11' 8"
800S200-97	50	17' 0"	15' 4"	13' 6"	19' 1"	17' 3"	14' 8"	15' 4"	14' 0"	12' 2"	17' 3"	15' 8"	13' 8"
800S200-118	50	18' 0"	16' 3"	14' 3"	20' 2"	18' 3"	16' 0"	16' 3"	14' 9"	13' 0"	18' 3"	16' 8"	14' 7"
800S250-43	33	10' 10"e	9' 4"e	7' 4"e	9' 4"e	7' 7"e	5' 4"e	10' 10"e	9' 4"e	7' 4"e	9' 4"e	7' 7"e	5' 4"e
800S250-54	50	14' 4"e	12' 6"e	10' 2"e	14' 2"	11' 10"	9' 0"e	13' 3"e	12' 1"e	10' 2"e	14' 2"	11' 10"	9' 0"e
800S250-68	50	15' 10"	14' 4"e	12' 0"e	16' 10"	14' 7"	11' 7"	14' 4"	13' 1"	11' 4"e	16' 2"	14' 7"	11' 7"
800S250-97	50	17' 8"	16' 1"	14' 1"	19' 10"	18' 1"	15' 1"	16' 1"	14' 7"	12' 9"	18' 1"	16' 4"	14' 4"
800S250-118	50	18' 9"	17' 1"	14' 10"	21' 1"	19' 2"	16' 9"	17' 1"	15' 6"	13' 7"	19' 2"	17' 4"	15' 2"
800S300-54	50	14' 7"e	12' 8"e	10' 4"e	14' 2"	11' 10"	9' 0"e	13' 7"e	12' 4"e	10' 4"e	14' 2"	11' 10"	9' 0"e
800S300-68	50	16' 3"	14' 9"e	12' 2"e	17' 2"	14' 10"	11' 9"	14' 9"	13' 4"	11' 8"e	16' 7"	14' 10"	11' 9"
800S300-97	50	18' 3"	16' 8"	14' 7"	20' 7"	18' 8"	15' 6"	16' 8"	15' 1"	13' 2"	18' 8"	17' 0"	14' 9"
800S300-118	50	19' 7"	17' 9"	15' 6"	22' 0"	20' 0"	17' 4"	17' 9"	16' 2"	14' 1"	20' 0"	18' 1"	15' 9"
1000S162-33	33	5' 3"e	4' 0"e	2' 8"e	4' 2"e	3' 2"e	2' 1"e	5' 3"e	4' 0"e	2' 8"e	4' 2"e	3' 2"e	2' 1"e
1000S162-43	33	11' 0"e	8' 10"e	5' 10"e	8' 3"e	6' 6"e	4' 6"e	11' 0"e	8' 10"e	5' 10"e	8' 3"e	6' 6"e	4' 6"e
1000S162-54	50	14' 7"e	12' 8"e	10' 3"e	13' 6"	11' 0"	8' 1"	14' 6"e	12' 8"e	10' 3"e	13' 6"	11' 0"	8' 1"
1000S162-68	50	17' 3"	14' 10"e	12' 2"e	17' 3"	14' 10"	11' 9"	15' 8"	14' 3"e	12' 2"e	17' 3"	14' 10"	11' 9"
1000S162-97	50	19' 6"	17' 8"	15' 6"	21' 10"	19' 1"	15' 7"	17' 8"	16' 1"	14' 1"	19' 10"	18' 1"	15' 7"
1000S162-118	50	20' 8"	18' 9"	16' 4"	23' 2"	21' 1"	17' 9"	18' 9"	17' 1"	14' 10"	21' 1"	19' 1"	16' 8"
1000S200-43	33	11' 9"e	8' 10"e	5' 10"e	8' 6"e	6' 7"e	4' 7"e	11' 9"e	8' 10"e	5' 10"e	8' 6"e	6' 7"e	4' 7"e
1000S200-54	50	15' 9"e	13' 8"e	11' 2"e	13' 9"	11' 3"	8' 2"e	15' 2"e	13' 8"e	11' 2"e	13' 9"	11' 3"	8' 2"e
1000S200-68	50	18' 1"	16' 1"e	13' 1"e	18' 6"	15' 9"	12' 3"e	16' 6"	15' 0"e	13' 1"e	18' 6"	15' 9"	12' 3"e
1000S200-97	50	20' 4"	18' 6"	16' 2"	22' 10"	20' 4"	16' 8"	18' 6"	16' 9"	14' 8"	20' 9"	18' 10"	16' 6"
1000S200-118	50	21' 7"	19' 7"	17' 1"	24' 2"	22' 0"	18' 10"	19' 7"	17' 9"	15' 7"	22' 0"	20' 0"	17' 6"
1000S250-43	33	11' 9"e	8' 10"e	5' 10"e	8' 7"e	6' 8"e	4' 7"e	11' 9"e	8' 10"e	5' 10"e	8' 7"e	6' 8"e	4' 7"e
1000S250-54	50	16' 2"e	14' 0"e	11' 6"e	14' 2"	11' 6"	8' 4"e	15' 10"e	14' 0"e	11' 6"e	14' 2"	11' 6"	8' 4"e
1000S250-68	50	18' 10"e	16' 6"e	13' 6"e	19' 1"	16' 6"	12' 10"e	17' 2"	15' 7"e	13' 6"e	19' 1"	16' 6"	12' 10"e
1000S250-97	50	21' 2"	19' 3"	16' 9"	23' 9"	21' 1"	17' 2"	19' 3"	17' 6"	15' 3"	21' 7"	19' 8"	17' 2"
1000S250-118	50	22' 6"	20' 4"	17' 10"	25' 3"	23' 0"	19' 7"	20' 4"	18' 7"	16' 2"	23' 0"	20' 10"	18' 2"
1000S300-54	50	16' 4"e	14' 2"e	11' 7"e	14' 3"	11' 7"	8' 4"e	16' 1"e	14' 2"e	11' 7"e	14' 3"	11' 7"	8' 4"e
1000S300-68	50	19' 4"e	16' 9"e	13' 8"e	19' 4"	16' 9"	13' 0"e	17' 7"	16' 0"e	13' 8"e	19' 4"	16' 9"	13' 0"e
1000S300-97	50	21' 10"	19' 10"	17' 3"	24' 6"	21' 6"	17' 6"	19' 10"	18' 0"	15' 9"	22' 3"	20' 3"	17' 6"
1000S300-118	50	23' 3"	21' 2"	18' 6"	26' 2"	23' 9"	20' 1"	21' 2"	19' 3"	16' 9"	23' 9"	21' 7"	18' 10"
1000S350-54	50	18' 0"e	15' 7"e	11' 8"e	15' 1"	12' 1"	8' 7"e	17' 0"e	15' 6"e	11' 8"e	15' 1"	12' 1"	8' 7"e
1000S350-68	50	20' 6"e	18' 4"e	15' 1"e	21' 3"	18' 1"	13' 10"e	18' 7"e	16' 10"e	14' 9"e	20' 10"	18' 1"	13' 10"e
1000S350-97	50	23' 1"	21' 0"	18' 3"e	25' 10"	23' 6"	19' 3"	21' 0"	19' 1"	16' 7"	23' 6"	21' 4"	18' 8"
1000S350-118	50	24' 6"	22' 3"	19' 6"	27' 6"	25' 0"	21' 10"	22' 3"	20' 2"	17' 8"	25' 0"	22' 8"	19' 10"

BAILEY MAXIMUM FLOOR JOIST SPANS (ft)

Joist Member	F _y (ksi)	25 psf Dead Load 100 psf Live Load											
		TL Deflection = L/240, LL Deflection = L/360						TL Deflection = L/240, LL Deflection = L/480					
		SINGLE SPAN			TWO EQUAL SPANS			SINGLE SPAN			TWO EQUAL SPANS		
		Joist Spacing (in.) o.c.			Joist Spacing (in.) o.c.			Joist Spacing (in.) o.c.			Joist Spacing (in.) o.c.		
		12	16	24	12	16	24	12	16	24	12	16	24
1200S162-43	33	9' 9"	7' 3"	4' 10"	7' 4"	5' 8"	3' 10"	9' 9"	7' 3"	4' 10"	7' 4"	5' 8"	3' 10"
1200S162-54	50	15' 9"	13' 8"	9' 8"	13' 1"	10' 4"	7' 3"	15' 9"	13' 8"	9' 8"	13' 1"	10' 4"	7' 3"
1200S162-68	50	18' 8"	16' 2"	13' 2"	18' 8"	15' 7"	11' 10"	18' 2"	16' 2"	13' 2"	18' 8"	15' 7"	11' 10"
1200S162-97	50	22' 8"	20' 7"	17' 1"	24' 2"	21' 0"	17' 1"	20' 7"	18' 8"	16' 3"	23' 1"	21' 0"	17' 1"
1200S162-118	50	24' 1"	21' 10"	19' 2"	27' 1"	24' 1"	19' 8"	21' 10"	19' 10"	17' 4"	24' 7"	22' 4"	19' 6"
1200S200-54	50	17' 1"	14' 7"	9' 8"	13' 3"	10' 6"	7' 4"	17' 1"	14' 7"	9' 8"	13' 3"	10' 6"	7' 4"
1200S200-68	50	20' 2"	17' 6"	14' 3"	19' 7"	16' 3"	12' 3"	18' 10"	17' 2"	14' 3"	19' 7"	16' 3"	12' 3"
1200S200-97	50	23' 7"	21' 4"	18' 4"	26' 0"	22' 6"	18' 4"	21' 4"	19' 6"	17' 0"	24' 1"	21' 10"	18' 4"
1200S200-118	50	25' 1"	22' 9"	20' 0"	28' 2"	25' 7"	21' 1"	22' 9"	20' 9"	18' 1"	25' 7"	23' 3"	20' 3"
1200S250-54	50	17' 8"	14' 7"	9' 8"	13' 4"	10' 7"	7' 4"	17' 8"	14' 7"	9' 8"	13' 4"	10' 7"	7' 4"
1200S250-68	50	20' 10"	18' 1"	14' 9"	19' 8"	16' 4"	12' 4"	19' 7"	17' 9"	14' 9"	19' 8"	16' 4"	12' 4"
1200S250-97	50	24' 6"	22' 3"	19' 0"	26' 10"	23' 3"	19' 0"	22' 3"	20' 2"	17' 8"	25' 0"	22' 8"	19' 0"
1200S250-118	50	26' 1"	23' 8"	20' 8"	29' 3"	26' 7"	21' 9"	23' 8"	21' 7"	18' 9"	26' 7"	24' 2"	21' 1"
1200S300-54	50	17' 10"	14' 7"	9' 8"	13' 7"	10' 8"	7' 4"	17' 10"	14' 7"	9' 8"	13' 7"	10' 8"	7' 4"
1200S300-68	50	21' 3"	18' 6"	15' 1"	20' 4"	16' 10"	12' 8"	20' 4"	18' 6"	15' 1"	20' 4"	16' 10"	12' 8"
1200S300-97	50	25' 3"	23' 0"	19' 4"	27' 4"	23' 9"	19' 4"	23' 0"	20' 10"	18' 2"	25' 9"	23' 4"	19' 4"
1200S300-118	50	27' 0"	24' 6"	21' 4"	30' 3"	27' 3"	22' 3"	24' 6"	22' 3"	19' 6"	27' 7"	25' 0"	21' 10"
1200S350-54	50	19' 4"	14' 7"	9' 8"	14' 1"	10' 10"	7' 6"	19' 4"	14' 7"	9' 8"	14' 1"	10' 10"	7' 6"
1200S350-68	50	23' 2"	20' 1"	16' 4"	21' 10"	18' 0"	13' 3"	21' 6"	19' 6"	16' 4"	21' 10"	18' 0"	13' 3"
1200S350-97	50	26' 7"	24' 2"	21' 1"	29' 10"	26' 0"	21' 2"	24' 2"	22' 0"	19' 2"	27' 2"	24' 8"	21' 2"
1200S350-118	50	28' 3"	25' 8"	22' 6"	31' 9"	28' 10"	24' 4"	25' 8"	23' 4"	20' 4"	28' 10"	26' 2"	22' 10"
1400S162-54	50	16' 7"	12' 6"	8' 3"	12' 2"	9' 4"	6' 6"	16' 7"	12' 6"	8' 3"	12' 2"	9' 4"	6' 6"
1400S162-68	50	19' 10"	17' 2"	14' 1"	19' 1"	15' 7"	11' 6"	19' 10"	17' 2"	14' 1"	19' 1"	15' 7"	11' 6"
1400S162-97	50	25' 7"	22' 6"	18' 3"	25' 10"	22' 6"	18' 3"	23' 3"	21' 2"	18' 3"	25' 10"	22' 6"	18' 3"
1400S162-118	50	27' 6"	25' 0"	21' 2"	30' 0"	26' 0"	21' 2"	25' 0"	22' 8"	19' 9"	28' 0"	25' 6"	21' 2"
1400S200-54	50	16' 7"	12' 6"	8' 3"	12' 3"	9' 6"	6' 6"	16' 7"	12' 6"	8' 3"	12' 3"	9' 6"	6' 6"
1400S200-68	50	21' 7"	18' 8"	15' 3"	19' 9"	16' 1"	11' 8"	21' 3"	18' 8"	15' 3"	19' 9"	16' 1"	11' 8"
1400S200-97	50	26' 8"	24' 2"	19' 9"	28' 0"	24' 2"	19' 9"	24' 2"	22' 0"	19' 2"	27' 2"	24' 2"	19' 9"
1400S200-118	50	28' 7"	25' 10"	22' 8"	32' 1"	27' 10"	22' 9"	25' 10"	23' 7"	20' 7"	29' 1"	26' 6"	22' 9"
1400S250-54	50	16' 7"	12' 6"	8' 3"	12' 4"	9' 6"	6' 6"	16' 7"	12' 6"	8' 3"	12' 4"	9' 6"	6' 6"
1400S250-68	50	22' 4"	19' 4"	15' 10"	19' 9"	16' 1"	11' 9"	22' 0"	19' 4"	15' 10"	19' 9"	16' 1"	11' 9"
1400S250-97	50	27' 7"	25' 1"	20' 6"	29' 0"	25' 2"	20' 6"	25' 1"	22' 9"	19' 10"	28' 2"	25' 2"	20' 6"
1400S250-118	50	29' 5"	26' 10"	23' 6"	33' 2"	29' 0"	23' 8"	26' 10"	24' 4"	21' 3"	30' 2"	27' 4"	23' 8"
1400S300-54	50	16' 7"	12' 6"	8' 3"	12' 4"	9' 7"	6' 6"	16' 7"	12' 6"	8' 3"	12' 4"	9' 7"	6' 6"
1400S300-68	50	22' 10"	19' 9"	16' 2"	20' 0"	16' 3"	11' 9"	22' 4"	19' 9"	16' 2"	20' 0"	16' 3"	11' 9"
1400S300-97	50	28' 4"	25' 9"	21' 0"	29' 8"	25' 9"	21' 0"	25' 9"	23' 4"	20' 6"	28' 10"	25' 9"	21' 0"
1400S300-118	50	30' 7"	27' 9"	24' 3"	34' 3"	29' 8"	24' 3"	27' 9"	25' 2"	22' 0"	31' 2"	28' 3"	24' 3"
1400S350-54	50	16' 7"	12' 6"	8' 3"	12' 8"	9' 8"	6' 7"	16' 7"	12' 6"	8' 3"	12' 8"	9' 8"	6' 7"
1400S350-68	50	24' 8"	21' 4"	16' 8"	21' 6"	17' 2"	12' 3"	24' 1"	21' 4"	16' 8"	21' 6"	17' 2"	12' 3"
1400S350-97	50	30' 1"	27' 4"	22' 10"	32' 4"	28' 0"	22' 10"	27' 4"	24' 10"	21' 8"	30' 8"	27' 10"	22' 10"
1400S350-118	50	32' 0"	29' 1"	25' 4"	36' 0"	32' 4"	26' 6"	29' 1"	26' 4"	23' 1"	32' 8"	29' 8"	25' 10"
1600S162-68	50	20' 9"	18' 0"	14' 7"	18' 9"	15' 1"	10' 8"	20' 9"	18' 0"	14' 7"	18' 9"	15' 1"	10' 8"
1600S162-97	50	27' 4"	23' 8"	19' 4"	27' 4"	23' 8"	19' 4"	25' 10"	23' 7"	19' 4"	27' 4"	23' 8"	19' 4"
1600S162-118	50	30' 8"	27' 6"	22' 6"	31' 9"	27' 6"	22' 6"	27' 10"	25' 3"	22' 1"	31' 3"	27' 6"	22' 6"
1600S200-68	50	22' 8"	19' 8"	14' 7"	19' 3"	15' 4"	10' 10"	22' 8"	19' 8"	14' 7"	19' 3"	15' 4"	10' 10"
1600S200-97	50	29' 7"	25' 8"	21' 0"	29' 8"	25' 8"	20' 8"	26' 10"	24' 6"	21' 0"	29' 8"	25' 8"	20' 8"
1600S200-118	50	31' 9"	28' 10"	24' 3"	34' 3"	29' 8"	24' 3"	28' 10"	26' 3"	22' 10"	32' 4"	29' 6"	24' 3"
1600S250-68	50	23' 8"	20' 6"	14' 7"	19' 4"	15' 4"	10' 10"	23' 8"	20' 6"	14' 7"	19' 4"	15' 4"	10' 10"
1600S250-97	50	30' 8"	26' 9"	21' 10"	30' 10"	26' 9"	21' 3"	27' 10"	25' 3"	21' 10"	30' 10"	26' 9"	21' 3"
1600S250-118	50	32' 10"	29' 10"	25' 3"	35' 9"	31' 0"	25' 3"	29' 10"	27' 2"	23' 8"	33' 7"	30' 6"	25' 3"
1600S300-68	50	24' 2"	20' 10"	14' 7"	19' 6"	15' 6"	10' 10"	24' 2"	20' 10"	14' 7"	19' 6"	15' 6"	10' 10"
1600S300-97	50	31' 4"	27' 6"	22' 6"	31' 9"	27' 6"	21' 8"	28' 7"	25' 10"	22' 6"	31' 9"	27' 6"	21' 8"
1600S300-118	50	33' 10"	30' 9"	26' 0"	36' 9"	31' 10"	26' 0"	30' 9"	28' 0"	24' 6"	34' 7"	31' 4"	26' 0"
1600S350-68	50	25' 10"	21' 9"	14' 7"	20' 4"	16' 0"	11' 1"	25' 10"	21' 9"	14' 7"	20' 4"	16' 0"	11' 1"
1600S350-97	50	33' 1"	29' 9"	24' 3"	34' 4"	29' 2"	22' 8"	30' 1"	27' 3"	23' 10"	33' 8"	29' 2"	22' 8"
1600S350-118	50	35' 6"	32' 2"	28' 1"	39' 9"	34' 7"	28' 3"	32' 2"	29' 3"	25' 7"	36' 2"	32' 10"	28' 3"

GENERAL NOTES:

- Spans are based on continuous lateral support of the compression flange over the full joist length.
- Tension flange must be laterally braced at a maximum spacing of 8'-0".
- Joists must be braced against rotation at all supports.
- Distortional buckling calculations are based on K_φ = 0.
- For two equal spans, the listed span is the distance from either end to the continuous centre support.
- End web crippling check is based on 3.5" end bearing. Where listed spans are followed by "e", web stiffeners are required at end supports.
- Web stiffeners are required at interior supports.
- Total load (TL) deflection is based on L/240 and live load (LL) deflection is based on either L/360 or L/480.

BAILEY MAXIMUM FLOOR JOIST SPANS (ft)

Joist Member	F _y (ksi)	35 psf Dead Load 100 psf Live Load											
		TL Deflection = L/240, LL Deflection = L/360						TL Deflection = L/240, LL Deflection = L/480					
		SINGLE SPAN			TWO EQUAL SPANS			SINGLE SPAN			TWO EQUAL SPANS		
		Joist Spacing (in.) o.c.			Joist Spacing (in.) o.c.			Joist Spacing (in.) o.c.			Joist Spacing (in.) o.c.		
		12	16	24	12	16	24	12	16	24	12	16	24
600S162-33	33	6' 10"e	5' 10"e	4' 2"e	5' 8"e	4' 6"e	3' 2"e	6' 10"e	5' 10"e	4' 2"e	5' 8"e	4' 6"e	3' 2"e
600S162-43	33	8' 2"e	7' 1"e	5' 9"e	8' 2"e	6' 9"e	5' 2"e	8' 2"e	7' 1"e	5' 9"e	8' 2"e	6' 9"e	5' 2"e
600S162-54	50	10' 9"	9' 6"e	7' 8"e	10' 10"	9' 6"	7' 4"	9' 9"	8' 10"	7' 8"e	10' 10"	9' 6"	7' 4"
600S162-68	50	11' 6"	10' 6"	9' 0"	12' 8"	11' 0"	9' 0"	10' 6"	9' 6"	8' 3"	11' 9"	10' 8"	9' 0"
600S162-97	50	12' 9"	11' 7"	10' 2"	14' 4"	13' 1"	11' 1"	11' 7"	10' 7"	9' 2"	13' 1"	11' 10"	10' 4"
600S162-118	50	13' 6"	12' 3"	10' 8"	15' 2"	13' 9"	11' 9"	12' 3"	11' 2"	9' 8"	13' 9"	12' 6"	10' 10"
600S200-33	33	7' 3"e	6' 3"e	4' 2"e	5' 9"e	4' 7"e	3' 2"e	7' 3"e	6' 3"e	4' 2"e	5' 9"e	4' 7"e	3' 2"e
600S200-43	33	8' 9"e	7' 7"e	6' 2"e	8' 3"e	6' 10"e	5' 2"e	8' 9"e	7' 7"e	6' 2"e	8' 3"e	6' 10"e	5' 2"e
600S200-54	50	11' 3"	10' 1"e	8' 2"e	11' 4"	9' 7"	7' 4"	10' 3"	9' 3"e	8' 2"e	11' 4"	9' 7"	7' 4"
600S200-68	50	12' 1"	11' 0"	9' 7"e	13' 6"	11' 8"	9' 4"	11' 0"	10' 0"	8' 9"	12' 4"	11' 3"	9' 4"
600S200-97	50	13' 6"	12' 3"	10' 8"	15' 1"	13' 9"	11' 8"	12' 3"	11' 1"	9' 8"	13' 9"	12' 6"	10' 10"
600S200-118	50	14' 3"	13' 0"	11' 3"	16' 0"	14' 6"	12' 4"	13' 0"	11' 9"	10' 3"	14' 6"	13' 2"	11' 6"
600S250-43	33	9' 0"e	7' 9"e	6' 4"e	8' 6"e	7' 0"e	5' 3"e	9' 0"e	7' 9"e	6' 4"e	8' 6"e	7' 0"e	5' 3"e
600S250-54	50	11' 8"	10' 4"e	8' 6"e	11' 8"	9' 9"	7' 6"	10' 7"	9' 8"e	8' 4"e	11' 8"	9' 9"	7' 6"
600S250-68	50	12' 8"	11' 6"	9' 9"e	13' 9"	11' 8"	9' 2"	11' 6"	10' 6"	9' 1"	12' 10"	11' 8"	9' 2"
600S250-97	50	14' 2"	12' 10"	11' 2"	15' 10"	14' 4"	12' 0"	12' 10"	11' 8"	10' 2"	14' 4"	13' 1"	11' 6"
600S250-118	50	15' 0"	13' 7"	11' 10"	16' 9"	15' 3"	12' 9"	13' 7"	12' 4"	10' 9"	15' 3"	13' 10"	12' 1"
600S300-54	50	12' 0"	10' 6"e	8' 7"e	11' 9"	9' 10"	7' 7"	10' 10"	9' 10"e	8' 7"e	11' 9"	9' 10"	7' 7"
600S300-68	50	13' 0"	11' 9"	10' 0"e	14' 1"	12' 0"	9' 4"	11' 9"	10' 9"	9' 4"e	13' 3"	12' 0"	9' 4"
600S300-97	50	14' 8"	13' 3"	11' 8"	16' 6"	15' 0"	11' 10"	13' 3"	12' 1"	10' 7"	15' 0"	13' 7"	11' 10"
600S300-118	50	15' 8"	14' 2"	12' 4"	17' 7"	16' 0"	13' 3"	14' 2"	12' 10"	11' 3"	16' 0"	14' 6"	12' 8"
800S162-33	33	6' 3"e	4' 8"e	3' 1"e	4' 9"e	3' 7"e	2' 6"e	6' 3"e	4' 8"e	3' 1"e	4' 9"e	3' 7"e	2' 6"e
800S162-43	33	9' 6"e	8' 3"e	6' 9"e	8' 3"e	6' 9"e	4' 10"e	9' 6"e	8' 3"e	6' 9"e	8' 3"e	6' 9"e	4' 10"e
800S162-54	50	12' 8"e	11' 0"e	9' 0"e	12' 6"	10' 6"	8' 1"e	12' 2"e	11' 0"e	9' 0"e	12' 6"	10' 6"	8' 1"e
800S162-68	50	14' 7"	12' 10"	10' 6"e	14' 10"	12' 10"	10' 3"	13' 2"	12' 0"	10' 6"e	14' 9"	12' 10"	10' 3"
800S162-97	50	16' 2"	14' 8"	12' 10"	18' 2"	16' 3"	13' 1"	14' 8"	13' 4"	11' 8"	16' 6"	15' 0"	13' 1"
800S162-118	50	17' 1"	15' 7"	13' 7"	19' 2"	17' 6"	15' 3"	15' 7"	14' 1"	12' 4"	17' 6"	15' 10"	13' 10"
800S200-43	33	10' 3"e	8' 10"e	6' 10"e	8' 10"e	7' 1"e	5' 1"e	10' 3"e	8' 10"e	6' 10"e	8' 10"e	7' 1"e	5' 1"e
800S200-54	50	13' 7"e	11' 9"e	9' 7"e	13' 6"	11' 3"	8' 7"e	12' 10"e	11' 8"e	9' 7"e	13' 6"	11' 3"	8' 7"e
800S200-68	50	15' 3"	13' 9"e	11' 3"e	15' 10"	13' 9"	11' 3"	13' 10"	12' 7"	11' 0"e	15' 7"	13' 9"	11' 3"
800S200-97	50	17' 0"	15' 4"	13' 6"	19' 1"	17' 3"	14' 2"	15' 4"	14' 0"	12' 2"	17' 3"	15' 8"	13' 8"
800S200-118	50	18' 0"	16' 3"	14' 3"	20' 2"	18' 3"	16' 0"	16' 3"	14' 9"	13' 0"	18' 3"	16' 8"	14' 7"
800S250-43	33	10' 6"e	9' 1"e	6' 10"e	8' 10"e	7' 2"e	5' 1"e	10' 6"e	9' 1"e	6' 10"e	8' 10"e	7' 2"e	5' 1"e
800S250-54	50	14' 0"e	12' 1"e	9' 10"e	13' 7"	11' 4"	8' 7"e	13' 3"e	12' 1"e	9' 10"e	13' 7"	11' 4"	8' 7"e
800S250-68	50	15' 10"	14' 2"e	11' 7"e	16' 4"	14' 2"	11' 1"	14' 4"	13' 1"	11' 4"e	16' 2"	14' 2"	11' 1"
800S250-97	50	17' 8"	16' 1"	14' 1"	19' 10"	17' 10"	14' 7"	16' 1"	14' 7"	12' 9"	18' 1"	16' 4"	14' 4"
800S250-118	50	18' 9"	17' 1"	14' 10"	21' 1"	19' 2"	16' 7"	17' 1"	15' 6"	13' 7"	19' 2"	17' 4"	15' 2"
800S300-54	50	14' 2"e	12' 3"e	10' 0"e	13' 8"	11' 4"	8' 7"e	13' 7"e	12' 3"e	10' 0"e	13' 8"	11' 4"	8' 7"e
800S300-68	50	16' 3"	14' 4"e	11' 9"e	16' 7"	14' 4"	11' 3"	14' 9"	13' 4"e	11' 8"e	16' 7"	14' 4"	11' 3"
800S300-97	50	18' 3"	16' 8"	14' 7"	20' 7"	18' 3"	14' 10"	16' 8"	15' 1"	13' 2"	18' 8"	17' 0"	14' 9"
800S300-118	50	19' 7"	17' 9"	15' 6"	22' 0"	20' 0"	17' 0"	17' 9"	16' 2"	14' 1"	20' 0"	18' 1"	15' 9"
1000S162-33	33	5' 0"e	3' 8"e	2' 6"e	3' 10"e	3' 0"e	2' 0"e	5' 0"e	3' 8"e	2' 6"e	3' 10"e	3' 0"e	2' 0"e
1000S162-43	33	10' 7"	8' 3"e	5' 6"e	7' 9"e	6' 1"e	4' 3"e	10' 7"e	8' 3"e	5' 6"e	7' 9"e	6' 1"e	4' 3"e
1000S162-54	50	14' 2"e	12' 3"e	10' 0"e	12' 10"	10' 6"	7' 8"e	14' 2"e	12' 3"e	10' 0"e	12' 10"	10' 6"	7' 8"e
1000S162-68	50	16' 8"	14' 6"e	11' 9"e	16' 8"	14' 6"	11' 3"	15' 8"	14' 3"e	11' 9"e	16' 8"	14' 6"	11' 3"
1000S162-97	50	19' 6"	17' 8"	15' 1"	21' 3"	18' 6"	15' 1"	17' 8"	16' 1"	14' 1"	19' 10"	18' 1"	15' 1"
1000S162-118	50	20' 8"	18' 9"	16' 4"	23' 2"	21' 1"	17' 1"	18' 9"	17' 1"	14' 10"	21' 1"	19' 1"	16' 8"
1000S200-43	33	11' 0"e	8' 3"e	5' 6"e	8' 0"e	6' 2"e	4' 3"e	11' 0"e	8' 3"e	5' 6"e	8' 0"e	6' 2"e	4' 3"e
1000S200-54	50	15' 3"e	13' 2"e	10' 9"e	13' 2"	10' 8"	7' 9"e	15' 2"e	13' 2"e	10' 9"e	13' 2"	10' 8"	7' 9"e
1000S200-68	50	17' 10"e	15' 6"e	12' 8"e	17' 10"	15' 2"	11' 9"e	16' 6"	15' 0"e	12' 8"e	17' 10"	15' 2"	11' 9"e
1000S200-97	50	20' 4"	18' 6"	16' 1"	22' 9"	19' 9"	16' 1"	18' 6"	16' 9"	14' 8"	20' 9"	18' 10"	16' 1"
1000S200-118	50	21' 7"	19' 7"	17' 1"	24' 2"	22' 0"	18' 2"	19' 7"	17' 9"	15' 7"	22' 0"	20' 0"	17' 6"
1000S250-43	33	11' 0"e	8' 3"e	5' 6"e	8' 1"e	6' 3"e	4' 3"e	11' 0"e	8' 3"e	5' 6"e	8' 1"e	6' 3"e	4' 3"e
1000S250-54	50	15' 8"e	13' 7"e	11' 0"e	13' 7"	11' 0"	7' 10"e	15' 8"e	13' 7"e	11' 0"e	13' 7"	11' 0"	7' 10"e
1000S250-68	50	18' 4"e	16' 0"e	13' 0"e	18' 4"	16' 0"	12' 4"e	17' 2"	15' 7"e	13' 0"e	18' 4"	16' 0"	12' 4"e
1000S250-97	50	21' 2"	19' 3"	16' 7"e	23' 6"	20' 4"	16' 7"	19' 3"	17' 6"	15' 3"	21' 7"	19' 8"	16' 7"
1000S250-118	50	22' 6"	20' 4"	17' 10"	25' 3"	23' 0"	19' 0"	20' 4"	18' 7"	16' 2"	23' 0"	20' 10"	18' 2"
1000S300-54	50	15' 10"e	13' 8"e	11' 0"e	13' 7"	11' 0"	7' 10"e	15' 10"e	13' 8"e	11' 0"e	13' 7"	11' 0"	7' 10"e
1000S300-68	50	18' 9"e	16' 2"e	13' 3"e	18' 9"	16' 1"	12' 4"e	17' 7"e	16' 0"e	13' 3"e	18' 9"	16' 1"	12' 4"e
1000S300-97	50	21' 10"	19' 10"	17' 0"e	24' 0"	20' 9"	17' 0"	19' 10"	18' 0"	15' 9"	22' 3"	20' 3"	17' 0"
1000S300-118	50	23' 3"	21' 2"	18' 6"	26' 2"	23' 9"	19' 4"	21' 2"	19' 3"	16' 9"	23' 9"	21' 7"	18' 10"
1000S350-54	50	17' 4"e	15' 1"e	11' 0"e	14' 4"	11' 6"e	8' 2"e	17' 0"e	15' 1"e	11' 0"e	14' 4"	11' 6"e	8' 2"e
1000S350-68	50	20' 6"e	17' 9"e	14' 7"e	20' 7"	17' 3"e	13' 2"e	18' 7"e	16' 10"e	14' 7"e	20' 7"	17' 3"e	13' 2"e
1000S350-97	50	23' 1"	21' 0"	18' 3"e	25' 10"	22' 10"	18' 7"	21' 0"	19' 1"	16' 7"e	23' 6"	21' 4"	18' 7"
1000S350-118	50	24' 6"	22' 3"	19' 6"	27' 6"	25' 0"	21' 3"	22' 3"	20' 2"	17' 8"	25' 0"	22' 8"	19' 10"

BAILEY MAXIMUM FLOOR JOIST SPANS (ft)

Joist Member	F _y (ksi)	35 psf Dead Load 100 psf Live Load											
		TL Deflection = L/240, LL Deflection = L/360						TL Deflection = L/240, LL Deflection = L/480					
		SINGLE SPAN			TWO EQUAL SPANS			SINGLE SPAN			TWO EQUAL SPANS		
		Joist Spacing (in.) o.c.			Joist Spacing (in.) o.c.			Joist Spacing (in.) o.c.			Joist Spacing (in.) o.c.		
		12	16	24	12	16	24	12	16	24	12	16	24
1200S162-43	33	9' 2"e	6' 10"e	4' 7"e	7' 0"e	5' 3"e	3' 7"e	9' 2"e	6' 10"e	4' 7"e	7' 0"e	5' 3"e	3' 7"e
1200S162-54	50	15' 3"e	13' 2"e	9' 1"e	12' 4"e	9' 9"e	6' 10"e	15' 3"e	13' 2"e	9' 1"e	12' 4"e	9' 9"e	6' 10"e
1200S162-68	50	18' 1"e	15' 8"e	12' 9"e	18' 0"	15' 0"	11' 4"e	18' 1"e	15' 8"e	12' 9"e	18' 0"	15' 0"	11' 4"e
1200S162-97	50	22' 8"	20' 3"	16' 6"e	23' 4"	20' 3"	16' 6"	20' 7"	18' 8"	16' 3"e	23' 1"	20' 3"	16' 6"
1200S162-118	50	24' 1"	21' 10"	19' 0"	26' 10"	23' 3"	19' 0"	21' 10"	19' 10"	17' 4"	24' 7"	22' 4"	19' 0"
1200S200-54	50	16' 7"e	13' 7"e	9' 1"e	12' 7"e	10' 0"e	6' 10"e	16' 7"e	13' 7"e	9' 1"e	12' 7"e	10' 0"e	6' 10"e
1200S200-68	50	19' 7"e	16' 10"e	13' 9"e	18' 9"	15' 7"	11' 8"e	18' 10"e	16' 10"e	13' 9"e	18' 9"	15' 7"	11' 8"e
1200S200-97	50	23' 7"	21' 4"	17' 9"e	25' 1"	21' 9"	17' 9"	21' 4"	19' 6"	17' 0"e	24' 1"	21' 9"	17' 9"
1200S200-118	50	25' 1"	22' 9"	20' 0"	28' 2"	24' 10"	20' 4"	22' 9"	20' 9"	18' 1"	25' 7"	23' 3"	20' 3"
1200S250-54	50	17' 1"e	13' 7"e	9' 1"e	12' 8"e	10' 0"e	7' 0"e	17' 1"e	13' 7"e	9' 1"e	12' 8"e	10' 0"e	7' 0"e
1200S250-68	50	20' 2"e	17' 6"e	14' 3"e	18' 10"	15' 8"	11' 9"e	19' 7"e	17' 6"e	14' 3"e	18' 10"	15' 8"	11' 9"e
1200S250-97	50	24' 6"	22' 3"	18' 4"e	26' 0"	22' 6"	18' 4"	22' 3"	20' 2"	17' 8"e	25' 0"	22' 6"	18' 4"
1200S250-118	50	26' 1"	23' 8"	20' 8"	29' 3"	25' 9"	21' 1"	23' 8"	21' 7"	18' 9"	26' 7"	24' 2"	21' 1"
1200S300-54	50	17' 3"e	13' 7"e	9' 1"e	12' 10"e	10' 1"e	7' 0"e	17' 3"e	13' 7"e	9' 1"e	12' 10"e	10' 1"e	7' 0"e
1200S300-68	50	20' 7"e	17' 9"e	14' 7"e	19' 7"	16' 2"	12' 1"e	20' 4"e	17' 9"e	14' 7"e	19' 7"	16' 2"	12' 1"e
1200S300-97	50	25' 3"	23' 0"	18' 9"e	26' 6"	23' 0"	18' 9"	23' 0"	20' 10"	18' 2"e	25' 9"	23' 0"	18' 9"
1200S300-118	50	27' 0"	24' 6"	21' 4"	30' 3"	26' 4"	21' 7"	24' 6"	22' 3"	19' 6"	27' 7"	25' 0"	21' 7"
1200S350-54	50	18' 2"e	13' 7"e	9' 1"e	13' 3"e	10' 3"e	7' 1"e	18' 2"e	13' 7"e	9' 1"e	13' 3"e	10' 3"e	7' 1"e
1200S350-68	50	22' 4"e	19' 4"e	15' 10"e	21' 0"	17' 2"e	12' 7"e	21' 6"e	19' 4"e	15' 10"e	21' 0"	17' 2"e	12' 7"e
1200S350-97	50	26' 7"	24' 2"e	20' 6"e	29' 1"	25' 2"	20' 6"	24' 2"	22' 0"	19' 2"e	27' 2"	24' 8"	20' 6"
1200S350-118	50	28' 3"	25' 8"	22' 6"	31' 9"	28' 10"	23' 7"	25' 8"	23' 4"	20' 4"	28' 10"	26' 2"	22' 10"
1400S162-54	50	15' 6"e	11' 8"e	7' 9"e	11' 6"e	8' 10"e	6' 1"e	15' 6"e	11' 8"e	7' 9"e	11' 6"e	8' 10"e	6' 1"e
1400S162-68	50	19' 2"e	16' 8"e	13' 7"e	18' 2"	14' 10"	10' 10"e	19' 2"e	16' 8"e	13' 7"e	18' 2"	14' 10"	10' 10"e
1400S162-97	50	25' 1"	21' 8"	17' 8"e	25' 1"	21' 8"	17' 8"	23' 3"	21' 2"	17' 8"e	25' 1"	21' 8"	17' 8"
1400S162-118	50	27' 6"	25' 0"	20' 6"	29' 0"	25' 1"	20' 6"	25' 0"	22' 8"	19' 9"	28' 0"	25' 1"	20' 6"
1400S200-54	50	15' 6"e	11' 8"e	7' 9"e	11' 7"e	8' 10"e	6' 1"e	15' 6"e	11' 8"e	7' 9"e	11' 7"e	8' 10"e	6' 1"e
1400S200-68	50	20' 10"e	18' 1"e	14' 9"e	18' 10"	15' 3"	11' 1"e	20' 10"e	18' 1"e	14' 9"e	18' 10"	15' 3"	11' 1"e
1400S200-97	50	26' 8"	23' 4"e	19' 1"e	27' 1"	23' 4"	19' 1"	24' 2"	22' 0"	19' 1"e	27' 1"	23' 4"	19' 1"
1400S200-118	50	28' 7"	25' 10"	22' 1"	31' 2"	27' 0"	22' 1"	25' 10"	23' 7"	20' 7"	29' 1"	26' 6"	22' 1"
1400S250-54	50	15' 6"e	11' 8"e	7' 9"e	11' 8"e	9' 0"e	6' 1"e	15' 6"e	11' 8"e	7' 9"e	11' 8"e	9' 0"e	6' 1"e
1400S250-68	50	21' 8"e	18' 9"e	15' 3"e	18' 10"	15' 4"	11' 1"e	21' 8"e	18' 9"e	15' 3"e	18' 10"	15' 4"	11' 1"e
1400S250-97	50	27' 7"	24' 3"e	19' 10"e	28' 1"	24' 3"	19' 9"	25' 1"	22' 9"	19' 10"e	28' 1"	24' 3"	19' 9"
1400S250-118	50	29' 7"	26' 10"	22' 10"e	32' 4"	28' 11"	22' 10"	26' 10"	24' 4"	21' 3"	30' 2"	27' 4"	22' 10"
1400S300-54	50	15' 6"e	11' 8"e	7' 9"e	11' 8"e	9' 0"e	6' 1"e	15' 6"e	11' 8"e	7' 9"e	11' 8"e	9' 0"e	6' 1"e
1400S300-68	50	22' 1"e	19' 2"e	15' 7"e	19' 1"	15' 6"	11' 2"e	22' 1"e	19' 2"e	15' 7"e	19' 1"	15' 6"	11' 2"e
1400S300-97	50	28' 4"	24' 10"e	20' 3"e	28' 9"	24' 10"	20' 3"	25' 9"	23' 4"e	20' 3"e	28' 9"	24' 10"	20' 3"
1400S300-118	50	30' 7"	27' 9"	23' 6"e	33' 2"	28' 9"	23' 6"	27' 9"	25' 2"	22' 0"	31' 2"	28' 3"	23' 6"
1400S350-54	50	15' 6"e	11' 8"e	7' 9"e	11' 10"e	9' 1"e	6' 1"e	15' 6"e	11' 8"e	7' 9"e	11' 10"e	9' 1"e	6' 1"e
1400S350-68	50	23' 10"e	20' 8"e	15' 7"e	20' 6"	16' 4"e	11' 7"e	23' 10"e	20' 8"e	15' 7"e	20' 6"	16' 4"e	11' 7"e
1400S350-97	50	30' 1"	27' 1"e	22' 1"e	31' 3"	27' 1"	22' 1"e	27' 4"	24' 10"e	21' 8"e	30' 8"	27' 1"	22' 1"e
1400S350-118	50	32' 0"	29' 1"	25' 4"e	36' 0"	31' 4"	25' 7"	29' 1"	26' 4"	23' 1"e	32' 8"	29' 8"	25' 7"
1600S162-68	50	20' 2"e	17' 6"e	13' 7"e	17' 10"e	14' 3"e	10' 1"e	20' 2"e	17' 6"e	13' 7"e	17' 10"e	14' 3"e	10' 1"e
1600S162-97	50	26' 6"	22' 10"e	18' 8"e	26' 6"	22' 10"	18' 8"	25' 10"	22' 10"e	18' 8"e	26' 6"	22' 10"	18' 8"
1600S162-118	50	30' 8"	26' 7"	21' 9"	30' 9"	26' 7"	21' 9"	27' 10"	25' 3"	21' 9"	30' 9"	26' 7"	21' 9"
1600S200-68	50	22' 0"e	19' 0"e	13' 7"e	18' 4"e	14' 7"e	10' 3"e	22' 0"e	19' 0"e	13' 7"e	18' 4"e	14' 7"e	10' 3"e
1600S200-97	50	28' 8"	24' 9"e	20' 3"e	28' 8"	24' 9"	19' 10"	26' 10"	24' 6"e	20' 3"e	28' 8"	24' 9"	19' 10"
1600S200-118	50	31' 9"	28' 9"	23' 6"e	33' 2"	28' 9"	23' 6"	28' 10"	26' 3"	22' 10"e	32' 4"	28' 9"	23' 6"
1600S250-68	50	22' 10"e	19' 10"e	13' 7"e	18' 4"e	14' 7"e	10' 3"e	22' 10"e	19' 10"e	13' 7"e	18' 4"e	14' 7"e	10' 3"e
1600S250-97	50	29' 10"	25' 10"e	21' 1"e	29' 10"	25' 10"	20' 4"e	27' 10"	25' 3"e	21' 1"e	29' 10"	25' 10"	20' 4"e
1600S250-118	50	32' 10"	29' 10"	24' 6"e	34' 7"	30' 0"	24' 6"	29' 10"	27' 2"	23' 8"e	33' 7"	30' 0"	24' 6"
1600S300-68	50	23' 4"e	20' 2"e	13' 7"e	18' 6"e	14' 8"e	10' 3"e	23' 4"e	20' 2"e	13' 7"e	18' 6"e	14' 8"e	10' 3"e
1600S300-97	50	30' 8"e	26' 7"e	21' 8"e	30' 8"	26' 7"	20' 9"e	28' 7"	25' 10"e	21' 8"e	30' 8"	26' 7"	20' 9"e
1600S300-118	50	33' 10"	30' 9"	25' 2"e	35' 7"	30' 9"	25' 2"	30' 9"	28' 0"	24' 6"e	34' 7"	30' 9"	25' 2"
1600S350-68	50	25' 1"e	20' 4"e	13' 7"e	19' 3"e	15' 1"e	10' 6"e	25' 1"e	20' 4"e	13' 7"e	19' 3"e	15' 1"e	10' 6"e
1600S350-97	50	33' 1"e	28' 9"e	23' 6"e	33' 2"	28' 1"	21' 9"e	30' 1"	27' 3"e	23' 6"e	33' 2"	28' 1"	21' 9"e
1600S350-118	50	35' 6"	32' 2"	27' 4"e	38' 8"	33' 6"	27' 4"	32' 2"	29' 3"	25' 7"e	36' 2"	32' 10"	27' 4"

GENERAL NOTES:

- Spans are based on continuous lateral support of the compression flange over the full joist length.
- Tension flange must be laterally braced at a maximum spacing of 8'-0".
- Joists must be braced against rotation at all supports.
- Distortional buckling calculations are based on $K\phi = 0$.
- For two equal spans, the listed span is the distance from either end to the continuous centre support.
- End web crippling check is based on 3.5" end bearing. Where listed spans are followed by "e", web stiffeners are required at end supports.
- Web stiffeners are required at interior supports.
- Total load (TL) deflection is based on L/240 and live load (LL) deflection is based on either L/360 or L/480.



BAILEY[®]
METAL PRODUCTS LIMITED



BAILEY C-JOIST SPAN TABLES AND DETAILS

sales@bmp-group.com • www.bmp-group.com



JF07IN19-1000

MONTREAL

525 Avenue Edward VII
Dorval, QC H9P 1E7
Tel. (514) 735-3455
800-263-3455
Fax. (514) 735-5052

TORONTO

1 Caldari Road
Concord, ON L4K 3Z9
Tel. (905) 738-9267
800-668-2154
Fax. (905) 738-5712

CALGARY

3924 27th Street NE
Calgary, AB T1Y 5K7
Tel. (403) 248-3536
800-665-2013
Fax. (403) 248-0288

EDMONTON

5710 Roper Road NW
Edmonton, AB T6B 3G7
Tel. (780) 462-5757
800-563-1751
Fax. (780) 450-3378

VANCOUVER

3635 190th Street,
Surrey, BC V3Z 0P6
Tel. (604) 590-5100
800-818-2666
Fax. (604) 599-5371