



ASSOCIATED GROUP
OF COMPANIES

Lightweight Steel Framing Details

Joists for Floors & Roofs

Bailey Joists for Floors and Roofs

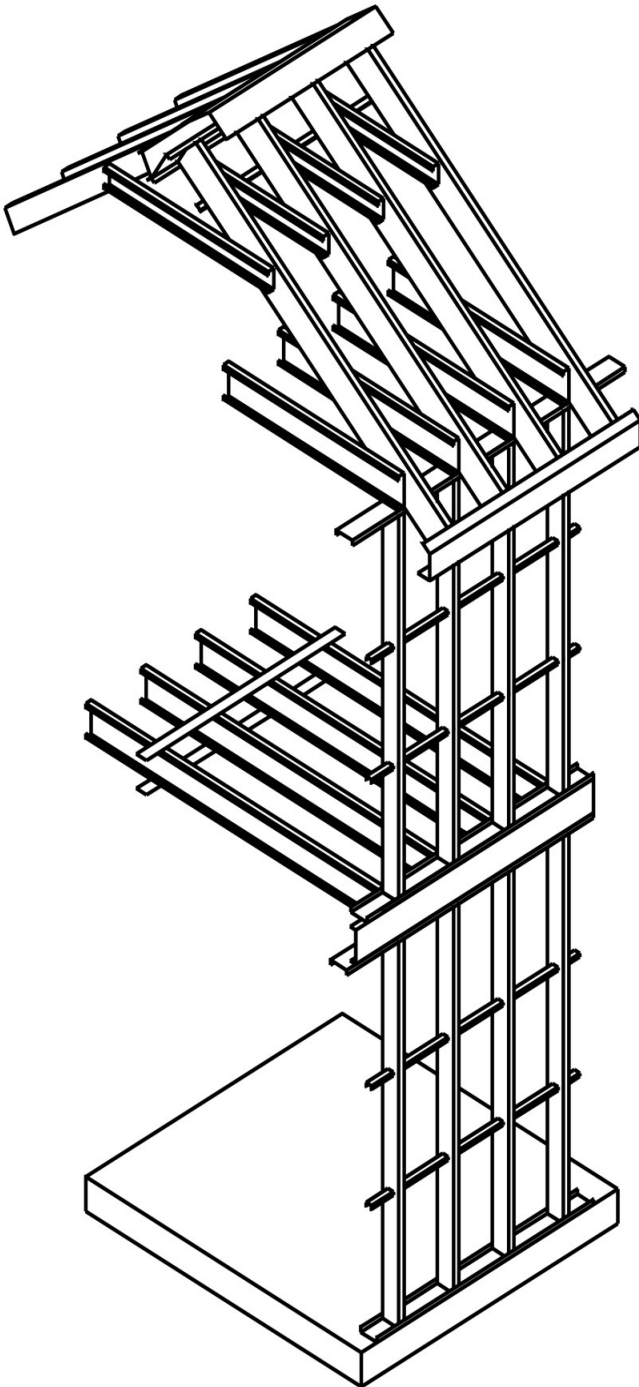

Bailey Lightweight Steel Framing (LSF) Joists offer a wide range of span and load capabilities for commercial and residential floor systems and mezzanines. LSF ceiling Joist and Rafter members can also be utilized for pitched, mansard and flat roofs. The use of Bailey LSF Joist and Rafter members will provide support for interior drywall ceilings where long clear spans are required.

Bailey Lightweight Steel Framing Details

Floor Joists

Floor Joist with Bridging and Blocking

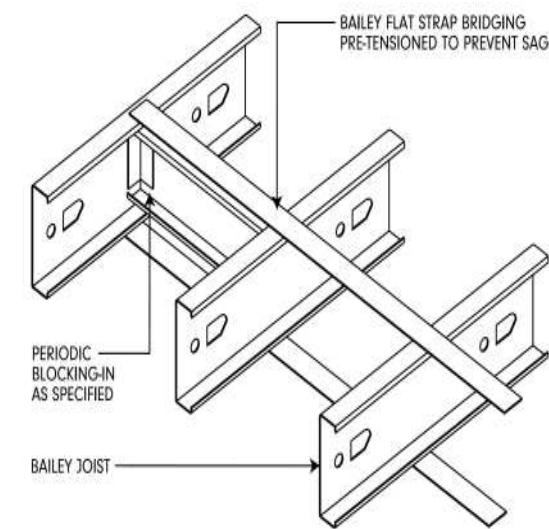

Floor Mounted Inside Concrete Wall

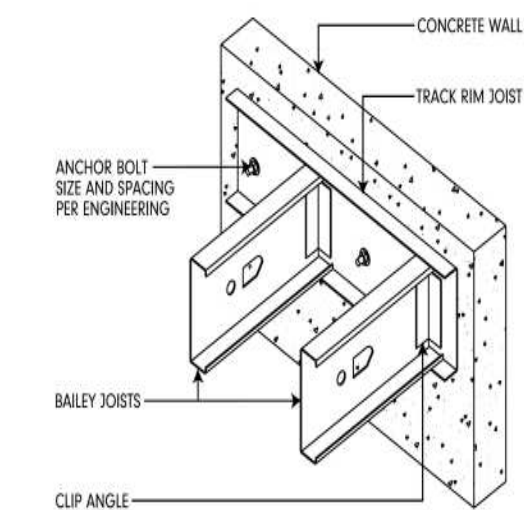

Opening in Floor

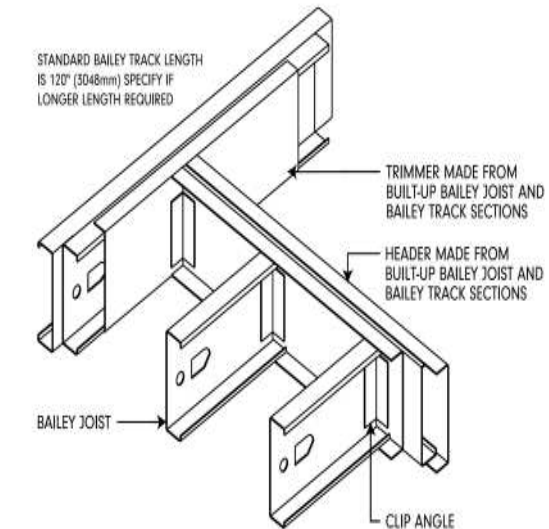

Flush Connection to Supporting Beam

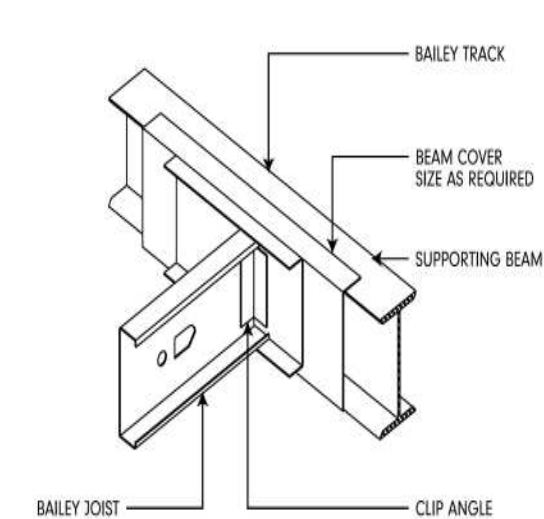

Joists Continuous Over Supporting Beam

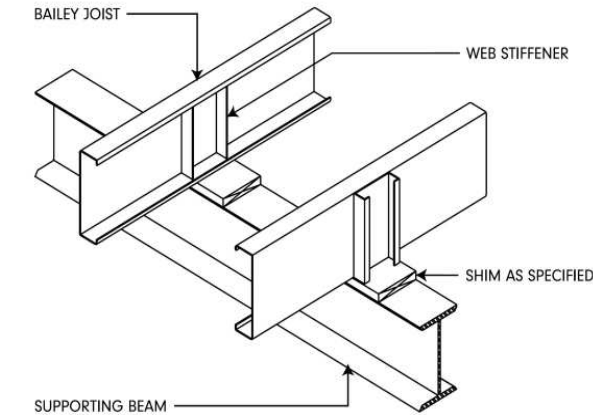

Joists Overlapping Supporting Beam

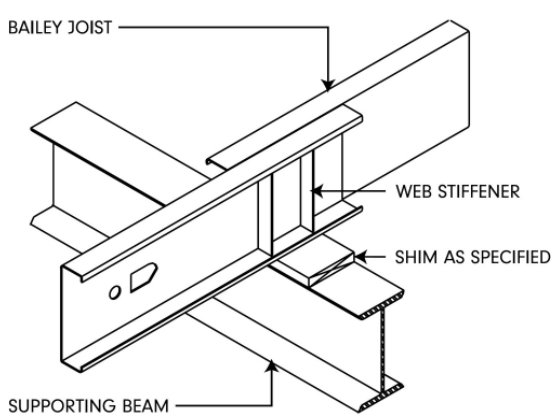

Bailey Lightweight Steel Framing Details

Floor Joists

Joist Perpendicular to Perimeter

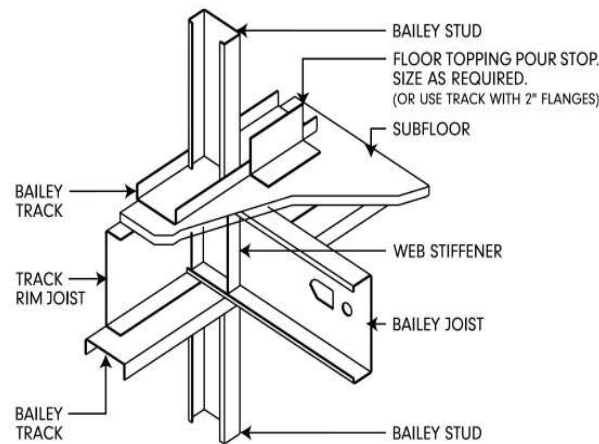

Joist above Loadbearing Wall

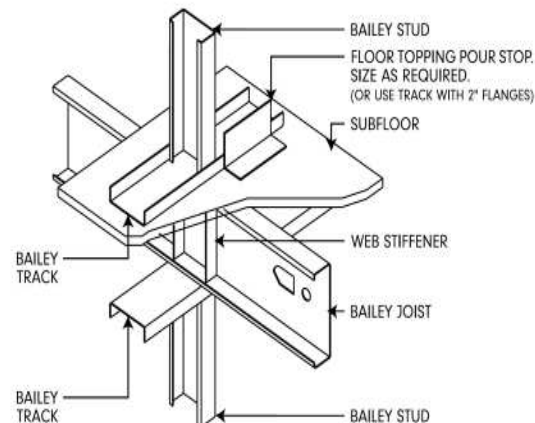

Joist Parallel to Perimeter

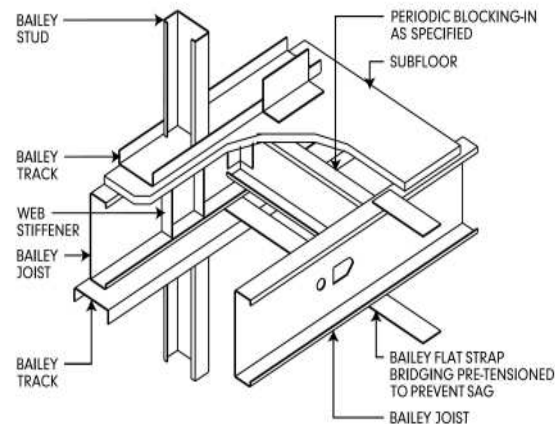

Joist Perpendicular to Perimeter

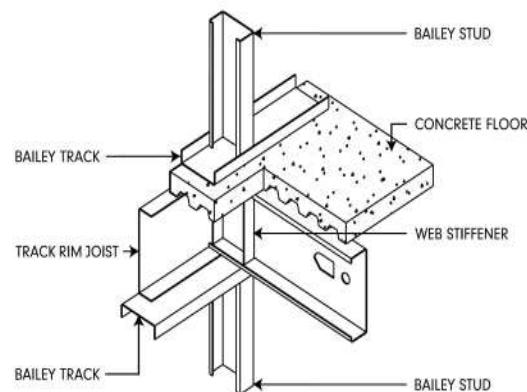

Joist above Loadbearing Wall

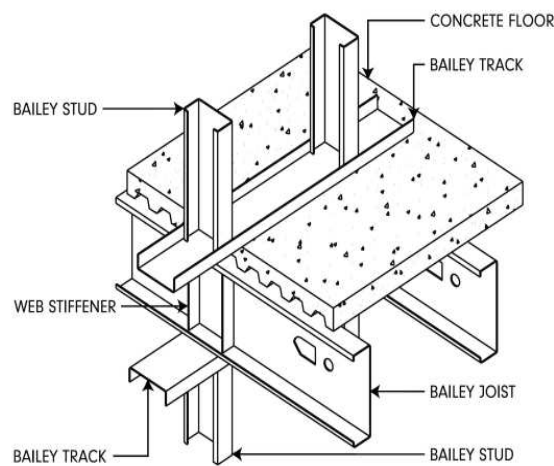

Joist Parallel to Perimeter

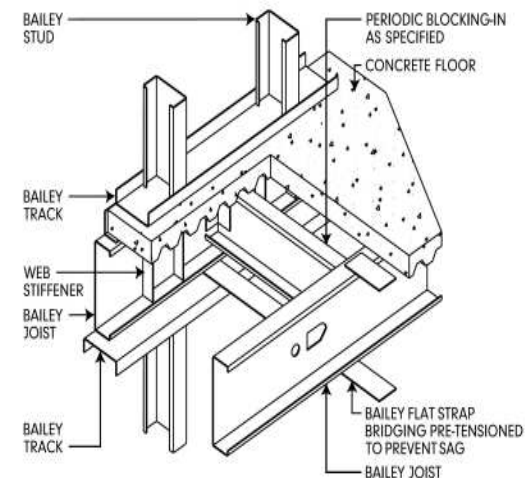

Bailey Lightweight Steel Framing Details

Roof Joists

Rafter at Peak

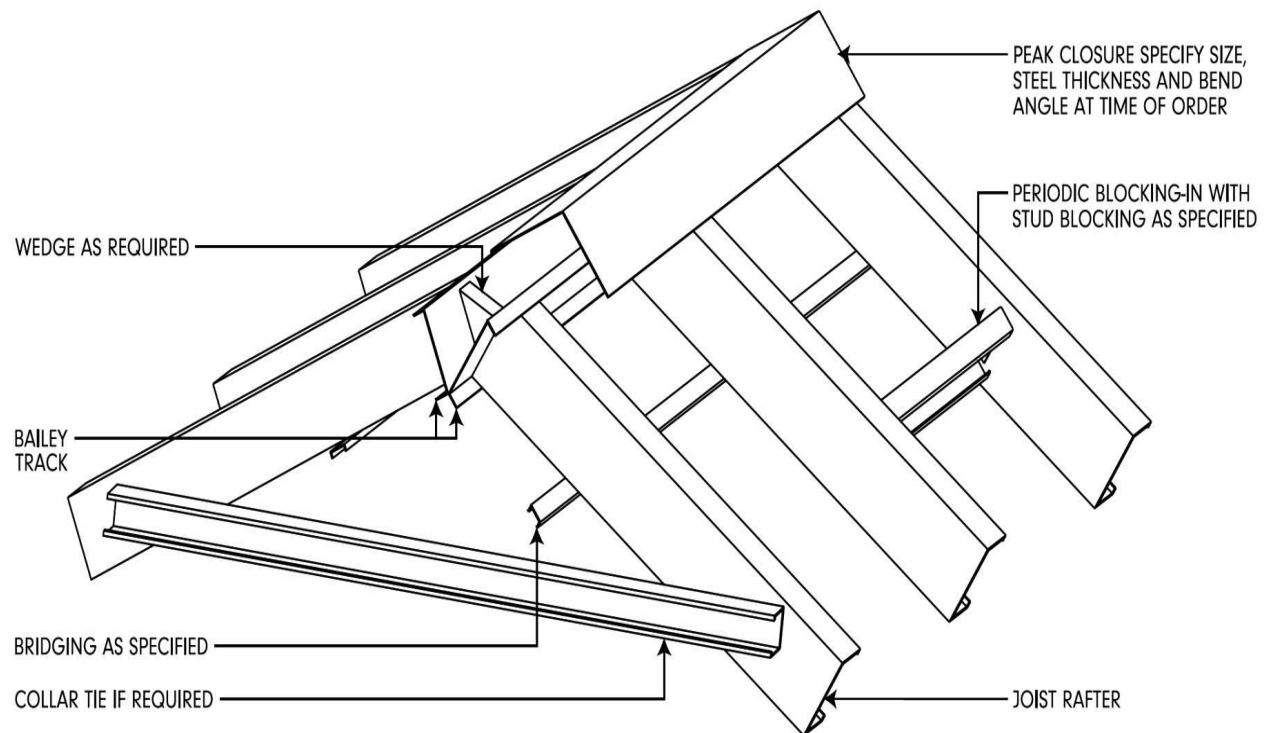

Rafter at Perimeter Wall

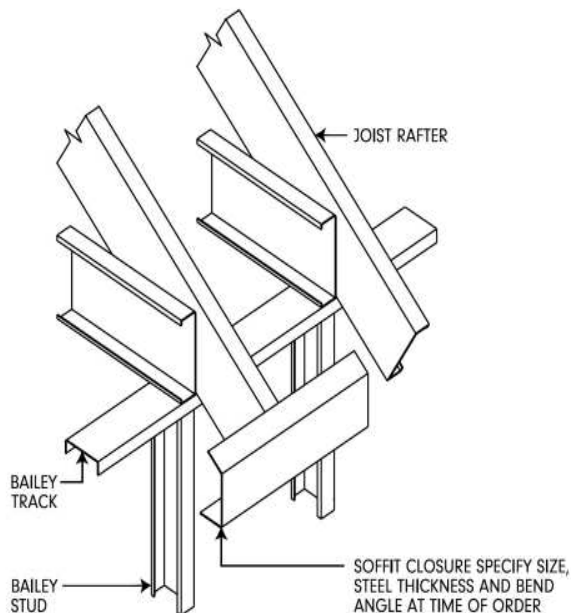

Rafter at Perimeter Wall

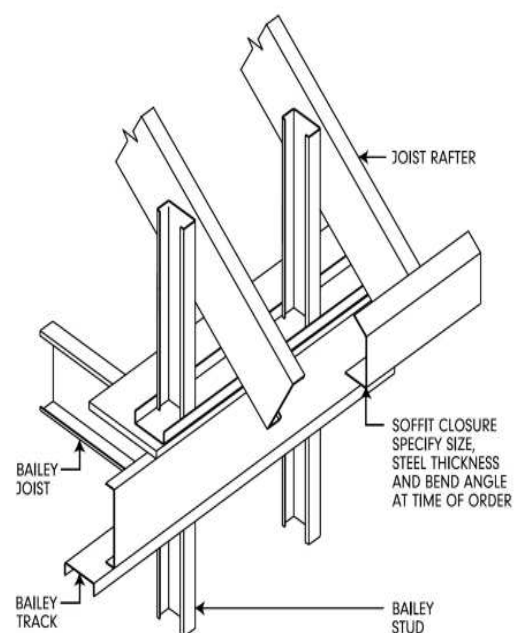

The material presented in this document has been prepared for the general information of the reader. While the material is believed to be technically correct and in accordance with recognized good practice, it should not be used without first securing competent advice with respect to its suitability for any specific application. Bailey Metal Products Limited does not warrant or assume liability for the suitability of the material for any general or particular use.